

Jaguar E-Type aluminum rear wheel upright.

Drill 1/2"

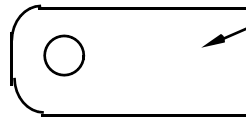

1/8" x 1 1/2" flat bar 3 1/2" long, weld to sides of jag cup base as removed from jaguar rubber radius arm.

Jaguar steel "Cup piece"

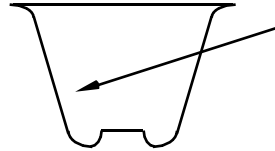

After removing Jaguar radius arm cut rubber off of front floor cup piece, sand clean and weld to flat bar shown above.

New fabricated radius arm assembly.

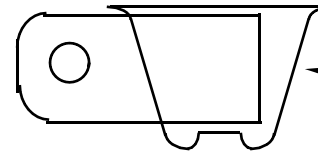

Finished assembly should look like this.

use original radius bar connection mounting bolt

New fabricated front radius arm assembly

Jag Floor

Existing Jaguar strap retainer

Fabricate Sway-bar connection using two 1/8" plates welded to new radius tube. drill 1/2" Eye should be 1 3/4" ahead of existing radius arm connection and 1 3/4" higher.

1" dia. poly bar end, clamped between fabricated bracket

Weld threaded ends into 1" metal tube, to match threads of 3/4" hemi & bar-ends

Costello Productions

XKE E-Type Positive Axle Radius Arms.

NTS.

All disclaimers

Adjust length of bar with rideheight set at mid point.