

TECHNICAL BULLETIN

JTB00502

15 JUN 2016



© Jaguar Land Rover Limited
All rights reserved.

SECTION: 501-00

Vertical Scratches On Door Windows

AFFECTED VEHICLE RANGE:

F-TYPE (X152)

Model Year: 2014 Onwards
VIN: K00001 Onwards
Assembly Plant: Castle Bromwich

MARKETS:

All

CONDITION SUMMARY:

Situation: A customer may express a concern that there are vertical scratches on the door windows.

Cause: Seal design allowing grit to get trapped between glass and seal. **Suggested Customer Concern Code AM3.**

Action: Should a customer express this concern, follow the Service Instruction below.

PARTS:

T2R 24144	Waist Seal Left Side	1
T2R 24143	Waist Seal Right Side	1

WARRANTY:

NOTE: Repair procedures are under constant review, and therefore times are subject to change; those quoted here must be taken as guidance only. Always refer to TOPIx to obtain the latest repair time.

NOTE: DDW requires the use of causal part numbers. Labor only claims must show the causal part number with a quantity of zero.

DESCRIPTION	SRO	TIME (HOURS)	CONDITION CODE	CAUSAL PART
Front Door Outer Waist Seal - Renew	76.31.53	0,1	70	T2R1672

NOTE: Normal Warranty procedures apply.

SERVICE INSTRUCTION:

NOTE: Any consequential scratching of the glass should be assessed by the technician. If the scratches in the door window glass can be felt by sliding a suitable plastic tool across the surface, replace the door window glass. If the scratches in the door window glass can not be felt by sliding a suitable plastic tool across the surface of the door window glass, polish the glass using a suitable polishing compound and cloth.

NOTE: Any door window glass replacement must be claimed in a separate Warranty Claim.

1. Open the door.
2. Remove the outer waist seal fastener.



E192604

3. Remove the outer waist finisher.

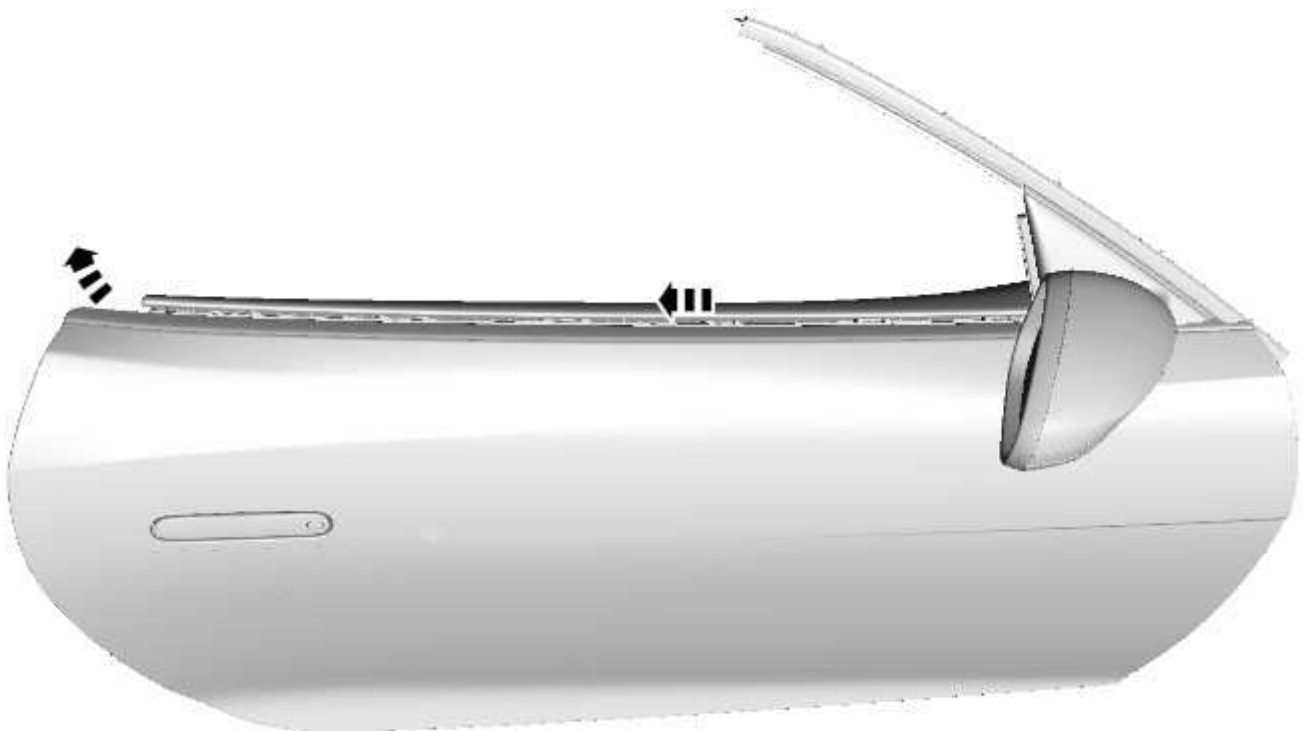

E192605

4. Remove the seal from the outer waist finisher.

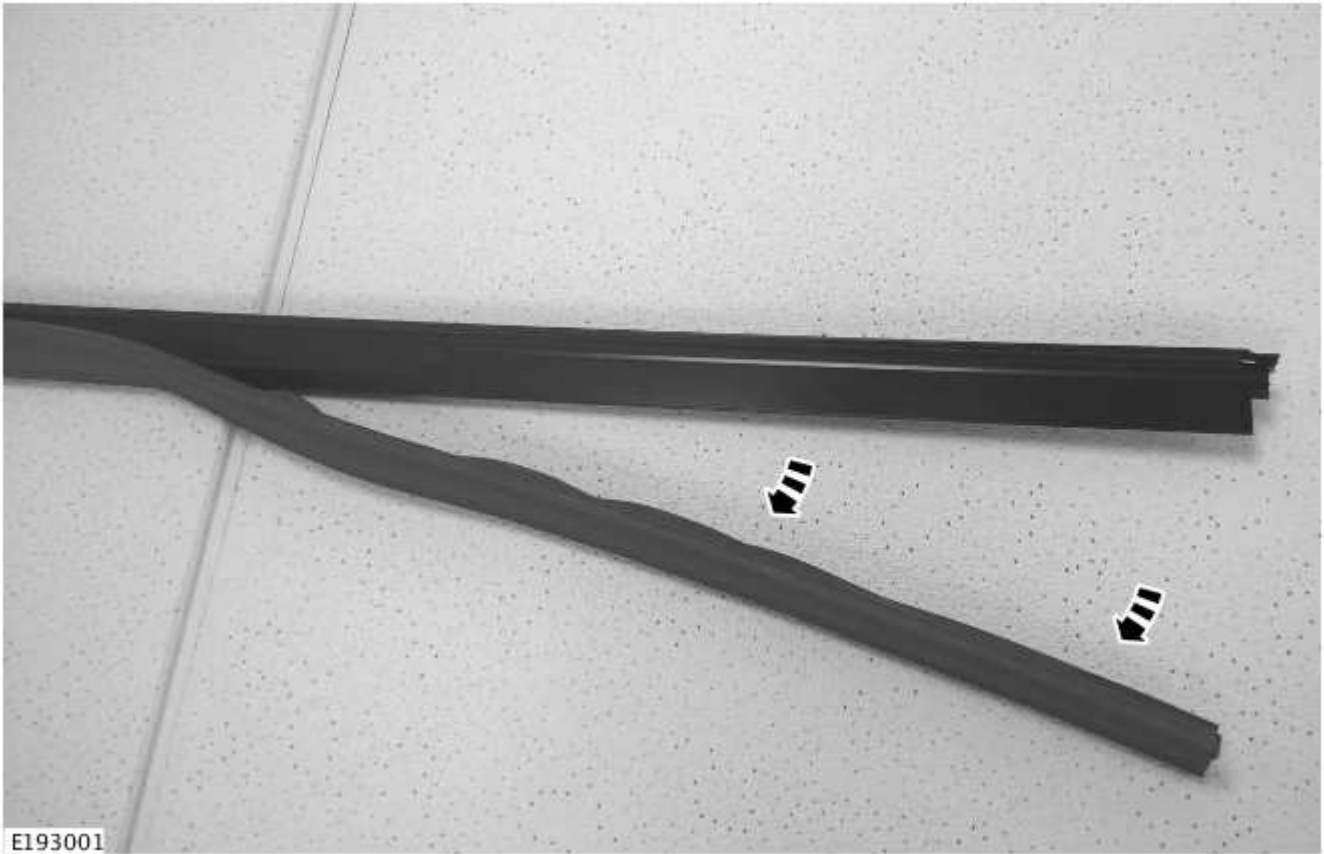

5. If installed, remove and discard the adhesive foam strip from the outer waist finisher.

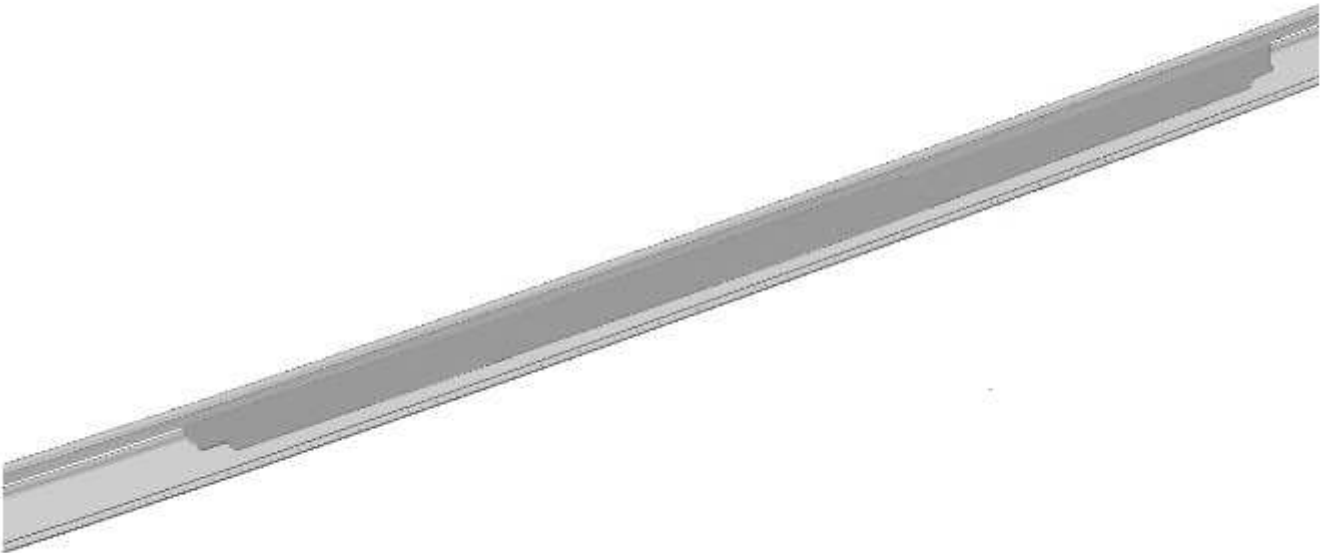

E192989

6.  **NOTE: Make sure the seal is installed evenly along the outer waist finisher.**

Install the new seal to the outer waist finisher.

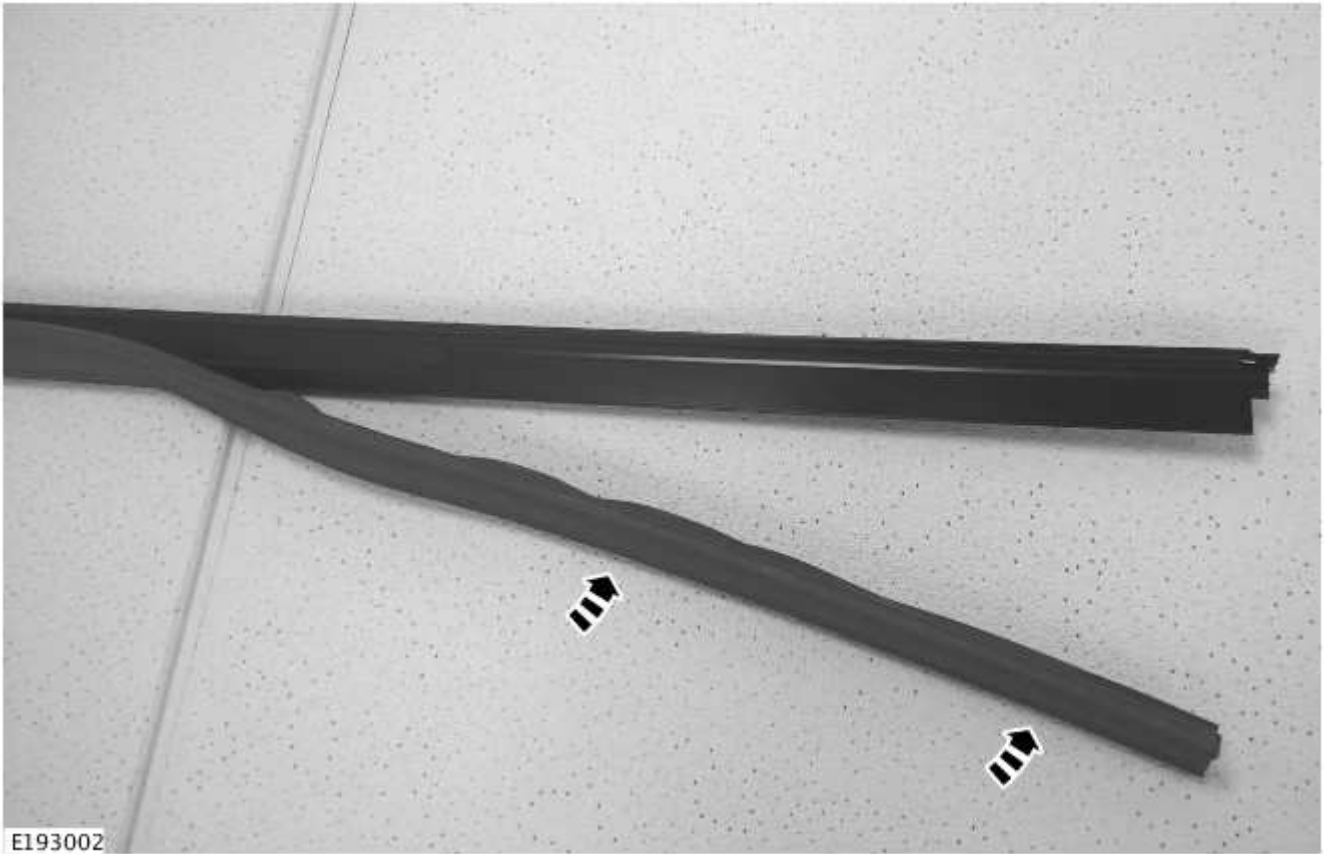

7.  **NOTE: Take care not to damage the outer waist finisher and seal during installation.**
Install the outer waist finisher.

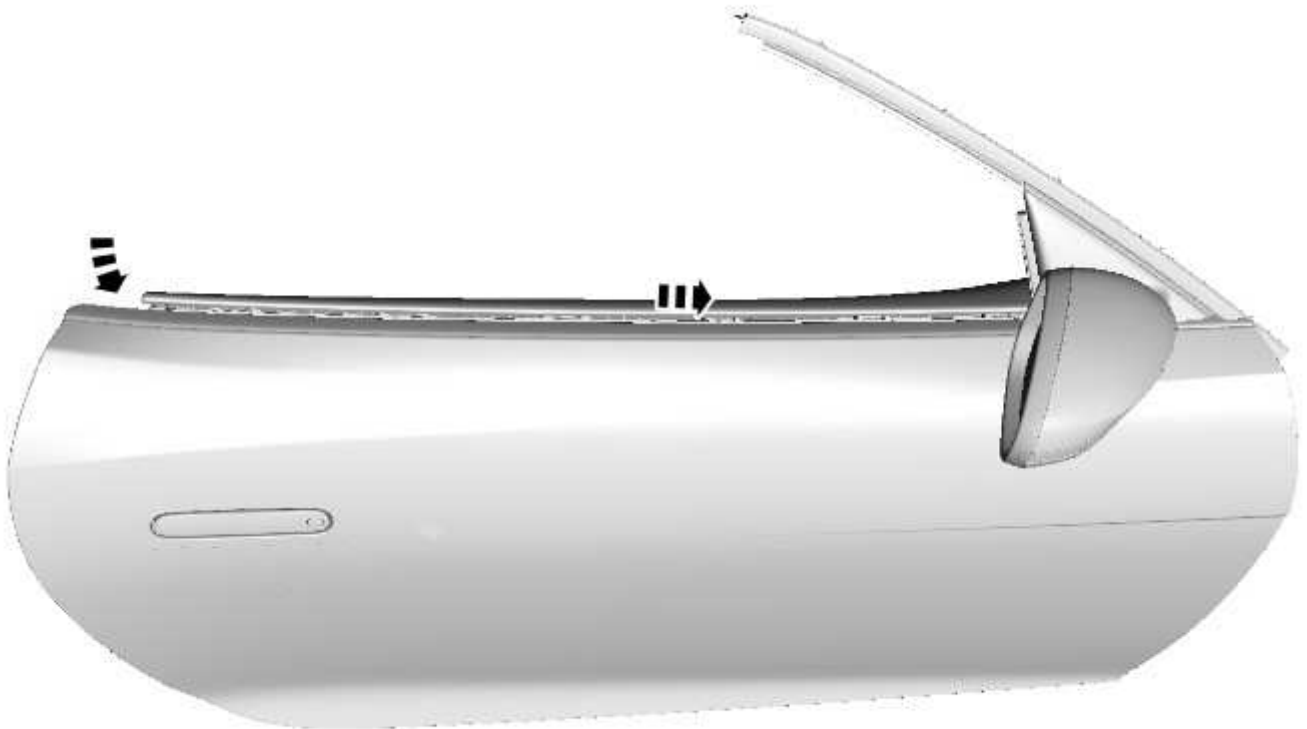

E192606

8. Install the outer waist seal fastener.



E192604

9. Close the door.