



BY APPOINTMENT TO
HER MAJESTY QUEEN ELIZABETH II
MANUFACTURERS OF DABLER AND JAGUAR CARS
JAGUAR CARS LIMITED COVENTRY



BY APPOINTMENT TO
HER MAJESTY QUEEN ELIZABETH
THE QUEEN MOTHER
MANUFACTURERS OF DABLER AND JAGUAR CARS
JAGUAR CARS LIMITED COVENTRY



BY APPOINTMENT TO
HIS ROYAL HIGHNESS THE PRINCE OF WALES
MANUFACTURERS OF DABLER AND JAGUAR CARS
JAGUAR CARS LIMITED COVENTRY

AUDIO SYSTEMS AND JAGUARVOICE

Publication Part No. **JJM 18 08 26 501**

Published May 2004 by Technical Communications **Jaguar Cars Limited**

JAGUAR CARS LIMITED, as manufacturer, is dedicated to the design and production of vehicles which meet the expectations of the world's most discerning purchasers.

This handbook forms part of the owner literature supplied with your vehicle. It is designed to complement the relevant features and systems of the vehicle, and make them easy to understand and operate.

The information contained in this handbook applies to a range of vehicles and not to a specific vehicle. For the specification of a particular vehicle, owners should consult their Jaguar Retailer.

The manufacturer reserves the right to vary its specifications with or without notice, and at such times and in such manner as it thinks fit. Major as well as minor changes may be involved in accordance with the Manufacturer's policy of constant product improvement.

To cover changes, it is sometimes necessary to issue one or more handbook supplements. When reading this handbook, check the owner literature for possible supplements.

For full details of the owner literature originally supplied with the vehicle, owners should consult their Jaguar Retailer.

All rights reserved. No part of this publication may be reproduced, stored in a retrieval system or transmitted, in any form, electronic, mechanical, photocopying, recording or other means without prior written permission from the Service Division of Jaguar Cars Limited.



This book is printed on paper that originates from sustainable forests, is recyclable, bio-degradable and acid-free. The wood pulp is chlorine-free and the effluent water is purified before being discharged.

Handbook Contents

Quick Overview

Quick Overview 5

Audio System

Introduction 13

Radio Operation 14

Cassette Tape Player 22

Single CD Player 23

MiniDisc Player 24

User Operating Preferences 25

Compact Disc Changer 26

Audio System Care 29

JaguarVoice

JaguarVoice 31

L



JAGUAR

Quick Overview

Cassette Tape Controls

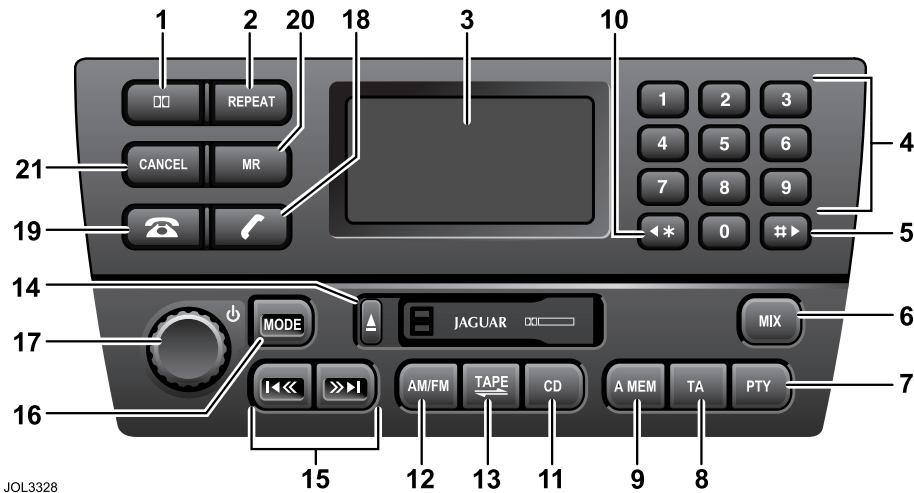

JOL3328

1. Dolby B noise reduction
2. **REPEAT**. Repeat current track of CD or repeat CD.
3. Audio system display
4. Station preset buttons (1 to 9) and phone key pad.
5. Seek a stored number in the phone memory.
6. **Mix**. Mix CDs or CD tracks.
7. **PTY**. Priority programme type (where broadcast).
8. **TA**. Radio Broadcast Data System (RBDS).
9. **A MEM**. Automatically set station presets.
10. Seek a stored number in the phone memory.
11. **CD**. Select CD changer.
12. **AM/FM**. Radio waveband select.
13. **TAPE**. Select a cassette tape play when in other audio mode, or tape side change (when a tape is inserted and playing).
14. Eject cassette tape.
15. Seek AM/FM station, seek tape or cue/review CD.
16. **MODE**. Scroll to select sound settings, voice activation and clock control (not the clock on The XJ).
17. ON/OFF, volume control and automatic volume control (AVC).
18. Send/end telephone call.
19. Enter phone mode.
20. **MR**. Memory recall - Phone memory access.
21. **CANCEL**. Remove digits (phone).

Quick Overview

Compact Disc (CD) Controls

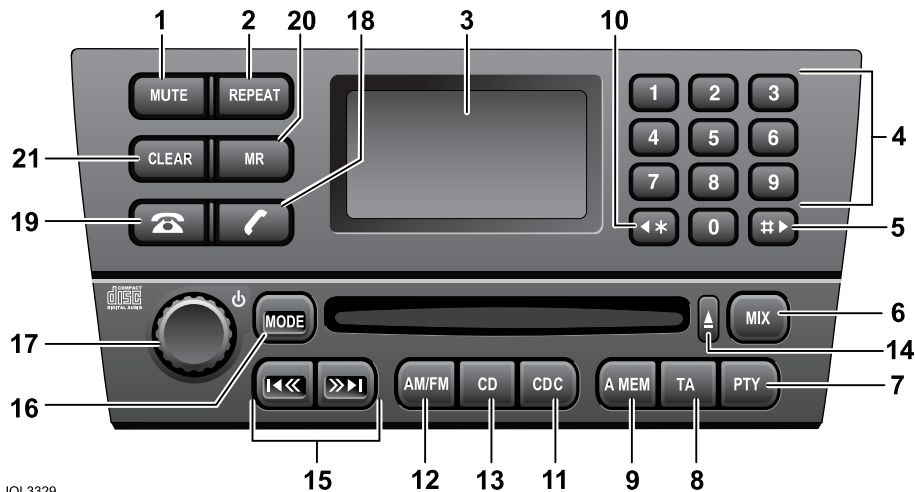

JOL3329

- 1. MUTE.** Mutes audio.
- 2. REPEAT.** Repeat current track of CD or repeat CD.
- 3.** Audio system display
- 4.** Station preset buttons (1 to 9) and phone key pad.
- 5.** Seek a stored number in the phone memory.
- 6. Mix.** Mix CDs or CD tracks.
- 7. PTY.** Priority programme type (where broadcast).
- 8. TA.** Radio Broadcast Data System (RBDS).
- 9. A MEM.** Automatically set station presets.
- 10.** Seek a stored number in the phone memory.
- 11. CDC.** Select CD changer.
- 12. AM/FM.** Radio waveband select.
- 13. CD.** Select compact disc play when in other audio mode, or CD pause (when a CD is inserted and playing).
- 14.** Eject CD.
- 15.** Seek AM/FM station, cue/review CD.
- 16. MODE.** Scroll to select sound settings, voice activation and clock control (not the clock on The XJ).
- 17.** ON/OFF, volume control and automatic volume control (AVC).
- 18.** Send/end telephone call.
- 19.** Enter phone mode.
- 20. MR.** Memory recall - Phone memory access.
- 21. CLEAR.** Remove digits (phone).

Quick Overview

MiniDisc (MD) Controls

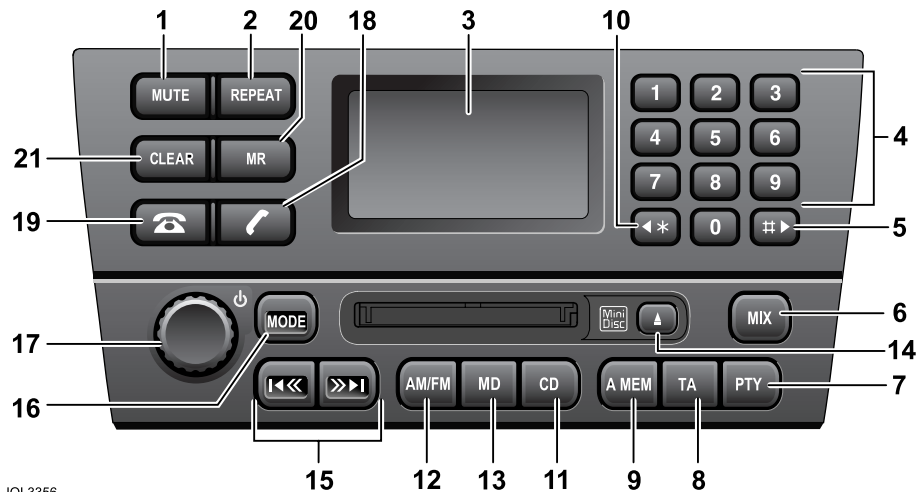

JOL3356

1. **MUTE.** Mutes audio.
2. **REPEAT.** Repeat current track of MD or repeat MD.
3. Audio system display
4. Station preset buttons (1 to 9) and phone key pad.
5. Seek a stored number in the phone memory.
6. **Mix.** Mix CDs or MD tracks.
7. **PTY.** Priority programme type (where broadcast).
8. **TA.** Radio Broadcast Data System (RBDS).
9. **A MEM.** Automatically set station presets.
10. Seek a stored number in the phone memory.
11. **CD.** Select CD changer.
12. **AM/FM.** Radio waveband select.
13. **MD.** Select MiniDisc play when in other audio mode, or MD pause (when a MiniDisc is inserted and playing).
14. Eject MD.
15. Seek AM/FM station, cue/review MD.
16. **MODE.** Scroll to select sound settings, voice activation and clock control (not the clock on The XJ).
17. ON/OFF, volume control and automatic volume control (AVC).
18. Send/end telephone call.
19. Enter phone mode.
20. **MR.** Memory recall - Phone memory access.
21. **CLEAR.** Remove digits (phone).

Quick Overview

Steering wheel controls (The XJ and S-TYPE)

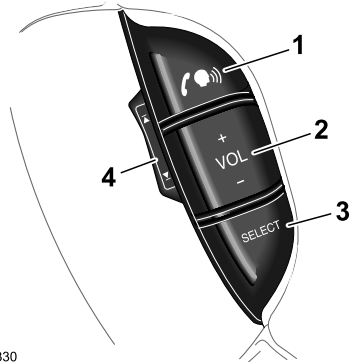

JOL3330

(X-TYPE)

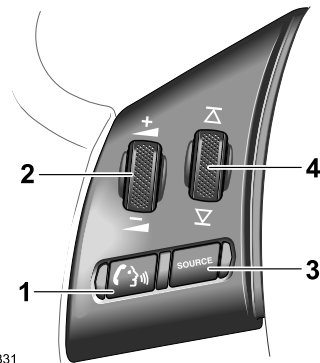

JOL3331

Note: Switches illustrated as 2 and 4 are:

- The XJ and S-TYPE - rocker switches.
- X-TYPE - part rotating switches which self-centre when released.

1. Press to start voice session, or mute when JaguarVoice is not fitted.
Answer phone call when ringing.
Send/End when in phone mode.
2. Press/rotate as required to increase or decrease volume.
3. Press and release to cycle through Radio FM, AM, Cassette, CD or MD and CD Changer, or press and hold for at least two seconds to select Phone Ready mode.
4. Press/rotate as required and release to cycle through preset radio stations, the next CD/MD track or tape AMS (Automatic Music Search).
Press/rotate and hold for at least two seconds to cycle to next strong station, next CD or change tape side.

Quick Overview

Radio Operation

For full details of radio operation, see page 14.

On/Off and volume control



Press the control knob to switch the radio on, press again to switch off. Turn the control knob clockwise to increase or counter clockwise to decrease volume.

Band switch AM/FM

Pressing **AM/FM** repeatedly will cycle the radio through the wavebands and the band selection will be shown in the display panel. When a tape or CD/MD is being played, pressing the band switch will select radio operation.

Radio Broadcast Data System (RBDS) operation



To activate, press the TA button and hold for at least two seconds until RBDS ON is displayed.

To de-activate, press the **TA** button and hold until **RBDS OFF** is displayed.

Single CD Player Operation

For full details of single CD operation, see page 23.

Inserting a CD into the CD aperture will start immediate play. The display will show **LOADING**, followed by **TR-01 00' 00"**



Press to eject the CD. The display will show **DISC EJECT** and the CD icon will be turned off.

MiniDisc (MD) Operation

For full details of MD operation, see page 24.

Inserting a MD into the MD aperture will start immediate play. The display will show **LOADING**, followed by **TR-01 00' 00"**



Press to eject the MD. The display will show **DISC EJECT** and the MD icon will be turned off.

Quick Overview

CD Changer Magazine

Caution: The 8 cm diameter discs and associated adaptors available in some countries must not be installed in the CD changer magazine. Any attempt to install these items can result in permanent damage to the CD changer mechanism.

CD check sequence

When the CD Player is switched on, a check is performed on each disc tray in the CD changer magazine. When the six trays have been checked the player returns to the first disc in the magazine.

Loading discs

Loading a disc into a magazine tray:

1. Slide the magazine door to the right.
2. Press the eject button. The magazine will then partly eject from the CD changer. Remove the magazine.
3. Pull a tray out from the magazine.
4. Ensuring that the playing surface is not touched, load a selected disc into the tray with the label facing upwards. Push the disc tray back into the magazine until it clicks.
5. With the arrow mark facing upwards and pointing towards the CD changer, insert the loaded magazine into the CD changer, ensuring that it clicks into position.

CD magazine slots are numbered **1** (bottom) to **6** (top).

Close the sliding door. Keep the sliding door closed to prevent dust entering the playing mechanism.

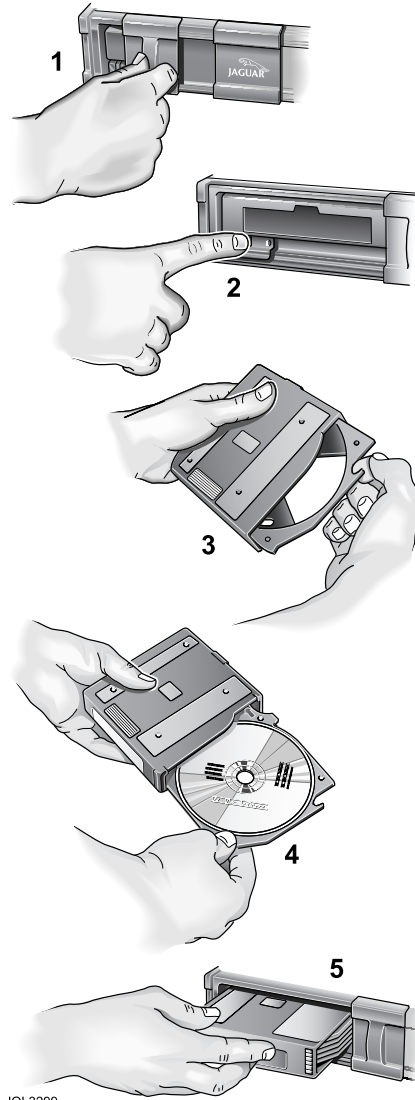

Quick Overview

JaguarVoice

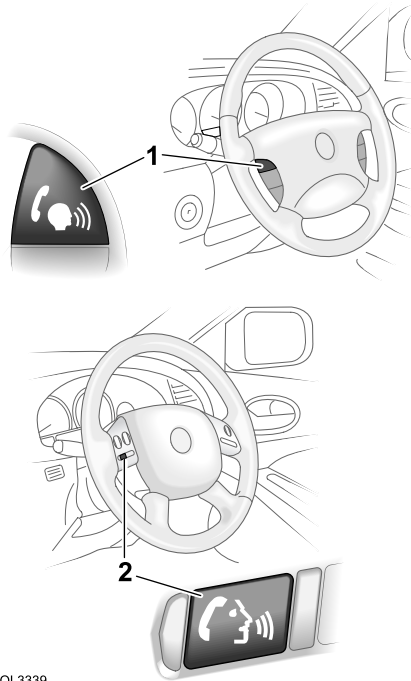

JOL3339

First - getting started

Press and release the voice button (1 - The XJ and S-TYPE) or (2 - X-TYPE), wait for the end of the beep and say: **'Voice Help'**.

The voice system will then give you a list of the help menus available.

To cancel the dialogue, press and release the voice button.

Next - try some commands

Press and release the voice button before each command, and try the following:

- **'Radio Tune 97.9 FM'**
- **'Changer Play Track 4'**
- **'Climate Control Temperature 21'**

- **'Phone On'**

Operating tips

- After pressing the voice button, wait for the end of the single listening beep before giving the command.* 'LISTENING' will be displayed on the instrument pack.
- Face forward and speak naturally, as if you were talking to a passenger or on the phone.
- Note the structure of the commands; remember this rather than trying to remember all the commands.

Device Function Setting



"Radio Tune 97.9"

- If you forget any of the commands, try saying 'VOICE HELP'. The system will then give you a list of help menus available, from which you can choose the appropriate one for the command you need.
- The Voice system will repeat the command back to you and display it on the message centre. The command will then be performed.
- If you hear a double beep when you give a command, press the voice button and try again.*

*A single beep denotes when the voice system is listening for a command. A double beep denotes when the system has stopped listening, due to an error or when an incorrect command has been given.

Quick Overview

Some useful commands

Key

< > indicates where to say a number or stored nametag.

[] denotes an optional word.

() denotes an option, i.e. (ON/OFF) use either ON or OFF with this command.

General commands

- HELP
- VOICE HELP
Lists all voice command help messages available.

Radio commands

- RADIO PLAY or RADIO ON
- RADIO OFF
- RADIO TUNE <frequency> FM
- RADIO STORE NAME

You can store nametags to all your favourite stations using this command.

The system responds: 'NAME PLEASE'.

Press the voice button and give a name of your choice.

Confirm the nametag by pressing the voice button and saying 'YES' to save or 'NO' to cancel.

- RADIO TUNE <nametag>
As stored in the command above.

Single CD/MiniDisc commands (where fitted)

- CD/MINIDISC PLAY or CD/MINIDISC ON
- CD/MINIDISC [PLAY] <track number>

CD changer commands (where fitted)

- [CHANGER] [PLAY] DISC <disc number> TRACK <track number>

Automatic climate control commands (where fitted)

- CLIMATE CONTROL ON
- CLIMATE CONTROL OFF
- [CLIMATE CONTROL] TEMPERATURE <temperature>

Phone commands (where fitted)

- PHONE (ON/OFF)
- [PHONE] ENTER <2-16 phone digits>

The system responds by repeating the phone number back to you and then giving you the options below.

Press the voice button and continue with one of these options:

- <more digits>
- DIAL
- STORE (give a *nametag* when prompted as in RADIO STORE NAME)
- CORRECTION
- CANCEL

- PHONE REDIAL

Note: In noisy conditions, for example, in heavy rain or driving at high speed on a rough road surface, use the PHONE ENTER command, entering the number in several groups for improved recognition.

Introduction

General Information

This Handbook describes every option and model variant available and therefore some of the items covered may not apply to your particular vehicle.

The vehicle Audio system interacts with the In-car Phone system via data on the multiplex communications vehicle network.

The audio system can be controlled from either the radio panel or multi-function controls on the left-hand side of the steering wheel, see page 8.

The sound system antenna is an integral part of the vehicle backlight and serves both FM and AM radio wavebands.

Radio Operation

Audio System Display Panel (in AM/FM mode)

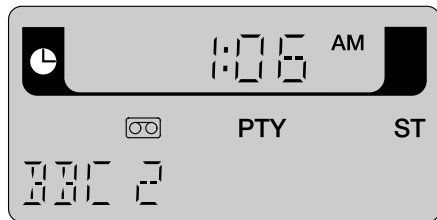

JOL2548

- PTY Priority programme type selected
ST Stereo

Note: The Audio System Display panel shown above and throughout this handbook, displays a clock symbol and the time in the top section, This is not displayed on The XJ audio system.

Radio Operation

Reception

FM reception offers the advantages of low noise interference, minimal distortion, wide dynamic range, extended frequency response, and is usually broadcast in stereo. FM frequency waves are however relatively short and travel in a straight line and can therefore be impeded by obstructions, which may adversely affect reception in certain parts of the country. This is a condition known as Multipath Interference.

Whilst FM reception generally provides better quality sound, AM reception may prove superior in remote areas not covered by the shorter range FM transmitters.

When experiencing poor FM reception, background noise can be reduced by pressing the **MODE** button, selecting **TREBLE** and reducing the treble setting.

On/Off and volume control



Press the control knob to switch the radio on, press again to switch off. Turn the control knob clockwise to increase or counter clockwise to decrease volume.

Any volume setting made whilst in audio, phone, or voice activation mode, will be memorised for that system.

Radio Operation

Automatic volume control (AVC)

This maintains radio volume at a level sufficient to overcome road noise as vehicle speed increases or decreases. To activate AVC, press and hold the volume control knob until AVC is displayed. To deactivate AVC, momentarily press the volume control knob again. The level of AVC control can be adjusted by turning the volume control knob whilst in AVC ON mode. When AVC is ON, manual adjustment of volume will override the AVC setting.

MODE button



The MODE button functions at two levels and is primarily used to adjust sound quality to personal preference. In addition, it is used to adjust Voice Activation volume, select Voice Activation Training and to set the audio display clock on the S-TYPE and X-TYPE. It can also inhibit the rear multimedia system controls on The XJ.

Mode level 1

Repeatedly press and release the MODE button to scroll through the following modes:

| | |
|-----------|---|
| BASS | Increase/decrease. |
| TREBLE | Increase/decrease |
| BALANCE | Left to right |
| FADE | Front to rear |
| SUB LEVEL | (Premium audio system only) Increase/decrease subwoofers. |

With a mode selected, adjust the volume control knob to the desired level. After approximately five seconds the audio system will return to normal volume control mode.

Digital signal processing (DSP)

(Premium audio system only)

DSP facilitates optimisation of sound for specific seating positions. To optimise sound for all seating positions:

- Repeatedly press the **MODE** button until **POS ALL** is displayed.
- Rotate the volume control knob to cycle through **POS F-LEFT** (front left), **POS F-RIGHT** (front right), **POS REAR** and **POS FRONT** until the desired setting is achieved.

Following approximately five seconds of no further actions or adjustments, the audio system will return to the previous display.

Note: To improve the comfort of passengers in the rear of the vehicle, the bass performance of the subwoofer is reduced when DSP mode is set to **POS ALL** or **POS REAR**.

For optimum bass performance it is recommended that the DSP mode is set to **POS FRONT**, **POS F-RIGHT** or **POS F-LEFT**.

Radio Operation

Mode level 2

(S-TYPE and X-TYPE)

Press and hold the **MODE** button until **TA VOLUME** is displayed, then repeatedly press and release to scroll to the following displays as required:

- **VOICE** (adjust Voice Activation volume).
- **VOICE TRAIN A.**
- **VOICE TRAIN B.**
- **CLOCK SET.**

Press and hold the **MODE** button to exit.

(The XJ only)

Press and hold the **MODE** button until **RMS LOCK/RMS UNLOCK/RMS H/PHONE** is displayed (if Rear Multimedia System (RMS) is fitted), then repeatedly press and release to scroll to the following displays as required:

- **RMS ON/RMS H/PHONE/RMS OFF** (adjust with rotary volume control).
- **RMS REAR SPKR ON: RMS REAR SPKR OFF** (adjust with rotary volume control).
- **TA VOLUME** (adjust with rotary volume control)
- **VOICE VOLUME** (adjust with rotary volume control)
- **VOICE TRAIN A** (press seek up to adjust)
- **VOICE TRAIN B** (press seek up to adjust)

Press and hold **MODE** button to exit.

Rear multimedia system settings

(The XJ only)



WARNING:

With the multimedia system turned on, the rear seat passengers have the ability to control the audio system functions including the adjustment of volume through the cabin speakers.

To inhibit the Rear Multimedia System Controls press and hold the **MODE** button until the current **RMS MODE** is displayed. The displays available are **RMS OFF**, **RMS ON** or **RMS H/PHONE**.

Rotate the volume knob one position to the left or right to change the system mode as required:

- **RMS ON** - This resets the rear switch pack controls.
- **RMS H/PHONE** - The rear switch pack control of cabin speakers is inhibited. Control using headphones is still available.
- **RMS OFF** - This fully inhibits the rear switch pack controls.

Radio Operation

Setting the audio display clock

(S-TYPE and X-TYPE)

- Press and hold the **MODE** button until **TA VOLUME** is displayed.
- Repeatedly press and release the **MODE** button until **CLOCK SET** is displayed.
- While the hour format is flashing, use the seek up/seek down keys to select either 12 or 24 hour format.
- Press and release the **MODE** button.
- If the 12 hour format has been selected, use the # key to select **AM** or **PM** as appropriate.
- Using the keypad, enter the correct time. It should be noted that the clock time must be entered as **four digits** e.g. **0325** or **1525**, when in 12 or 24 hour format.
- To exit clock setting procedure, press and hold the **MODE** button until the display reverts to audio mode.

Change audio system source



Press the desired audio system source button.

Source tone memory

Bass and Treble positions are automatically memorised for AM radio, FM radio, cassette tape and CD/MD, allowing individual settings for each mode.

Band switch AM/FM

Pressing AM/FM repeatedly will cycle the radio through FM wavebands. Band selection will be shown in the display panel. When a tape or CD is being played, pressing the band switch will select radio operation.

Presetting memorised radio stations



WARNING:

In the interests of road safety, do not attempt to preset a station while driving.

On each waveband, nine stations can be memorised using keypad buttons **1** to **9**. After tuning to a station, press and hold the selected button until the unit 'beeps'. A station can be recalled from the preset memory by pressing and immediately releasing the button.

Pressing the steering wheel preset selector button will cycle through the preset stations.

Radio Operation

Seek and manual tuning



In AM/FM mode, pressing and releasing the left or right button will activate the radio in seek mode, tuning through the frequency range to the next available station. Pressing either button for more than two seconds will enter manual tuning mode.

Auto memory (A MEM)



The automatic memory function programmes the nine strongest stations on a selected waveband to presets 1 to 9.

Note: *These are additional to the preset stations described earlier.*

To activate this function, press and hold **A MEM** button for at least two seconds.

The radio will be briefly muted while it searches the waveband for the nine strongest stations. When programming is complete the radio will default to preset number **1** and audio volume is restored.

If stations cannot be located for all preset positions, those that are found will be allocated positions commencing with number **1**, leaving the remainder not programmed. The display will show **NO FM** or **NO AM** if unprogrammed presets are selected.

To switch between the A MEM preset stations and your own presets, press and immediately release the **A MEM** button.

A MEM with radio broadcast data system (RBDS) selected

If the **A MEM** function is operated while in **RBDS** mode, the radio will be muted briefly, while a search is made for the nine strongest RBDS stations.

Radio broadcast data system (RBDS)

Jaguar sound systems are equipped with Radio Broadcast Data System (RBDS). When tuned to certain stations on the FM waveband, the radio decodes signals transmitted, to provide the following functions (dependent upon the service available).

- **RBDS station name display:**
When **RBDS** is selected the station name is displayed in eight characters.
- **RBDS Priority programme type auto re-tuning (where broadcast):**
This can be selected to interrupt and switch to the selected programme type e.g. **News**, for its duration.

Radio Operation

- RBDS Station/Programme type display and search:
RBDS displays information on the type of material broadcast by the station or programme that is on e.g. **News, Classical, Rock** etc. in addition to this function, the radio can search for a selected programme type.

RBDS operation



To activate RBDS, press the **TA** button and hold for at least two seconds until **RBDS ON** is

displayed.

To de-activate RBDS, press the **TA** button and hold until **RBDS OFF** is displayed.

With the radio tuned to an RBDS station and RBDS activated, the radio gathers RBDS information and displays the service name/data.

If the radio is not tuned to an RBDS station, it will remain on that station and display the frequency, and RBDS will remain on in readiness for a signal.

When RBDS data is lost the radio will stay on station, the display shows the frequency only and RBDS remains on in readiness for the signal to recover.

If the **RBDS** function does not respond correctly, see **RBDS Trouble-shooting guide** on page 21.

Programme type (PTY)

(Where broadcast)



This has two functions:

To display current station programme type and to select a programme type and re-tune to it.

Momentarily press the **PTY** button to display the current station programme type. Use the tuning buttons to cycle through the available programme types, press the **PTY** button again to activate a search for the selected programme type. If there is a station with the correct **PTY** then the radio will re-tune to it. If not, the radio will indicate **NO PTY** and return to the current station.

Priority programme type (PPTY)

Functions as an interrupt or as a 'PTY Following'.

Press and hold the **PTY** button to activate the selected priority programme type, **PPTY**. The radio will now wait for RBDS information to indicate that a station has changed its programme type, e.g. to **NEWS**. The radio will now re-tune to the new station for the duration that it remains on that programme type.

If the current station is already on the selected priority programme type, then when this station is lost, the radio will attempt to find another with the correct programme type.

To cancel priority programme type, press and hold the **PTY** button, the **PTY** indicator will clear from the display.

Note: *PPTY interrupt feature is also available in tape, CD and audio modes.*

Priority PTY interrupt skip

Interruptions for **NEWS** or other selected priority **PTY**, can be skipped by pressing **TA** during the interrupt. The radio returns to the previously selected audio source.

Note:

- *Interrupt skip will not cancel activation of **PPTY** and it will remain ready for the next interrupt.*

Radio Operation

- *PTY and priority PTY features are reliant upon the broadcast information from radio stations, and may be much better in some areas than others.*

PTY31-alarm (where broadcast)

When using the radio with **RBDS** selected, a **PTY31-ALARM** service will operate, to alert on any crises of major national importance. When such a broadcast is made, **ALARM** will appear in the audio display.

Radio Operation

RBDS trouble-shooting guide

| Incorrect response from RBDS | Reason and rectification |
|--|---|
| Radio does not display programme name. | Check that RBDS is turned on by pressing and holding the TA button until the display confirms RBDS ON . If the radio does not display a programme service name, it is not broadcasting RBDS data, or you are in a poor reception area. Try re-tuning to another station with RBDS. |
| Station name is lost and displays frequency only. | Radio has lost reception of the RBDS data due to vehicle moving out of transmitter range, loss of signal in a tunnel, under a garage forecourt canopy, or similar screening. If the latter is the case, when the vehicle is clear of the screening, the station name will return after a short delay. |
| Upon operating A MEM , NO FM is displayed when most or all of the preset positions are selected. | The radio cannot locate nine FM, RBDS FM stations dependent upon the mode selected. If this occurs, switch off RBDS and reselect A MEM . |

Cassette Tape Player

Cassette Tape Player Operation

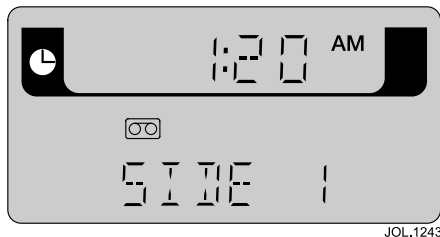

JOL.1243

The audio display will indicate which function has been selected.

Messages include:

| | |
|-------------------|---|
| SIDE1 UP1 | Locate beginning of next track on side 1. |
| SIDE1 DN1 | Locate beginning of track being played on side 1. |
| SIDE1 REW | Rewind. |
| SIDE 1 FF | Fast forward. |
| LOADING | Loading tape. |
| TAPE EJECT | Ejecting tape. |
| TAPE CLEAN | Tape mechanism requires cleaning. |

When loading, a tape immediately plays and after playing one side, auto-reverses and plays the other. Equalisation of non-ferric tapes is automatically adjusted.

TAPE button



If you are playing the radio or CD changer, pressing TAPE will play any cassette in the player. This function can also be controlled by a switch on the steering wheel, see page 8.

Change tape side

While playing a cassette, press the TAPE button to change to the other side of the tape. This function can also be controlled by a switch on the steering wheel, see page 8.

Eject and tape-in indicator



When a cassette is inserted, the aperture door closes and a cassette icon is displayed. Press to eject the cassette.

Fast forward and rewind



These controls have two functions, to seek a track, and tape fast forward or rewind. Momentarily pressing the right-hand button will locate the beginning of the next track. Similarly pressing the left-hand button, will return to the beginning of the current track. Pressing and holding the appropriate button for two seconds will activate continuous fast forward or rewind of the tape. This can be cancelled by pressing either button again.

Dolby B



When using a cassette with a 'Dolby' recording, the noise reduction system can be selected by pressing the DOLBY on/off button. DOLBY will be displayed to indicate the system is active.

Dolby noise reduction system is manufactured under licence from Dolby Laboratories Licensing Corporation. 'Dolby' and the double-D symbol are trade-marks of the Dolby Licensing Corporation.

Single CD Player

Single CD Player Operation

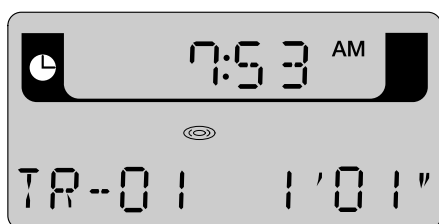

JOL1634

The audio display will indicate which function has been selected.

Messages include:

| | |
|---------------------|-----------------------|
| LOADING | Loading CD. |
| EJECTING | Ejecting CD. |
| MIX TRACKS | Mix random tracks. |
| REPEAT TRACK | Repeat current track. |

PAUSED CUE/REVIEW

Inserting a CD into the CD aperture will start immediate play. The display will show **LOADING**, followed by **TR-01 00' 00"**. The CD symbol will also be displayed until the CD is ejected, regardless of the selected audio source.

Eject and CD-in indicator

 When a CD is inserted, the CD icon is displayed. Press to eject the CD. The display will show **DISC EJECT** and the CD icon will be turned off.

MIX

 To play random tracks from the disc, press and release the **MIX** button. **MIX** will be displayed. To cancel, press the **MIX** button again.

CD button

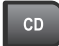
 If you are playing the radio or CD changer, pressing the **CD** button will resume playing any CD installed in the player mechanism.

The audio display will show **TR-NN MM' SS"**, where **NN** is the current track number and **MM SS** is the track time in minutes and seconds.

Pressing the **CD** button while in CD play mode will pause the current track, the display will show **TR-NN PAUSE** where **NN** is the current track number. A subsequent press of the **CD** button will resume play mode.

This function can also be controlled by a switch on the steering wheel, see page 8.

REPEAT

 Press and release **REPEAT** button to repeat the current CD track being played. To cancel, press the **REPEAT** button again.

Seek up and down

 This control selects seeking of tracks up or down. Momentarily press the right-hand button to skip to the next track. Repeated pressing will select further tracks.

The left-hand button returns to the beginning of the current track. Repeated pressing selects previous tracks.

Pushing and holding either button selects cue and review of the CD.

Note: *Sound level is reduced when cueing and reviewing a CD.*

MiniDisc Player

MiniDisc (MD) Operation

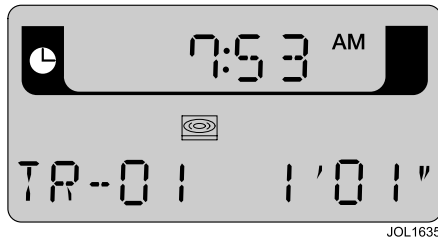

JOL1635

The audio display will indicate which function has been selected.

Messages include:

| | |
|---------------------|-----------------------|
| LOADING | Loading MD. |
| EJECTING | Ejecting MD. |
| MIX TRACKS | Mix random tracks. |
| REPEAT TRACK | Repeat current track. |

PAUSED CUE/REVIEW

Inserting a MD into the MD aperture will start immediate play. The display will show **LOADING**, followed by **TR-01 00' 00"**. The MD symbol will also be displayed until the MD is ejected, regardless of the selected audio source.

Eject and CD-in indicator

 When a MD is inserted, the MD icon is displayed. Press to eject the MD. The display will show **DISC EJECT** and the MD icon will be turned off.

MIX

 To play random tracks from the disc, press and release the MIX button. MIX will be displayed. To cancel, press the MIX button again.

MD button

 If you are playing the radio or CD changer, pressing the MD button will resume playing any MD installed in the player mechanism.

The audio display will show **TR-NN MM' SS"**, where **NN** is the current track number and **MM SS** is the track time in minutes and seconds.

Pressing the **MD** button while in MD play mode will pause the current track, the display will show **TR-NN PAUSE** where **NN** is the current track number. A subsequent press of the **MD** button will resume play mode.

This function can also be controlled by a switch on the steering wheel, see page 8.

REPEAT

 Press and release REPEAT button to repeat the current MD track being played. To cancel, press the REPEAT button again.

Seek up and down

 This control selects seeking of tracks up or down. Momentarily press the right-hand button to skip to the next track. Repeated pressing will select further tracks.

The left-hand button returns to the beginning of the current track. Repeated pressing selects previous tracks.

Pushing and holding either button selects cue and review of the MD.

Note: Sound level is reduced when cueing and reviewing a MD.

User Operating Preferences

Radio Set Up

This function enables the radio to be set to user operating preferences. By selecting SET UP and using the preset buttons, the owner or Jaguar Retailer can adjust certain radio functions.

When in **SET UP**, pressing the relevant preset button, as detailed below, will display the facility selected and its state. The state of that facility can be changed by pressing the preset button again.

To enter SET UP: Press **Tape Eject/CD/MD Eject** and **AM/FM** buttons simultaneously.

The display will show **SET UP**. The following preferences can be selected or changed in any order, within a 15 second period. After 15 seconds the display will clear and exit **SET UP**.

Preset 1 Press **Preset 1** to enable or disable RBDS availability in the user's country.

Preset 2 On cassette tape models, this controls the **Tape Clean** reminder facility. To switch off this reminder, press the **Preset 2** button until **TAPE CLN OFF** shows on the display.

Preset 3 Blank.

Preset 4 Blank.

Preset 5 **KEY OFF EJECT** - On cassette tape models, this sets the cassette tape to automatically eject when the ignition key is turned to position '0'.

Preset 6 Blank.

Preset 7 Blank.

Preset 8 Blank.

Preset 9 Blank.

Preset 10 During initial factory installation, this is used to set the radio to the USA region. Regional settings determine the correct frequency increments required for seeking stations, automatic tuning etc.

Note: *The regions are preset at the factory. Should you require a regional change, consult your Jaguar Retailer.*

Compact Disc Changer

Compact Disc (CD) Changer Operation

A CD changer (where fitted) is installed in the luggage compartment and will accommodate up to six discs, each mounted in a tray.

Caution: The 8 cm diameter discs and associated adaptors available in some countries must not be installed in the CD changer magazine. Any attempt to install these items can result in permanent damage to the CD changer mechanism.

CD check sequence

When the CD Player is switched on, a check is performed on each disc tray in the CD changer magazine. When the six trays have been checked the player returns to the first disc in the magazine.

Loading discs and inserting magazine

Loading a disc into a magazine tray: Slide the magazine door to the right (1). Press the eject button (2), the magazine will then partly eject from the CD changer. Pull the disc tray from the magazine (3). Ensuring the playing surface is not touched, load a selected disc into the tray with the label facing upwards (4). Push the tray back into the magazine until it clicks. Tray slots are numbered 1 (bottom) to 6 (top).

Inserting the magazine: With the arrow mark facing upwards and pointing towards the CD changer, insert the loaded magazine into the CD changer (5) ensuring that it clicks into position. Close the sliding door. Keep the sliding door closed to prevent dust entering the playing mechanism.

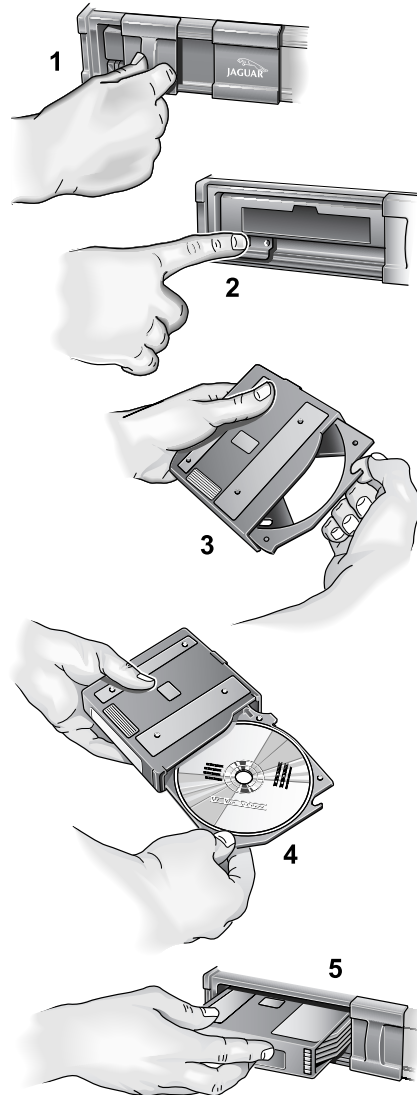

JOL3299

Compact Disc Changer

CD changer mode

The audio display indicates the CD and track being played, and CD status.

Below is an example of the display when playing track 1 from CD4.

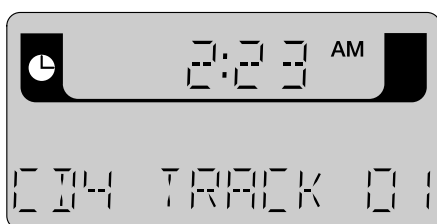

JOL.1244

Other messages:

| | |
|--------------------|---|
| CD1 LOADING | CD1 is being loaded. |
| NO DISC | In the selected position. |
| NO MAGAZINE | In the CD autochanger. |
| CD1 MIX 10 | The player is playing CD1 in MIX mode (track 10). |
| D MIX | All CDs are in MIX mode. |
| MAG EJECT | Magazine is being ejected. |
| PAUSED | The CD changer is paused and ready to play. |

CDC button

 Press CDC to select CD changer mode.

Note: Button labelled as **CD** for cassette and MiniDisc models.

This function can also be controlled from the appropriate switch on the steering wheel, see page 8.

CD selection



Preset buttons **1** to **6** select the compact discs in those positions in the magazine. If there is no disc in the selected position, **NO DISC** will be displayed. If there is no magazine in the CD changer, **NO MAGAZINE** will be displayed.

MIX

 To play random tracks from the disc, press and release the MIX button. MIX will be displayed. To cancel, press the MIX button again.

To play random tracks from all discs present in the magazine, press the **MIX** button for two seconds. **DISC MIX** will be momentarily displayed, followed by **D MIX**. To cancel, press and hold the **MIX** button.

Seek up and down

 This control selects seeking of tracks up or down. Momentarily press the right-hand button to skip to the next track. Repeated pressing will select further tracks.

The left-hand button returns to the beginning of the current track. Repeated pressing selects previous tracks.

Pushing and holding either button selects cue and review of the CD.

Note: Sound level is reduced when cueing and reviewing a CD.

Compact Disc Changer

REPEAT



Momentarily press the REPEAT button to repeat the current CD track being played, R-ONE will be displayed. To cancel, momentarily press the REPEAT button again.

Press and hold the **REPEAT** button for two seconds to repeat the current CD, **R-ALL** will be displayed. To cancel, press and hold the **REPEAT** button again for two seconds.

Pause



When playing a CD, press CDC button to pause play. Press again to continue play.

Audio System Care

Caution: Care must be taken to avoid spilling or splashing drinks onto the audio system head. In the event of such an occurrence advise your Jaguar Retailer

Radio

Do not use gasoline, solvents or abrasive cleaners on the radio. Wipe the surface of the radio with a lint-free cloth to remove dust. Slightly moisten the cloth with clean water to remove any finger marks from the outside surface of the radio.

If the radio is to be removed or the battery disconnected, first ensure that the radio code is recorded. The number will be required for re-insertion following radio installation.

Cassettes

Always use good quality cassettes. Inferior quality tapes can jam the player mechanisms, adversely affect sound quality, and accelerate the build-up of deposits on the play-back head.

Before playing a cassette, ensure that the tape is not loose on the spools. If necessary, take up the slack by gently turning the spools with the end of a pencil. A jammed or sticking tape will cause the auto-reverse mechanism to operate continuously.

It is advisable not to use a tape longer than 45 minutes playing time each side (C90). Cassettes should be stored in their library cases away from direct sunlight. Do not store cassettes in door pockets where magnets in loud-speakers can impair sound reproduction. Never insert a cassette that has a torn or loose label, it may cause the mechanism to jam.

After approximately 15 hours playing time, the audio screen will display '**CLEAN TAPE**'. Clean the tape mechanism itself using a proprietary cassette cleaning kit available from any good Hi-Fi stockist.

Caution: Do not use abrasive type cleaners as they can cause excessive wear of the play-back head.

Compact discs (CDs)

When handling CDs, do not touch the playing surface. CDs should be stored in their cases away from direct sunlight, heat and dust. Scratches, finger-marks or dust on the surface of a disc can cause the optical pick-up to skip tracks. If the surface of a CD is dirty, use an appropriate CD cleaner.

Do not attempt to play discs that are damaged, warped, cracked or of incorrect size. They can seriously damage the play-back mechanism.

L



JaguarVoice

General Information

This Section describes every option and model variant available and therefore, some of the items covered may not apply to your particular vehicle.

Introduction

JaguarVoice provides a safe and convenient way of controlling the following vehicle systems (where fitted):

- Sound system (radio, cassette tape player, single CD player, MiniDisc player and CD changer - as applicable)
- In-car telephone
- Climate control system (front user only unless 4 zone climate control is fitted)

The system is controlled by the Voice button on the left-hand side of the steering wheel and also on The XJ, in the rear multimedia switchpack (if fitted).

See the illustrations on the following pages.



WARNING:

Concentrate on the current road conditions and driving the vehicle at all times. If the voice system does prompt you for a response it will repeat that prompt twice giving you up to 15 seconds to respond. If driving conditions mean that you are unable to respond, the voice system will timeout, cancel the task and will not make any changes to the vehicle settings.

Language and accent

Commands are given in English using a natural speaking voice, without pausing between words. Most accents are understood without difficulty, but the system also allows you to train the voice system with your voice if required, see Voice Training on page 43.

JaguarVoice

Steering wheel voice switches

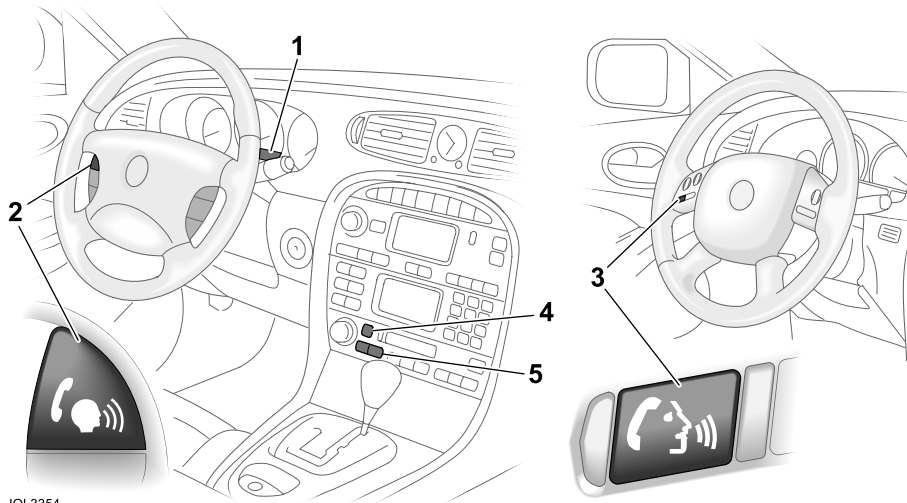

1. Message centre display.
2. Voice button - The XJ and S-TYPE.
3. Voice button - X-TYPE.
4. Mode button, on radio.
5. Seek/tuning control, on radio (Used to commence voice training).

Using the System

Initialisation

JaguarVoice is ready to operate, ten seconds after the ignition switch is turned to position 'II' (ignition on), the system is enabled.

Driver voice controls

The voice button is on the left-hand side of the steering wheel.

Some examples of using the system are provided on the following pages for you to try.

JaguarVoice

First try some of these commands

Tuning the radio

| Your instructions to the system | System response |
|--|---|
| Press and release the voice button | 'Beep' |
| After the beep say ' Radio tune 98.9 FM ' | The system responds with: 'Radio tune 98.9 FM' and tunes the radio to this frequency |

Now try entering a frequency of your own preference, see **How to Say Numbers** on page 37.

Storing a nametag to this station

| Your instructions to the system | System response |
|--|--|
| Press and release the voice button | 'Beep' |
| After the beep say ' Radio store name ' | The system responds with: 'Radio store name, Name Please' |
| Press and release the voice button | 'Beep' |
| After the beep say ' My favourite station ' | The system responds with: 'My favourite station, please say yes or no' |
| Press and release the voice button | 'Beep' |
| After the beep say ' Yes ' | After a few seconds the system responds with: 'My favourite station stored' |

Recalling the nametag you have just stored

| Your instructions to the system | System response |
|---|---|
| Press and release the voice button | 'Beep' |
| After the beep say ' Radio tune my favourite station ' | The system responds with: 'Radio tune my favourite station' and tunes the radio to the frequency stored with this name |

Now try storing a nametag of your choice, and then recalling it.

JaguarVoice

Entering a phone number

| Your instructions to the system | System response |
|---|---|
| Press and release the voice button | 'Beep' |
| After the beep say ' Phone enter zero one six one four ' | The system responds with: 'Phone enter oh one six one four,.....Continue entering digits or say dial, store, correction or cancel' |
| Press and release the voice button | 'Beep' |
| After the beep say ' nine six oh nine nine eight ' | The system responds with: nine six oh nine nine eight,.....Continue entering digits or say dial, store, correction or cancel' |
| Press and release the voice button | 'Beep' |
| After the beep say ' Cancel ' | The system responds with: 'Enter cancel' |

Now try entering a phone number of your choice and try some of the following commands:

1. **DIAL**, dials the number entered.
2. **STORE**, stores a nametag of your choice (as in the above example with **RADIO STORE NAME**).
3. **CORRECTION**, deletes the last string of digits entered, and allows you to re-enter them.
4. **CANCEL**, cancels the command.

Note: When entering a number of your choice, remember numbers can only be given as single digits, but you can enter the digits in as many groups as you like.

Also, when the system has read out the numbers you have entered, you do not have to wait for the 'Continue entering digits' prompt. Simply press the voice button and continue with your dialogue.

JaguarVoice

Operating tips

- After pressing the voice button, wait for the end of the single listening beep before giving the command.*
'LISTENING' will be displayed on the instrument pack.
- Face forward and speak naturally, as if you were talking to a passenger or on the phone.
- Note the structure of the commands; remember this rather than trying to remember all the commands.

Device Function Setting



"Radio Tune 97.9"

- If you forget any of the commands, try saying 'VOICE HELP'. The system will then give you a list of help menus available, from which you can choose the appropriate one for the command you need.
- The Voice system will repeat the command back to you and display it on the message centre. The command will then be performed.
- If you hear a double beep when you give a command, press the voice button and try again.*

* A single beep denotes when the voice system is listening for a command. A double beep denotes when the system has stopped listening, due to an error or when an incorrect command has been given.

Command confirmation

After a command has been given, the system will give feedback of what it understood. The verbal feedback can be switched on or off by saying 'VOICE FEEDBACK ON' or 'VOICE FEEDBACK OFF'. Verbal feedback for help commands, directory listings, prompts, error messages and nametags cannot be switched off.

For the 'PHONE DIAL' commands, the system will prompt for confirmation before making the call. This confirmation can be switched on or off by saying 'PHONE CONFIRMATION ON' or 'PHONE CONFIRMATION OFF'.

For each voice command there is an associated visual confirmation, which is shown on the front instrument pack.

Voice system prompts

During some commands and for voice training, you will be asked by the system for a reply. In such cases you must press and release the voice button then speak after the beep. The system will remind you twice so don't worry about having to respond to the system immediately.

JaguarVoice

Nametags

Nametags are a unique name or phrase of your choice which can be used to recall a radio station or dial a phone number.

For radio commands, 'PHONE DIAL <nametag>' is used to select a station that has been previously stored using the 'RADIO STORE NAME' command.

For phone commands, 'RADIO TUNE <nametag>' is used to dial a phone number that has been previously stored using the 'PHONE ENTER' or 'PHONE STORE' command. Phone numbers held in the voice system memory are quite separate from numbers held in the phone system memory (To call a number held in the phone memory, use the 'PHONE DIAL MEMORY <number>' command).

A spoken list of current nametags can be heard by giving the appropriate directory command.

- 'RADIO DIRECTORY'
- 'PHONE DIRECTORY'

There are also commands for deleting either individual names in a directory, or a complete directory, see **Voice Command List** on page 38.

Hints on storing nametags

- You will have greater success of recalling, and remembering, nametags of two, three, or four words in length. Although nametags of one word in length are also acceptable.
- For best results, store nametags in a quiet environment, i.e. with the windows and sunroof closed, try not to be travelling at speeds above 60 mph (110 km/h), and ask other occupants to be quiet.

- Try not to store a nametag that sounds similar to a nametag already stored, or to any of the commands recognized by the system.

In addition, for phone nametags, do not use numbers, and for radio nametags, try not to use radio frequencies.

Volume level adjustment

The verbal feedback volume level can be adjusted independently for the JaguarVoice system. To adjust, operate the sound system volume control or the steering wheel volume control whilst the voice system is being used. The speaker volume level can also be adjusted within the volume preset menu of the audio system.

Some useful notes:

- Only one person at a time can use the voice system.
- Excessive noise, for example while driving with windows open or in demist mode, may cause voice command misrecognition. If it is too noisy to use the phone, it is likely that voice commands will not be recognised.
- Voice commands cannot be given while hands free phone call is in progress.

JaguarVoice

- While 'LISTENING' is displayed on the message centre, the command can be cancelled by pressing the voice button, except when using the 'PHONE ENTER' command. To cancel a 'PHONE ENTER' voice session either say 'CANCEL' when 'LISTENING' is displayed or press the voice button and after the end of the beep say 'CANCEL'. During a store nametag session, if the voice button is pressed and released during 'LISTENING', the system will cancel after up to 2 seconds.
- Voice feedback can be interrupted by pressing the voice button that was used to start the voice session, whilst the feedback is playing.
- After starting to speak, the command must be completed within 10 seconds.
- During a voice command the audio system and direction indicator ticking will be muted.
- The voice session will be cancelled if an alternative message requires the display/speaker (e.g. incoming phone call).

How to Say Numbers

Numbers in voice commands must be given as shown below. Either 'zero' or 'oh' can be used for '0', most users will find that 'zero' gives better results. For information about specific commands, see Voice Command List on page 38.

Radio stations

Frequencies are said as in the following examples:

- 'Tune five thirty one AM', or 'Tune five thirty one' (531).
- 'Tune nine hundred' (900).
- 'Tune fourteen forty' (1440).
- 'Tune fifteen ten AM' (1510).
- 'Tune ten eighty' (1080).
- 'Tune eighty seven point nine FM', or 'Tune eighty seven point nine' (87.9)
- 'Tune ninety point one' (90.1).
- 'Tune one hundred point five' (100.5)
- 'Tune one oh one point one FM' (101.1)
- 'Tune one oh seven point nine' (107.9)

JaguarVoice

Disc and track numbers

For CD changer, single CD or MiniDisc commands, say disc and track numbers as in the following examples:

- 'Disc one' (1).
- 'Disc six track ten' (6, 10).
- 'Track twenty five' (25).
- 'Track forty seven' (47).

Phone numbers

All phone numbers are said as single digits, as in the following example. Plus (+), Star (*) and Hash (#) are acceptable as the first digit of a number.

- 'Dial one two zero one eight one eight eight one zero zero' (1-201-818-8100)

When using the Phone Enter command, the first entry must be between 2-16 digits, then, 1-16 digits to a maximum of 32 in total

Temperatures

In climate control commands, say temperatures as in the following examples:

- 'Temperature seventy two' (72).
- 'Temperature eighty' (80).
- 'Temperature twenty one point five' (21.5).
- 'Temperature nineteen point zero', 'Temperature nineteen point oh' or 'Temperature nineteen' (19.0).

Voice Command List

Key

() denotes an option, i.e. (ON/OFF) use either ON or OFF with this command.

< > indicates where to say a number or stored nametag.

[] denotes an optional word, e.g. 'VOICE [PLAY] DIRECTORY' can be given as 'VOICE DIRECTORY', or 'VOICE PLAY DIRECTORY'.

General commands

- HELP
- VOICE HELP
Lists all voice command help messages available.
- VOICE MEMORY HELP
- VOICE FEEDBACK (ON/OFF)
- PHONE CONFIRMATION (ON/OFF)
Switches on or off the system confirmation prompt before making a call when using the PHONE DIAL or PHONE MEMORY DIAL command.
- VOICE [PLAY] DIRECTORY (front use only)
- VOICE DELETE MEMORY (A/B)
- VOICE DELETE DIRECTORY

JaguarVoice

Radio commands

- RADIO PLAY or RADIO ON
Turns the sound system on.
- RADIO OFF
Turns the sound system off. Use this command to turn off the CD, Tape or CD changer.
- RADIO SEEK [UP]
- RADIO SEEK DOWN
- RADIO TUNE <frequency> [MEDIUM WAVE/FM]
Tunes to the frequency given in the command.
The frequency ranges are:
FM - 87.9 to 107.9 MHz in steps of 0.2 MHz.
AM - 530 to 1710 KHz in steps of 10 KHz.
See **How to Say Numbers** on page 37.
If an invalid frequency is given, the voice system will either respond with COMMAND NOT RECOGNIZED or will recognize a similar sounding frequency.
- RADIO TUNE <nametag>
- [RADIO] [TUNE] PRESET <preset number>
Selects the stored station corresponding to the preset number (1 to 9) given in the command.
- [RADIO] [TUNE] [BAND] (MEDIUM WAVE/FM)
- RADIO STORE NAME

Stores the currently selected station, with a nametag of your choice. See **Storing a nametag to this station** on page 33. A total of 20 nametags can be stored.

- [RADIO] STORE PRESET <preset number>

Stores the currently selected station to the preset given in the command.

Note: *The sound system must be in radio mode before giving the 'RADIO STORE NAME' or 'RADIO STORE PRESET' command.*

- RADIO AUTOSTORE
- RADIO DELETE <nametag>
- RADIO DELETE DIRECTORY
Deletes all currently stored radio nametags.
- RADIO [PLAY] DIRECTORY
- RADIO HELP
- RADIO MEMORY HELP

Cassette tape player commands (where fitted)

- TAPE PLAY or TAPE ON
- [TAPE] REVERSE
- [TAPE] REWIND
- [TAPE] FAST FORWARD
- TAPE SEEK [UP]
- TAPE SEEK DOWN
- [TAPE] DOLBY ON/OFF
- TAPE HELP

JaguarVoice

Single CD commands (where fitted)

- CD PLAY or CD ON
- CD [PLAY] TRACK <track number>
See **How to Say Numbers** on page 37.
- CD MIX TRACKS
This will play the tracks of the current disc in a random order.
- CD MIX OFF
- CD HELP

MiniDisc commands (where fitted)

- MINIDISC PLAY or MINIDISC ON
- MINIDISC [PLAY] TRACK <track number>
See **How to Say Numbers** on page 37.
- MINIDISC MIX TRACKS
This will play the tracks of the current disc in a random order.
- MINIDISC MIX OFF
- MINIDISC HELP

CD changer commands (where fitted)

- CHANGER PLAY or CHANGER ON
- [CHANGER] [PLAY] DISC <disc number>
- [CHANGER] [PLAY] TRACK <track number>
See **How to Say Numbers** on page 37.
- [CHANGER] [PLAY] DISC <disc number> TRACK <track number>
- CHANGER MIX TRACKS
This will play the tracks of the current disc in a random order.
- CHANGER MIX ALL
This will play all the tracks and discs within the CD changer in a random order.
- CHANGER MIX OFF
- CHANGER HELP

Generic track commands

These commands play the current or previous CD, MD or Changer.

- [PLAY] TRACK <track number>
- MIX TRACKS
- MIX OFF

JaguarVoice

Phone commands (where fitted)

Note: In noisy conditions, for example, in heavy rain or driving at high speed on a rough road surface, use the PHONE ENTER command, entering the number in several groups for improved recognition.

- PHONE (ON/OFF)
- [PHONE] ENTER <2-16 phone digits>

See **How to Say Numbers** on page 37.

The system responds to this command by repeating the phone number back to you and then giving you the options below.

Remember to press the voice button to continue with one of the options.

- <more digits>

- DIAL

- STORE (give a *nametag* when prompted as in RADIO STORE NAME, see **Storing a nametag to this station** on page 33)

- CORRECTION

- CANCEL

For help, see **Entering a phone number** on page 33.

A total of 40 nametags can be stored.

- (PHONE DIAL/DIAL) <phone number>
See **How to Say Numbers** on page 37.
- [PHONE] REDIAL
- [PHONE] DIAL <nametag>
Calls the phone number stored with the nametag given.
- [PHONE] DIAL MEMORY<memory location number>

Calls the phone number stored in the phone memory location given.

See **How to Say Numbers** on page 37.

Memory numbers 1-100 refer to numbers stored in the phone memory and numbers 101-249 are numbers stored in the SIM card.

- PHONE STORE <phone number>

Allows you to store a nametag to the number given in the command.

The system will prompt you with 'NAME PLEASE', press and release the voice button and give a nametag of your choice, as in the RADIO STORE NAME. See **Storing a nametag to this station** on page 33.

A total of 40 phone nametags can be stored.

See **How to Say Numbers** on page 37.

See **Nametags** on page 36.

- PHONE [PLAY] DIRECTORY
- PHONE DELETE <nametag>
- PHONE DELETE DIRECTORY

Deletes all currently stored phone nametags.

This does not affect numbers stored in the phone memory.

- PHONE CONFIRMATION (ON/OFF)
- PHONE HELP
- PHONE MEMORY HELP

JaguarVoice

Phone commands (continued)

Note:

- *When an outgoing phone call is terminated, the sound system will remain in phone mode. To change to another mode, give the appropriate voice command.*
- *The voice system is inactive while a phone call is in progress.*

Automatic climate control commands (where fitted)

- CLIMATE CONTROL ON
 - CLIMATE CONTROL OFF
 - [CLIMATE CONTROL] AUTOMATIC [ON]
 - [CLIMATE CONTROL] TEMPERATURE <temperature> [DEGREES]
- The temperature can be given in Fahrenheit or Celsius, in the range 61 to 89 degrees Fahrenheit (17 to 31 degrees Celsius), in increments of 1.0 degree Fahrenheit (0.5 degree Celsius).

See **How to Say Numbers** on page 37.

Note: Do not say the word 'Fahrenheit' or 'Celsius'.

- [CLIMATE CONTROL] TEMPERATURE (HIGH/LOW)
- [CLIMATE CONTROL] RECIRC [ON]
Recirculation mode, see Owner's Handbook for help.
This command will not be executed if the climate control system is in defrost mode.

Automatic climate control commands (continued)

- [CLIMATE CONTROL] BALANCE [ON]
When the driver gives this command the temperature of all zones are set to the same as the driver's side temperature.
- [CLIMATE CONTROL] DEFROST [ON]
- CLIMATE CONTROL HELP
- REAR CLIMATE CONTROL OFF

Manual climate control commands (where fitted)

- [CLIMATE CONTROL] RECIRC [ON]
Switches the climate control system to recirc mode (see Owner's Handbook for details). This command will be disabled if the climate control system is in defrost mode.
- CLIMATE CONTROL HELP
Gives spoken information about the climate control voice commands.

JaguarVoice

Voice Training

The voice system is able to interpret most English speakers without difficulty. If, however, you find that commands are sometimes not being recognised, you can train the voice system to recognize your voice. The voice system can be trained for two people using voice memories A and B.

After Voice Training, the system will automatically recognise the users whose voices are held in the voice memory. The system can still be used by other users, with no loss of recognition.

Training procedure

Training can only be carried out whilst sitting in the driver's seat.

Give the command 'VOICE DIRECTORY', this will list the memories used and tell you if they are stored with a nametag.

If no memories are in use, either memory can be used.

If both memories are in use and you wish to overwrite one of the memories select the memory you wish to overwrite.

- First, select which voice memory to train.
- Position the vehicle, with the sunroof and windows closed, in a reasonably quiet outdoor location.
- Sit in the driving seat with the engine running, the handbrake or electronic parkbrake on and the transmission in Park or Neutral.

- Press and hold the MODE button on the radio (adjacent to the volume control) for more than 2 seconds. The radio display will then show 'TA VOLUME'. Press the MODE button twice more until 'VOICETRAIN A' is displayed. To select 'VOICETRAIN B' press the MODE button again.
- With 'VOICETRAIN A' or 'VOICETRAIN B' displayed on the radio press the seek up control to start Voice Training. Once you have selected which memory to use, the system gives verbal instructions about the training procedure.
- Follow the instructions given by the system. See **Training Command List** on page 44.
- To cancel Voice Training at any time press and hold the voice button for 5 seconds.

Note:

- *Some of the phrases which the voice system asks you to repeat during Voice Training are not valid voice commands, these are used to collect specific phonetic phrases required by the system.*
- *If the user does not speak after a phrase prompt, the voice system will provide two reminder prompts then cancel Voice Training.*
- *The voice system turns off the phone whilst in training mode, so it will need to be turned on manually after Voice Training has finished.*

JaguarVoice

Training Command List

The 'sounds' of the following training commands are required for the voice system to 'learn', although some of the equipment (TV, navigation, telephone etc.) stated in the commands may not be fitted to a particular vehicle.

1. climate temperature eighteen point oh degrees
2. telephone enter star zero seven zero four
3. navigation show turn list
4. map zoom out maximum
5. telephone enter one seven hundred five six two four
6. phone enter eight zero oh nine zero
7. CD changer play disc one track seventy three
8. tune one oh three point one FM
9. climate temperature twenty four point oh degrees
10. map traffic information off
11. MiniDisc mix tracks on
12. telephone enter eight five two nine six
13. navigation select zoom level eleven
14. radio fifteen fifty AM
15. phone enter pound seven three two five
16. voice delete memory A
17. CD changer play CD four track forty two
18. telephone enter star six one seven zero
19. climate control nineteen point oh degrees
20. display select automatic colors
21. avoid major roads
22. navigation clear next waypoint
23. phone dial memory sixty nine
24. repeat last instruction
25. navigation show complete route
26. radio tune ninety one point five FM
27. radio seek down
28. CD track ten
29. cassette fast forward
30. tape reverse
31. changer play CD six track thirty eight
32. MiniDisc random tracks off
33. radio store preset nine
34. changer disc three track eighty eight
35. display select night colors
36. prefer toll roads
37. navigation show current position
38. radio traffic info on
39. map zoom in max
40. tape seek up

JaguarVoice

Trouble-shooting Error Messages

In addition to the voice command prompts given by the system, the following error messages may be displayed on the instrument cluster display. Most of these messages are accompanied by an advisory double beep.

| Voice Command Group | Message | Meaning |
|---------------------|--------------------|--|
| General | VOICE NOT READY | The voice system is initialising (when ignition is first turned on). It takes the voice system approximately 10 seconds to initialise |
| | NO SPEECH DETECTED | <p>The voice system has not heard any speech.</p> <ul style="list-style-type: none"> • Ensure that the command is given after the end of the beep. • Ensure that the command is given within a maximum of 5 seconds from the end of the beep. <p>Note: <i>Be sure you know what to say before pressing the Voice button.</i></p> <p>If this error is displayed for all commands given this may indicate a fault with the microphone or microphone wiring, consult your Retailer for assistance.</p> |
| | COMMAND CANCELLED | Displayed if the user cancels a voice session during the LISTENING period or another system interrupts the voice session (i.e. incoming phone call). |

JaguarVoice

| Voice Command Group | Message | Meaning |
|------------------------|------------------------|---|
| General (continued) | COMMAND NOT RECOGNISED | <p>The voice system has failed to recognise your command.</p> <ul style="list-style-type: none"> • Ensure that the command format is valid, see Voice Command List on page 38. • Ensure that the command is given after the end of the beep. • Look forward and speak clearly without pausing between words and at a level appropriate to the ambient noise level; imagine you are making a handsfree phone call. • Ensure that the ambient noise level is not excessive, for example, windows open or demist on. <p>Note: <i>If it is too noisy to use the phone, it is likely that voice commands will not be recognised.</i></p> <ul style="list-style-type: none"> • if optional words of the command have been omitted, then the command should be tried with these in place. • If a number of commands have been given in rapid succession resulting in the message 'COMMAND NOT RECOGNISED' to be displayed, then allow the system to recover (approximately one minute) before trying the command again. • If the system consistently fails to recognise commands, the voice training procedure should be carried out to improve the recognition response for the speaker. |

JaguarVoice

| Voice Command Group | Message | Meaning |
|-----------------------------|-----------------------------|---|
| Nametags (continued) | STORE FAILED | <p>Displayed when the voice system fails to store a nametag.</p> <p>Possible reasons could be that the nametag is too long or there is too much noise. Try the command again, If the error persists, try storing the nametag under quiet conditions such as with the vehicle parked and the windows closed.</p> |
| Phone | CONNECT PHONE TRY AGAIN | <p>If the portable is in its cradle but voice system keeps saying 'dial not accepted, please connect phone and try again', then the portable handset may not be correctly attached to its storage cradle. Try re-attaching the portable. If the problem persists, the phone may be incorrectly reporting its cradle status. Try powering the portable off and on to resolve the issue.</p> |
| Voice Training | SET HANDBRAKE TO CONTINUE | <p>This text message is displayed with its associated verbal feedback when the electronic parkbrake/handbrake is lifted/released during Voice Training. To continue voice training the brake must be re-applied.</p> |
| | VOICE TRAINING UNSUCCESSFUL | <p>This text message is displayed with its associated verbal feedback if the voice system could not save the training model recorded. If this problem occurs, please turn the ignition off, wait 5 seconds, and turn the ignition back on. Please check that there is no abnormal/excessive noise entering the vehicle interior and try running the Voice training procedure again. If the voice system continues to exhibit this error, consult you Retailer for assistance.</p> |

JaguarVoice

| Voice Command Group | Message | Meaning |
|---------------------|-----------------------------|--|
| Nametags | RADIO NOT IN TUNER MODE | Displayed when the user tries to store a radio nametag and the radio has not been placed in tuner mode, for example playing a tape or CD. |
| | NAMES TOO MUCH ALIKE | <ul style="list-style-type: none"> This response will be received when storing a nametag if the nametag being given has already been stored. This can be confirmed by giving the RADIO DIRECTORY or PHONE DIRECTORY command. If this response is received and the nametag has not been used already, then it is too similar to an existing nametag or voice grammar and an alternative should be used. |
| | SPOKE DURING LISTENING TONE | Displayed when user utters a radio or phone nametag while the beep is playing. Please wait for the end of the beep then say the nametag. |
| | DIRECTORY FULL | The user has tried to add a nametag to a directory that is full. The voice system can store up to 40 phone and 20 radio nametags. |
| | DIRECTORY EMPTY | Displayed when a RADIO DIRECTORY, PHONE DIRECTORY or VOICE DIRECTORY command is given and no nametags have been stored in the associated directory. |
| | NAMETAG TOO LONG | The nametag given is too short (so as not to mistake the nametag for inadvertent noise), If you experience this error please provide a longer nametag. |
| | STORE CANCELLED | Displayed and associated verbal response is provided when a nametag storage session is cancelled by the user. |

Index

| | |
|---|--|
| <p>Audio system care</p> <ul style="list-style-type: none"> cassettes 29 compact discs 29 radio 29 <p>Cassette tape player</p> <ul style="list-style-type: none"> change tape side 22 display panel 22 Dolby B 22 eject and tape-in indicator 22 fast forward and rewind 22 tape button 22 <p>Compact disc changer</p> <ul style="list-style-type: none"> CD check sequence 26 CD selection 27 CDC button 27 display panel 27 loading discs into the magazine 26 mix 27 operation 26 pause 28 repeat 28 seek up and down 27 <p>General information 13</p> <p>JaguarVoice</p> <ul style="list-style-type: none"> command confirmation 35 command list 38 how to say numbers 37 introduction 31 language and accent 31 nametags 36 operating tips 35 steering wheel voice switch 32 trouble-shooting error messages 45 useful notes 36 using the system 32 voice system prompts 35 volume level adjustment 36 <p>JaguarVoice training</p> <ul style="list-style-type: none"> training command list 44 training procedure 43 | <p>MiniDisc player</p> <ul style="list-style-type: none"> display panel 24 eject and CD-in indicator 24 MD button 24 mix 24 repeat 24 seek up and down 24 <p>Quick overview</p> <ul style="list-style-type: none"> cassette tape controls 5 CD changer magazine 10 compact disc controls 6 JaguarVoice - getting started 11 minidisc controls 7 minidisc operation 9 radio operation 9 single CD player operation 9 steering wheel controls 8 <p>Radio</p> <ul style="list-style-type: none"> auto memory 18 automatic volume control 15 band switch 17 change audio source 17 digital signal processing 15 display panel 14 mode button 15 mode level 1 15 mode level 2 16 ON/OFF and volume 14 presetting memorised stations 17 priority programme type (PPTY) 19 programme type (PTY) 19 RBDS 18 RBDS operation 19 RBDS trouble-shooting guide 21 reception 14 seek and manual tuning 18 setting the audio display clock 17 source tone memory 17 <p>Radio set up 25</p> |
|---|--|

Index

| | |
|-------------------------------------|----|
| Single CD player | |
| CD button | 23 |
| display panel | 23 |
| eject and CD-in indicator | 23 |
| mix. | 23 |
| repeat | 23 |
| seek up and down. | 23 |