

Jaguar X-Type EGR Valves etc.

This document is intended to provide users with information about the Exhaust Gas Recirculation (EGR) devices fitted to the X-Type Jaguar series.

There are a number of different versions of EGR and each is illustrated with part numbers.

In addition various EGR gaskets, blanking plates and by-pass devices are also shown. There is an extract from the Jaguar Electronic Parts Catalogue (JEPC) illustrating the relationship between and various components of an EGR system with their title.

Finally here are the wiring diagrams for later electronic and hybrid EGR valves (the earliest version was operated by vacuum only).

Connections on the left are to the Engine Control Module (ECM).

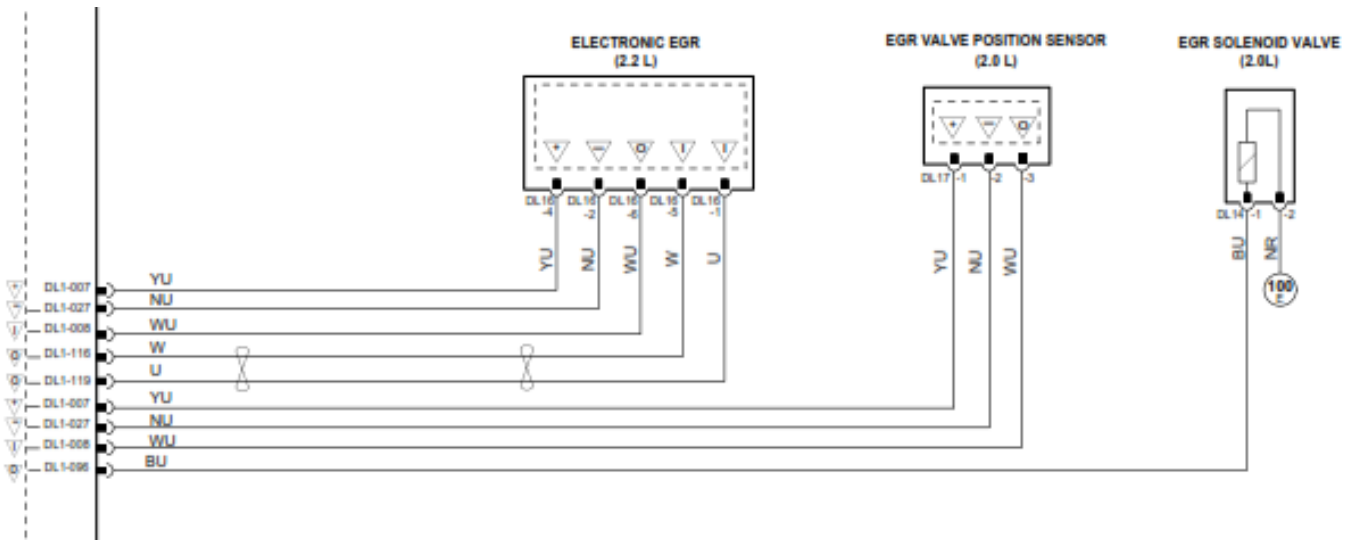

Key to Wiring Colours:

YU – Yellow / Blue

NU – Brown / Blue

WU – White / Blue

W - White

U - Blue

BU – Black / Blue

NR – Brown / Red

Other symbols:

100 E refers to engine power supply via Fuse 17 10A

O – Output signal from device

I - Input signal to device

Jaguar X-Type EGR Valves etc.

There are currently at least **4 types of EGR valve** fitted to the X-Type Diesel Engine – Vacuum vs Electronically operated (2.0D engines) and with/ without DPF system.(2.2D engines). Some versions are also common to Ford engines.



Jaguar X-type

EGR valve (with MAP Sensor)

Part No C2S51294

2.2 diesels with a DPF (diesel particulate filter)

All VINs (J04731 on)

2007 JAGUAR X-TYPE 2.0 DIESEL fitted with the 2.0 TD 130 bhp (N7BA) type engine.

The part numbers on the unit are: 024C06P

From VIN E46914

Part No JDE 7436(E)

(E = exchange)



Jaguar X-Type EGR Valves etc.



Jaguar X Type
(for vehicles with Vin numbers
from (V) E07105 to E46913)

**ECS 17 - Stage 3 - 2.0 Litre turbo
diesel**

Part number: C2S36575
JDE 7435(E) (E = exchange)
(May have 'Ford' Stamped on side
and 2S7Q-9D475-BC)

**Should fit the following listed
below but check the number on
your unit to ascertain that it is
correct**

Model	Engine	CC	KW	Type	Year
FORD MONDEO III (B5Y) 1996/09 - 2000/11					
MONDEO III (B5Y) 2.0 16V TDDi / TDCi	D6BA	1998	85	Hatchback	00.11 -
MONDEO III (B5Y) 2.0 TDCi		1998	96	Hatchback	01.10 -
MONDEO III (B5Y) 2.2 TDCi		2198	114	Hatchback	04.09 -
FORD MONDEO III Estate (BWY) 2000/11 - /					
MONDEO III Estate (BWY) 2.0 16V TDDi / TDCi	D6BA	1998	85	Estate	00.11 -
MONDEO III Estate (BWY) 2.0 TDCi		1998	96	Estate	01.10 -
MONDEO III Estate (BWY) 2.2 TDCi		2198	114	Estate	04.09 -
FORD MONDEO III Saloon (B4Y) 2000/11 - /					
MONDEO III Saloon (B4Y) 2.0 16V TDDi / TDCi	D6BA	1998	85	Saloon	00.11 -
MONDEO III Saloon (B4Y) 2.0 TDCi		1998	96	Saloon	01.10 -
MONDEO III Saloon (B4Y) 2.2 TDCi		2198	114	Saloon	04.09 -
FORD TRANSIT Box (FA_Y) 2000/01 - /					
TRANSIT Box (FA_ _) 2.4 TDCi		2402	101	Box	04.03 -
FORD TRANSIT Bus (FD_ _, FB_ _, FS_ _, FZ_ _, FC_ _) 2000/01 - /					
TRANSIT Bus (FD_ _, FB_ _, FS_ _, FZ_ _, FC_ _) 2.4 TDCi		2402	101	Bus	04.03 -
FORD TRANSIT Flatbed/Chassis (FM_Y, FN_Y) 2000/01 - /					
TRANSIT Flatbed / Chassis (FM_ _, FN_ _) 2.4 TDCi		2402	101	Flatbed / Chassis	04.03 -

Jaguar X-Type EGR Valves etc.



Electronically Operated (Stepper Motor) - Euro IV - Non-DPF

(as fitted to my 08MY 2.2D and featured in cleaning notes)

All VINs (E73994 on)

Extract from Jaguar Parts Catalogue - showing EGR System Components:

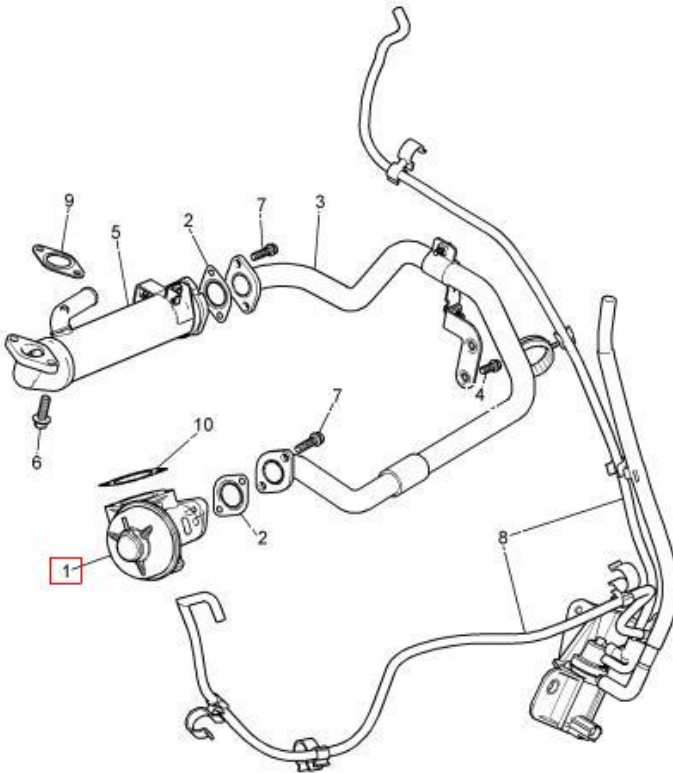

No		Description
1	+	Exhaust gas recirculation valve
2	+	Gasket
3	+	Exhaust gas recirculation pipe
4	+	Bolt
5	+	Exhaust gas recirculation cooler
6	+	Bolt
7	+	Bolt
8	+	Air pipe and bracket
9	+	Exhaust gas recirculation pipe gasket
10	+	Exhaust gas recirculation valve gasket

WB10343H

Jaguar X-Type EGR Valves etc.

Blanking Plates and Gaskets for EGR



EGR Gasket:

X Type EGR Valve & EGR Cooler Gasket.
Jaguar Part No JDE 1827



EGR Blanking Plate (Non Euro IV EGRs)

[Can also be used on later EGRs but needs
8mm 'breather' hole to fool MAF sensor]



EGR Blanking Plate (Euro IV EGRs)

[Note 8mm breather hole to fool MAF Sensor
- without which an Engine Management
Fault Light will come on]



EGR Bypass Valve Kit

Blocks all exhaust returns and
takes EGR valve out of system
completely. (Only suitable for
early non-Euro IV [non-
electronic] EGR types)
otherwise an EML will be
caused.