

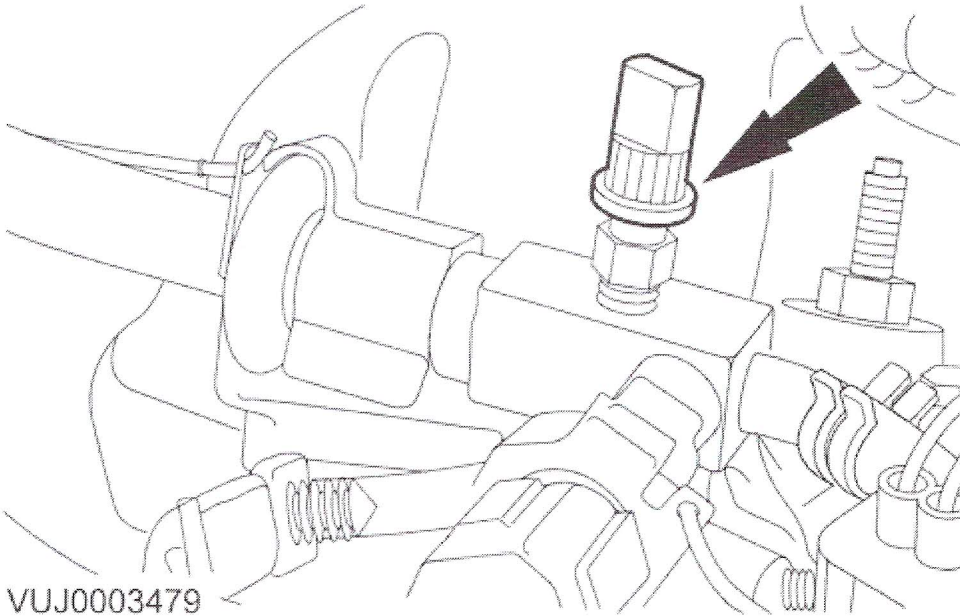

WARNING:

AFTER CARRYING OUT REPAIRS, THE FUEL SYSTEM MUST BE CHECKED VISUALLY FOR LEAKS. FAILURE TO FOLLOW THIS INSTRUCTION MAY RESULT IN PERSONAL INJURY.

Disconnect the battery ground cable. For additional information, refer to <<414-01>>.



2. Remove the schraeder valve cap.

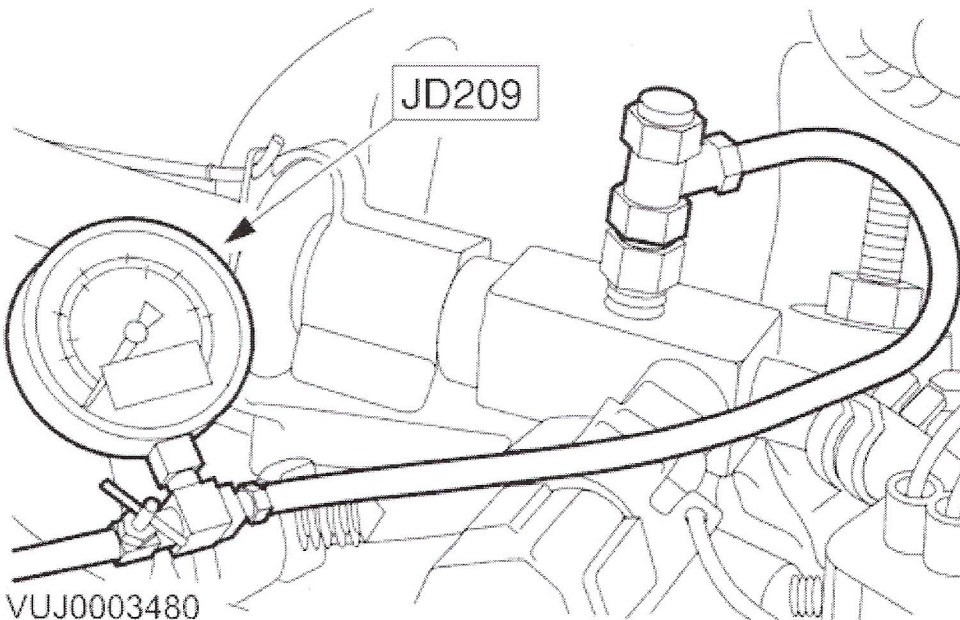

WARNING:

MAKE SURE THAT THE TAP IS TURNED FULLY CLOCKWISE BEFORE FITTING THE FUEL PRESSURE GAUGE TO THE SCHRAEDER VALVE. FAILURE TO FOLLOW THESE