

PUBLISHED: 18-NOV-2013
2017.0 XE (X760), 303-12C

INTAKE AIR DISTRIBUTION AND FILTERING - V6 S/C 3.0L PETROL
SUPERCHARGER SPRING ISOLATOR [G1702590]

REMOVAL

⚠ CAUTION:

Make sure that all open ports are covered to prevent any foreign material ingress.

△ NOTE:

Some variation in the illustrations may occur, but the essential information is always correct.

1.

⚠ WARNING:

Make sure to support the vehicle with axle stands.

Raise and support the vehicle.

2. Refer to: [Supercharger](#) (303-12C Intake Air Distribution and Filtering - V6 S/C 3.0L Petrol, Removal and Installation).

3.

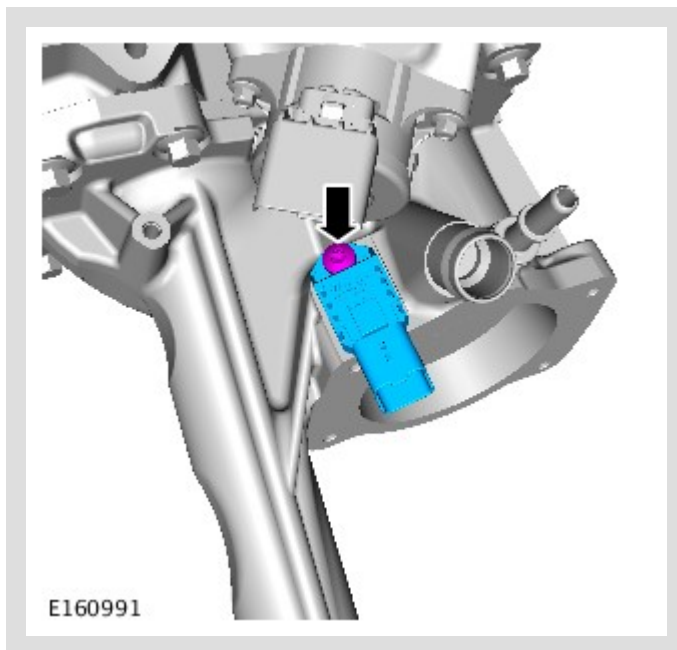

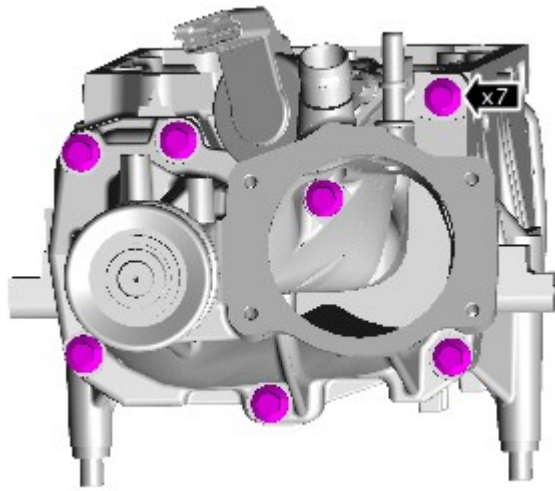

E161284

5.

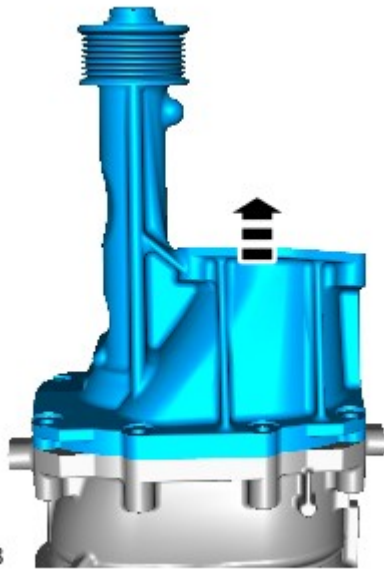

E160993

 CAUTION:

Make sure that all open ports are covered to prevent any foreign material ingress.

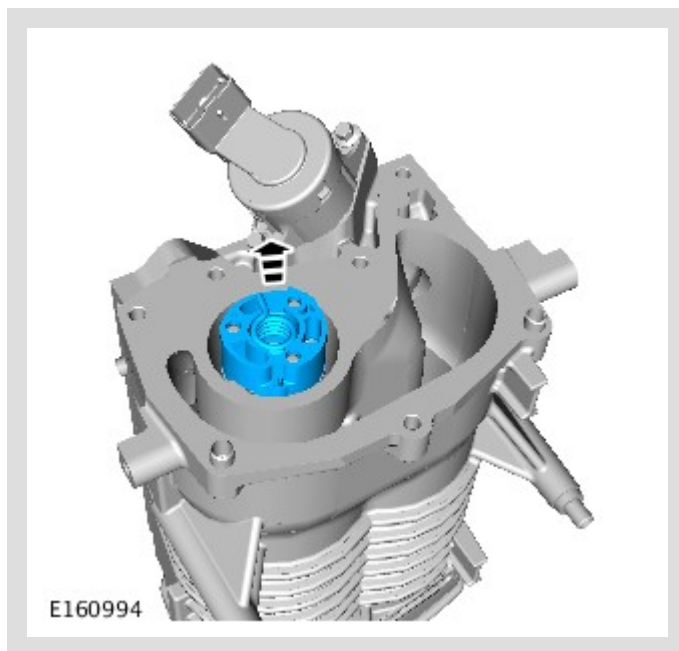

7.

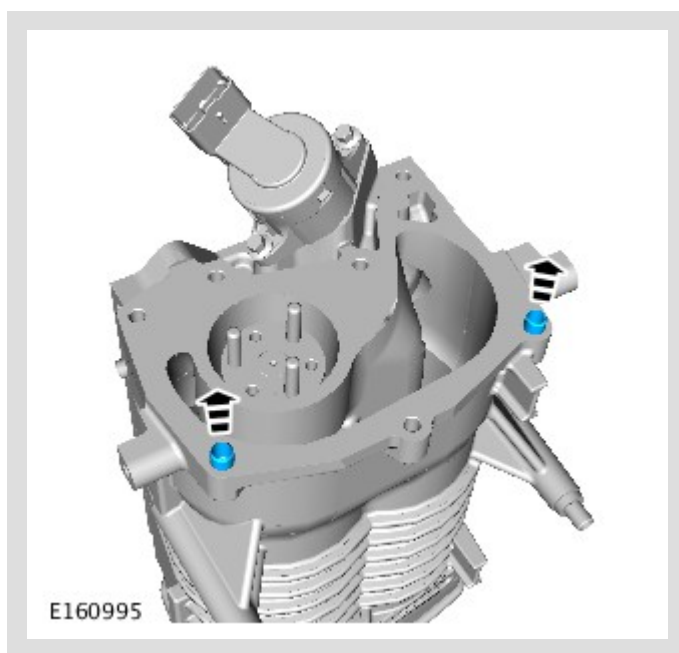

⚠ CAUTION:

Make sure that all open ports are covered to prevent any foreign material ingress.

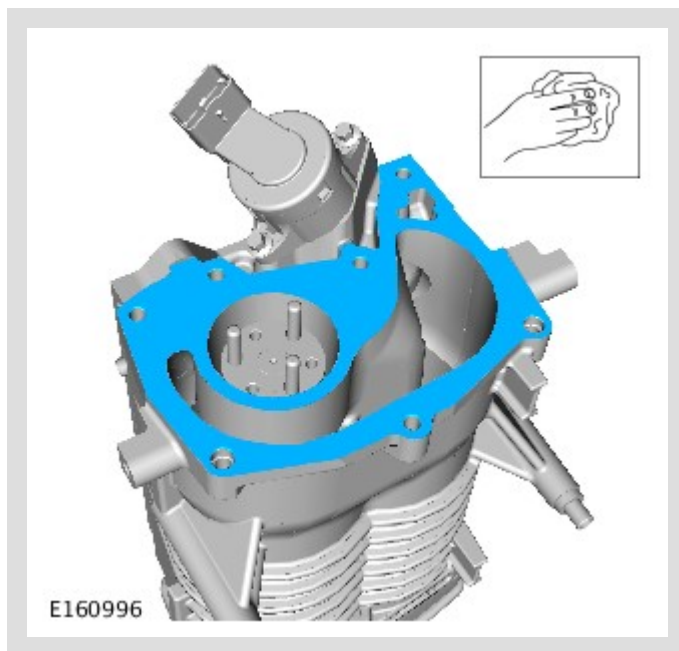

1.

⚠ CAUTION:

Make sure that all open ports are covered to prevent any foreign material ingress.

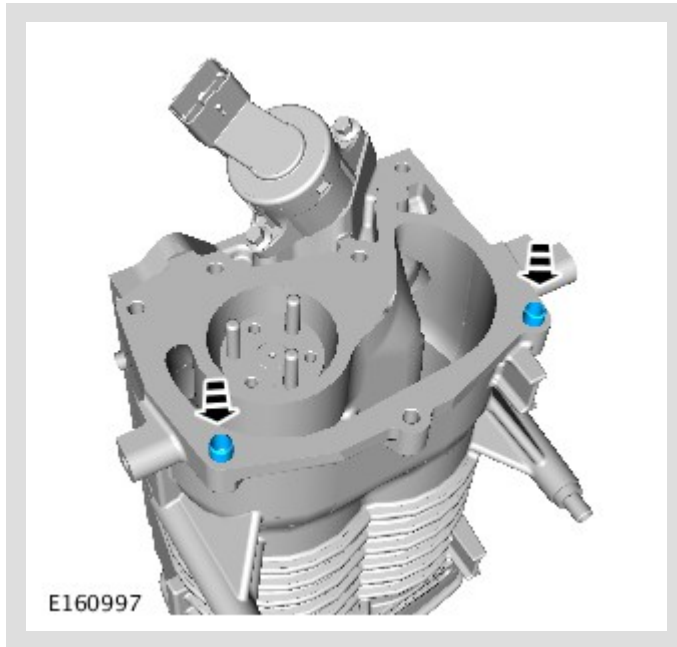

2.

⚠ CAUTION:

Apply a continuous bead of gasket sealant as shown on the illustration. The application of the sealant must be 1mm diameter. Install the component immediately after applying the sealant without smearing the sealant.

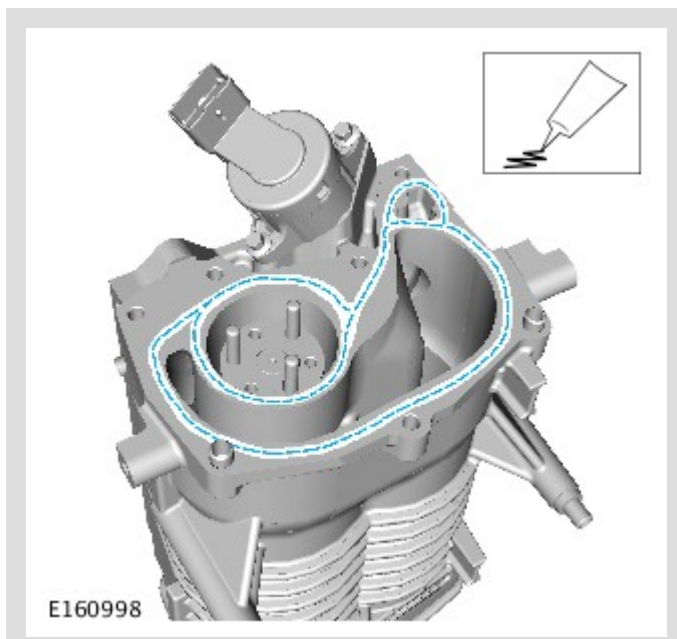

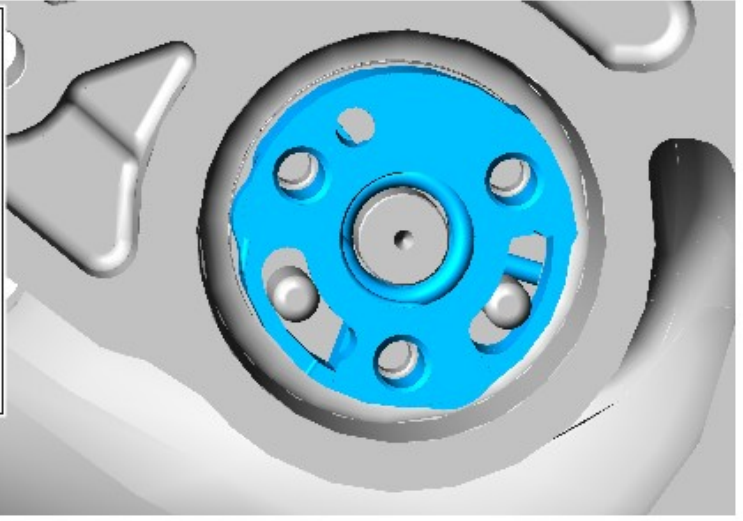
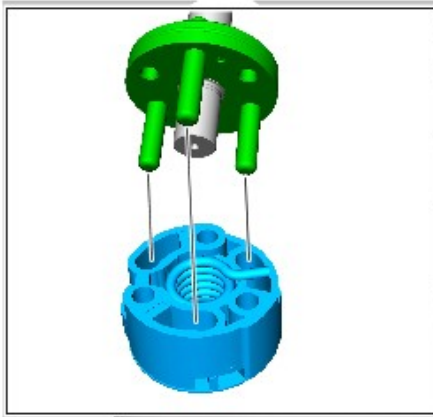

E160999

4.

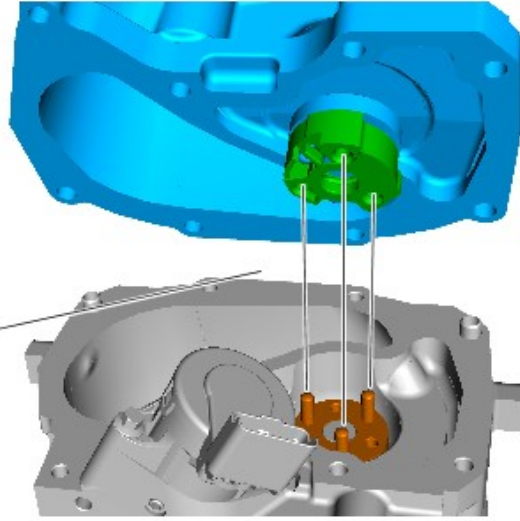
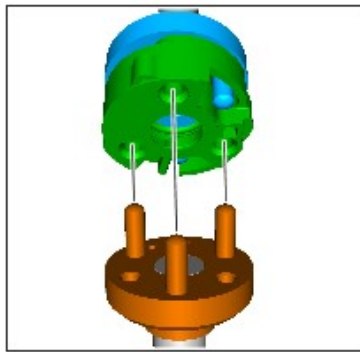

E161000

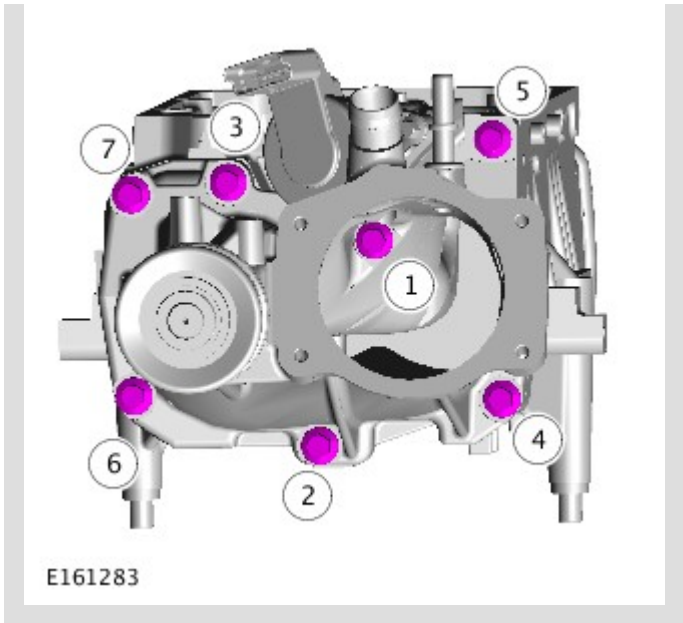

Torque: **27Nm**

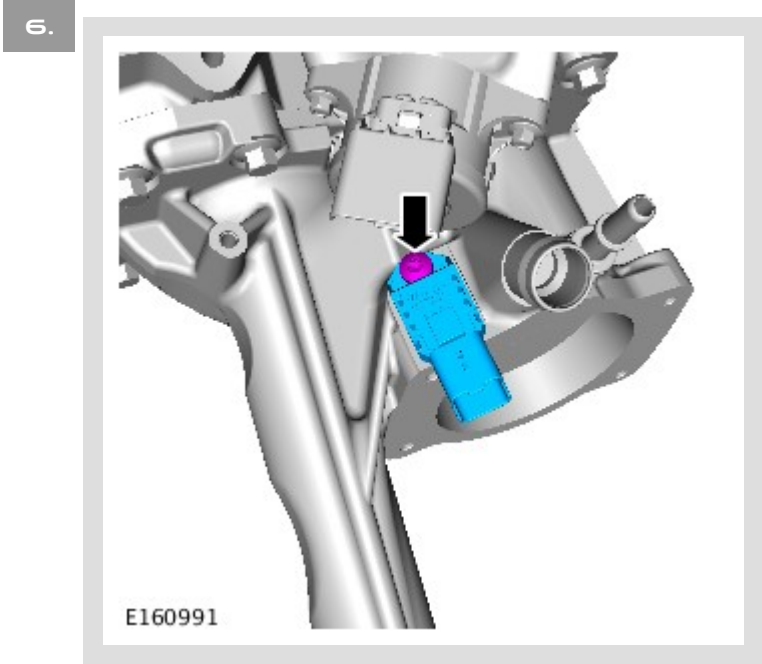

Torque: **5Nm**

⚠ CAUTIONS:

- Make sure that spring resistance is felt in both directions of the pulley as shown.
- Make sure that all open ports are covered to prevent any foreign material ingress.

⚠ NOTE:

Supercharger rotors will appear polished, this is normal

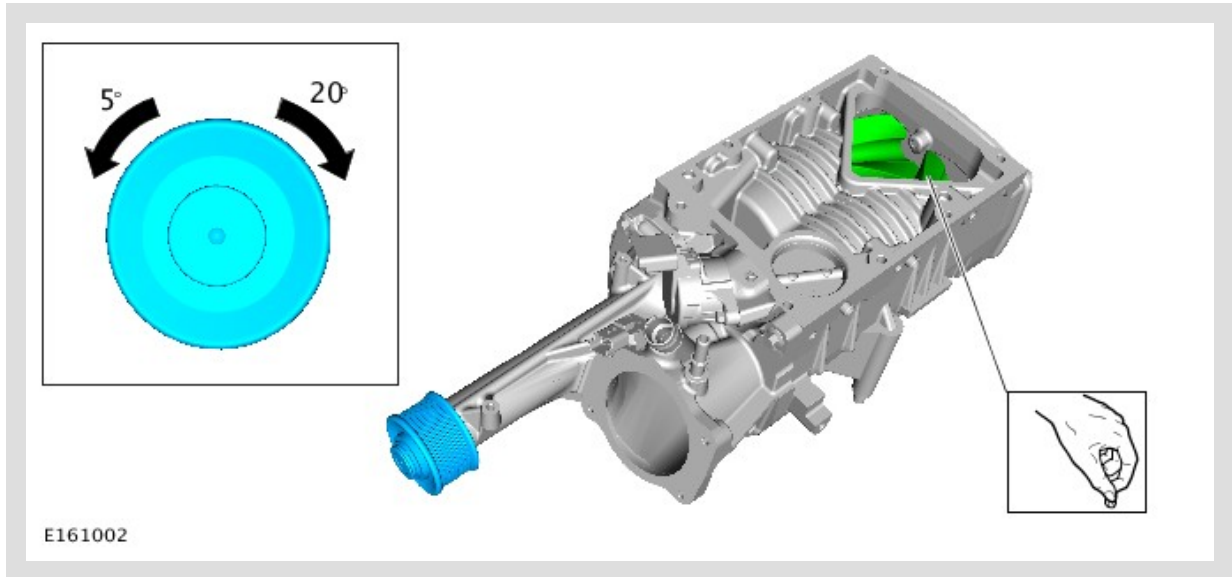

8. Refer to: [Supercharger](#) (303-12C Intake Air Distribution and Filtering - V6 S/C 3.0L Petrol, Removal and Installation).