

Published: 11-May-2011

Handles, Locks, Latches and Entry Systems - Exterior Front Door Handle

Removal and Installation

Removal

 NOTE: Removal steps in this procedure may contain installation details.

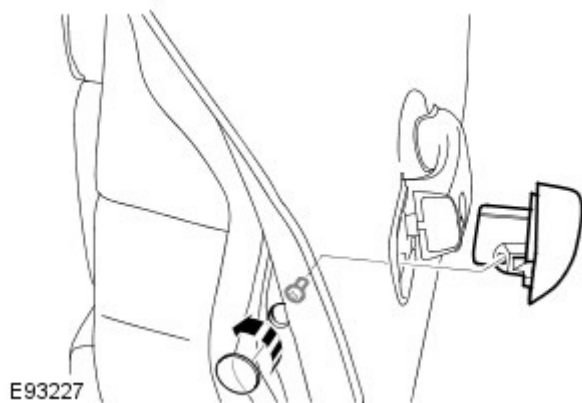

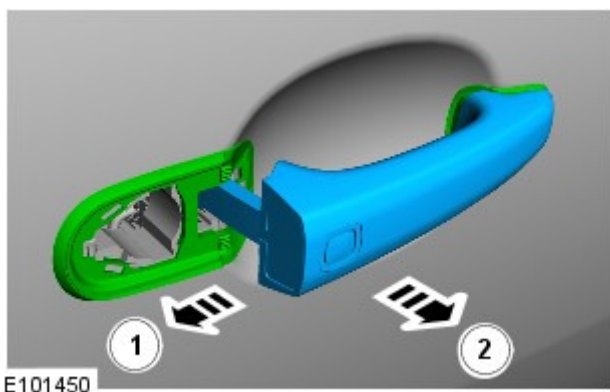

1.  NOTE: Remove the screw sufficiently, only to release the component.

Torque: 4 Nm



2.  NOTE: Some variation in the illustrations may occur, but the essential information is always correct.

3.  CAUTION: Take extra care not to damage the wiring harnesses.

 NOTE: Secure the connection in the service position.

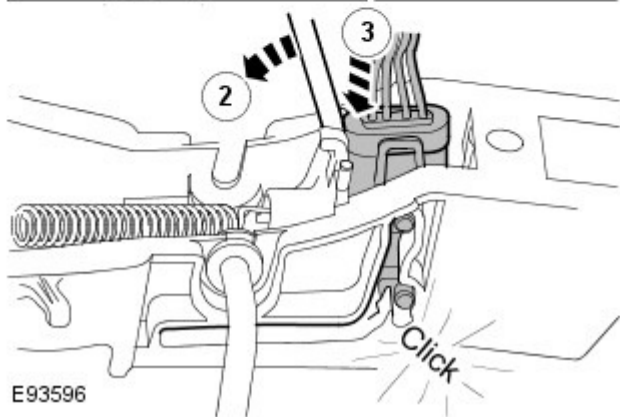
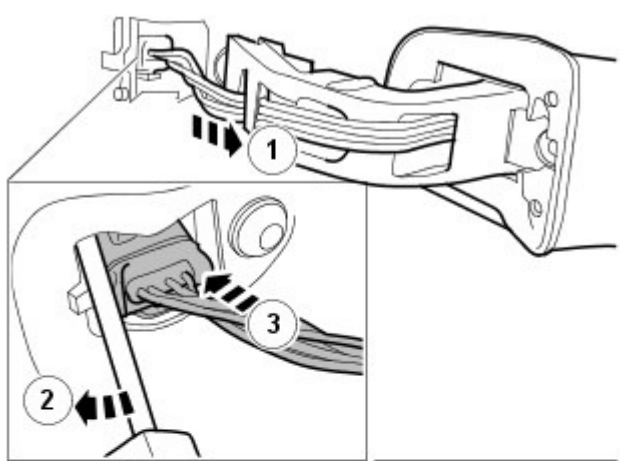

E93596

4.

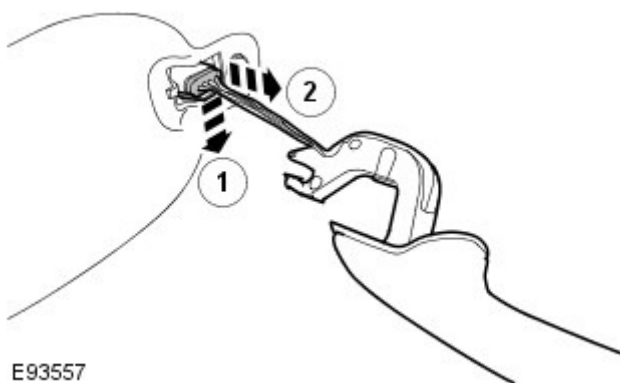

E93557

Installation

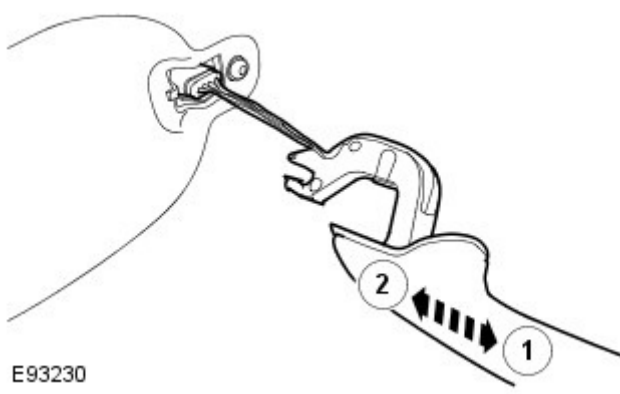

E93230

1.  CAUTION: Make sure that the wiring harnesses are correctly located.

To install, reverse the removal procedure.

