

EXTERIOR FRONT DOOR HANDLE (G1267533)

REMOVAL AND INSTALLATION

76.58.01

FRONT DOOR
HANDLE - RENEW

ALL DERIVATIVES

0.10

USED WITHINS

REMOVAL

NOTES:

- Removal steps in this procedure may contain installation details.
- Some variation in the illustrations may occur, but the essential information is always correct.

1.

NOTE:

Remove the screw sufficiently, only to release the component.

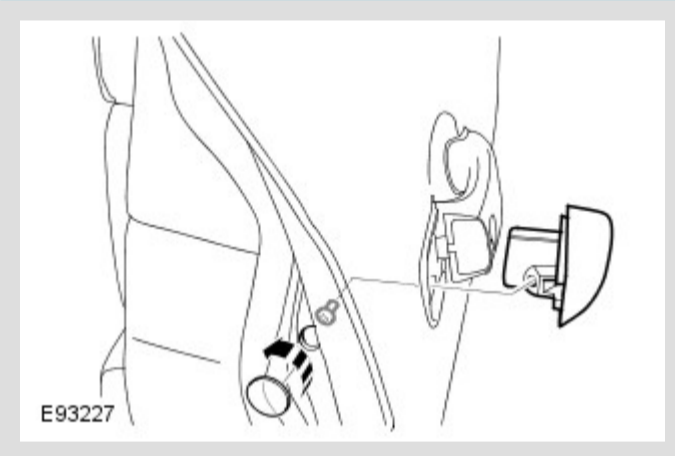

Torque: 4 Nm

2.

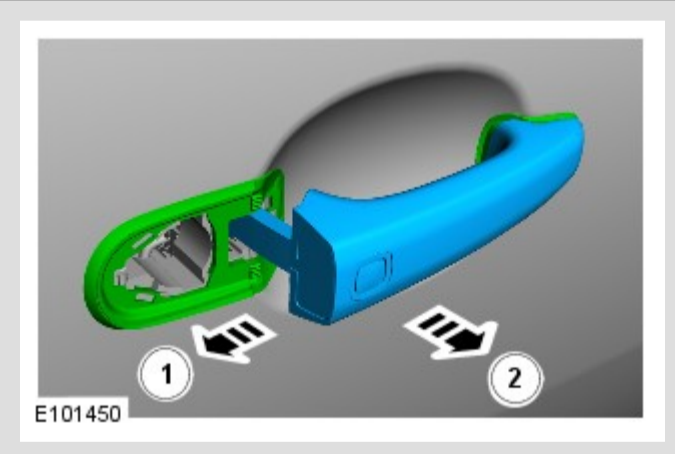

⚠ CAUTION:

Take extra care not to damage the wiring harnesses.

△ NOTE:

Secure the connection in the service position.

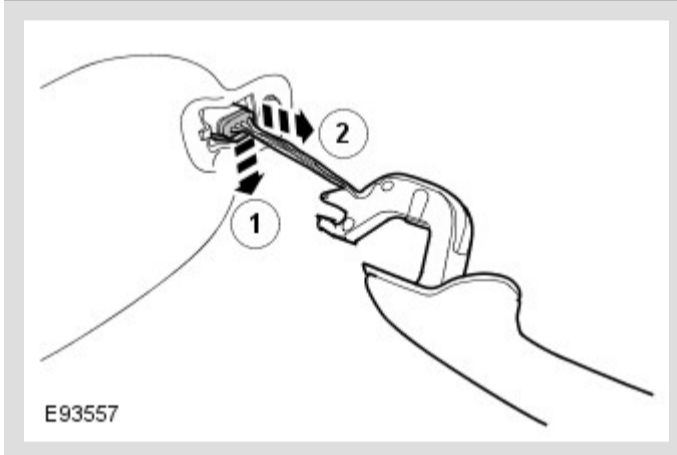
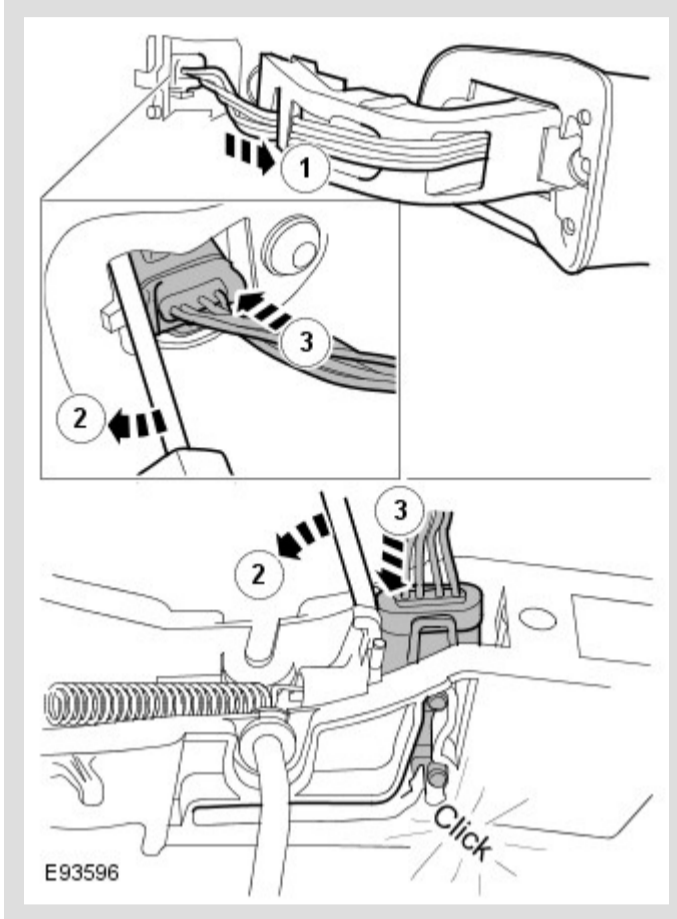

INSTALLATION

⚠ CAUTION:

Make sure that the wiring harnesses are correctly located.

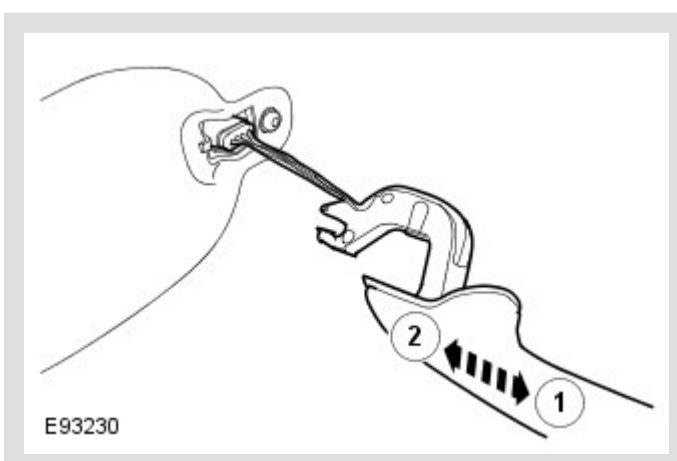

To install, reverse the removal procedure.

