

**Transmission - Installation 44.20.01**

**Special Service tools**

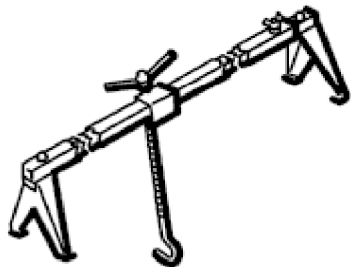

E36400

Engine support  
303-021

---

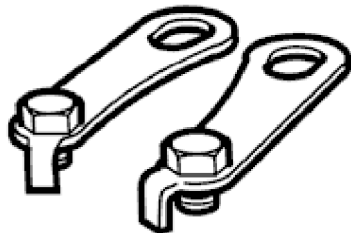

E36403

Engine lifting brackets  
303-536

---

**Installation**

- 1. Clean all mating faces and relevant parts.

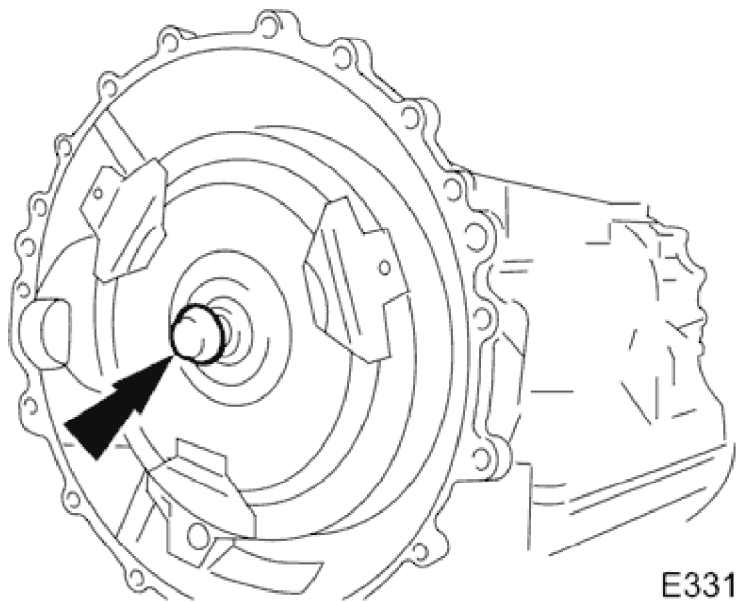

E33130

2. Apply lubricant, Molycote or equivalent, to the spigot of the torque converter.

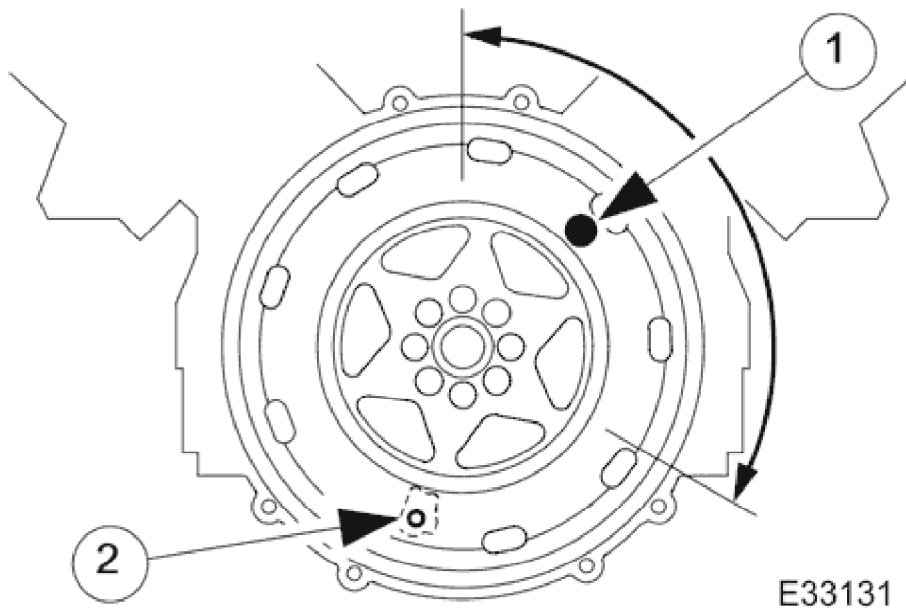

E33131

3. Align the engine drive plate.

1. Rotate the crankshaft to position the ORANGE dot within the indicated sector.

**NOTE:**

Viewed from the rear of the vehicle.

2. Keeping the dot within the sector, align the nearest converter fixing hole to the access aperture.

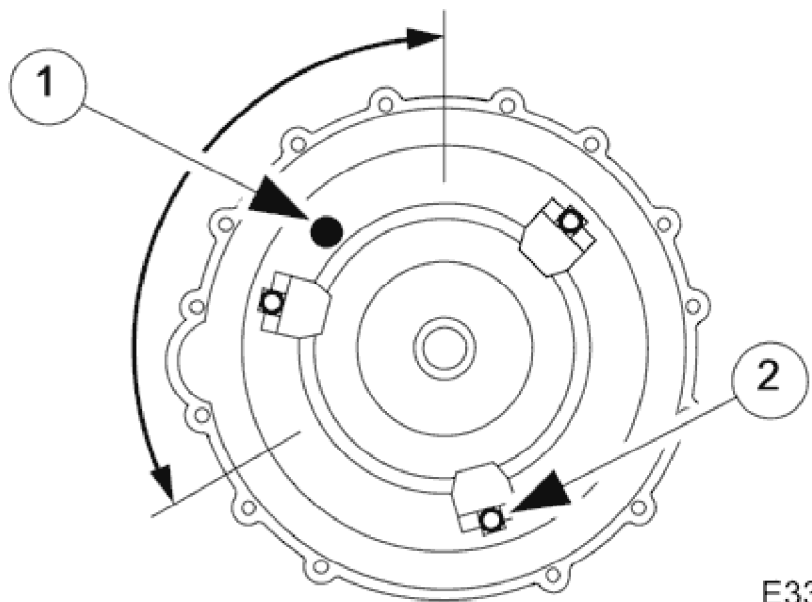

E33132

4. Align the torque converter
- 1. Rotate the converter to position the BLUE dot within the indicated sector.
  - 2. Keeping the dot within the sector, align the nearest fixing boss as indicated, so that when the two units are mated, the converter need only be moved the minimum amount.

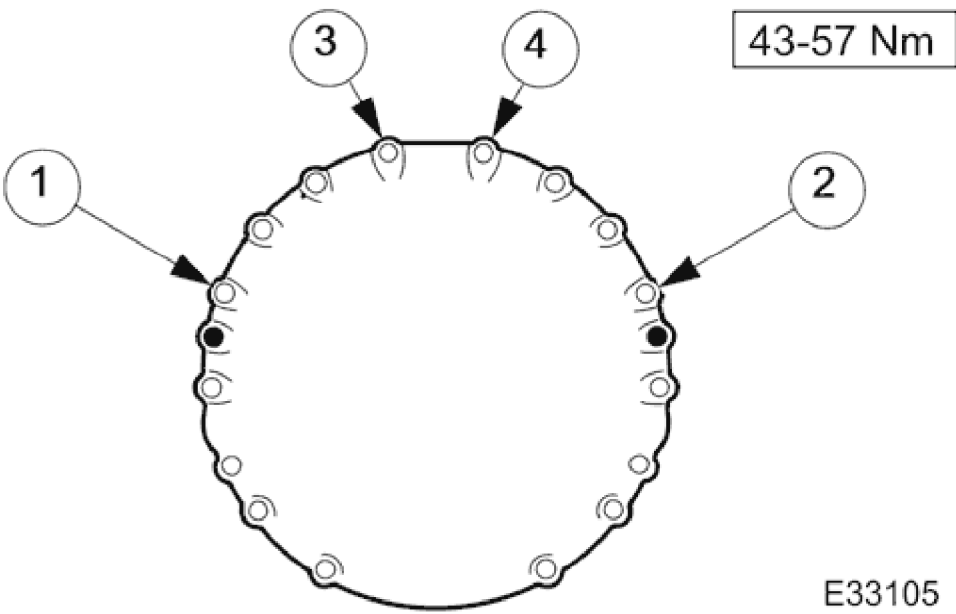

E33105

5. Fit the transmission to the engine.
- Loosely assemble - Cooler pipe clip.
  - Loosely assemble - Ground lead.
  - Loosely assemble - Catalyst brackets.
  - 1. Tighten in sequence 1, 2, 3, 4 as shown on the illustration, then the others in any order.

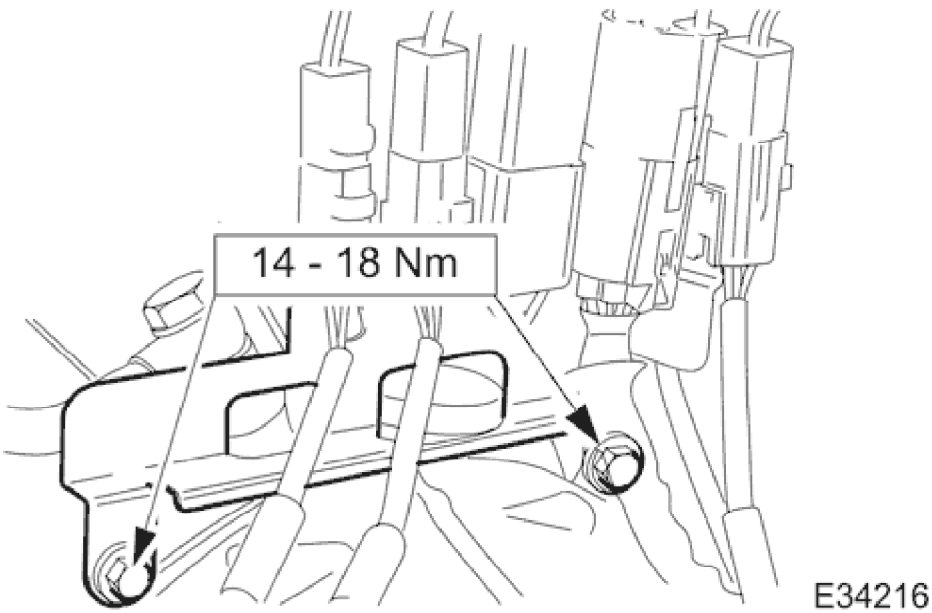

6. Reposition the mounting bracket for the engine harness connector and fit the securing bolts.

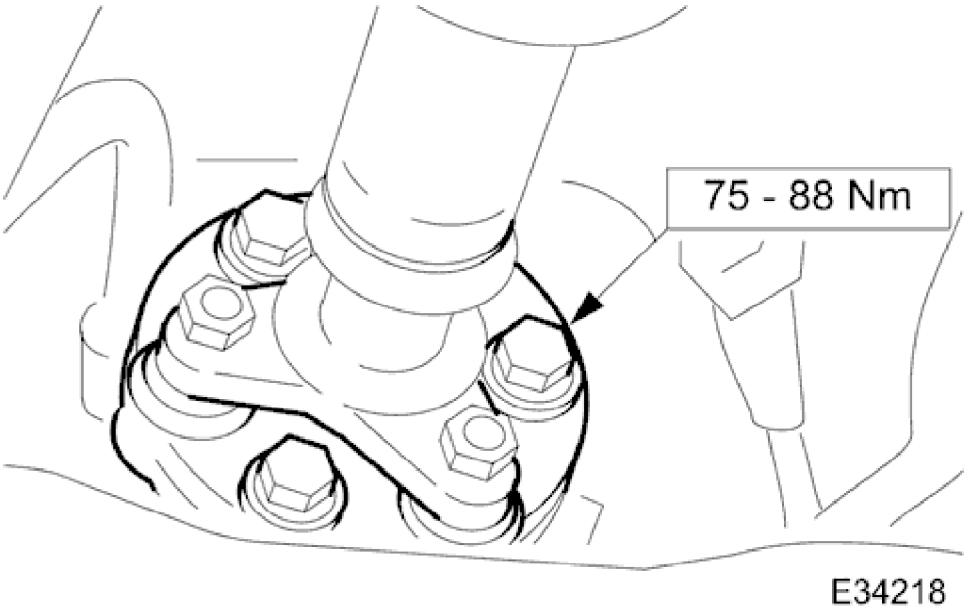

7. Connect the drive shaft, aligning any marks made when removing - if applicable. Tighten the bolts to the specified torque figure.

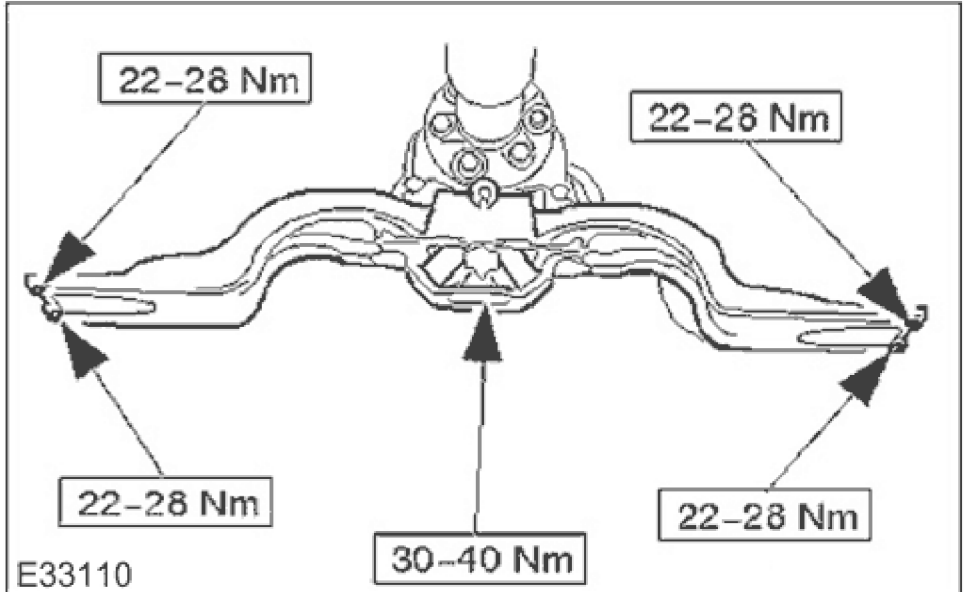

8. Fit the engine rear mounting and tighten the centre bolt and outer bolts to the specified torque figures.
- Check that the hooks of the engine support beam are not trapped, before tightening the rear mounting.
  - Check that the safety chain on the transmission jack will not be trapped when the mounting is fitted.

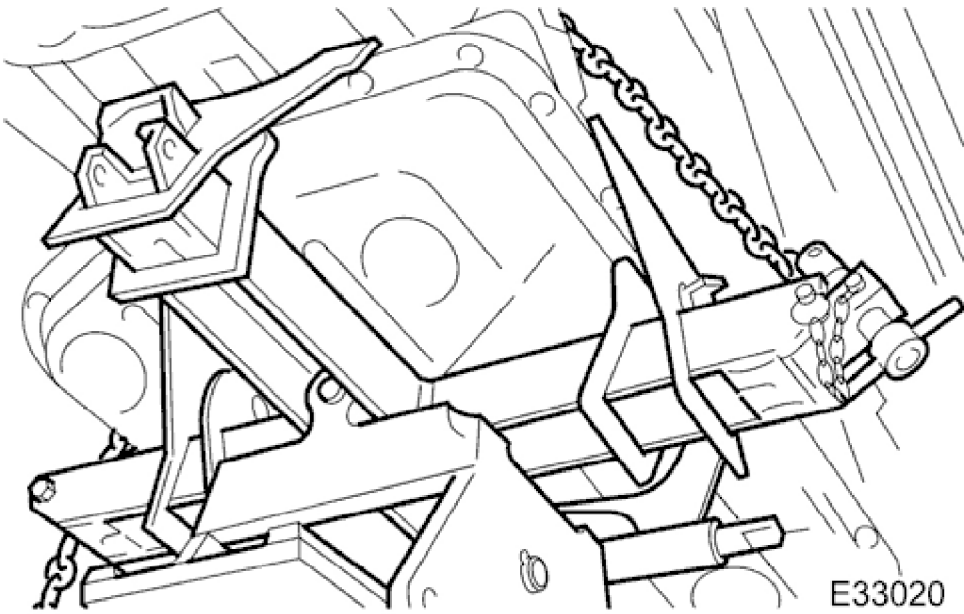

9. Remove the transmission jack.

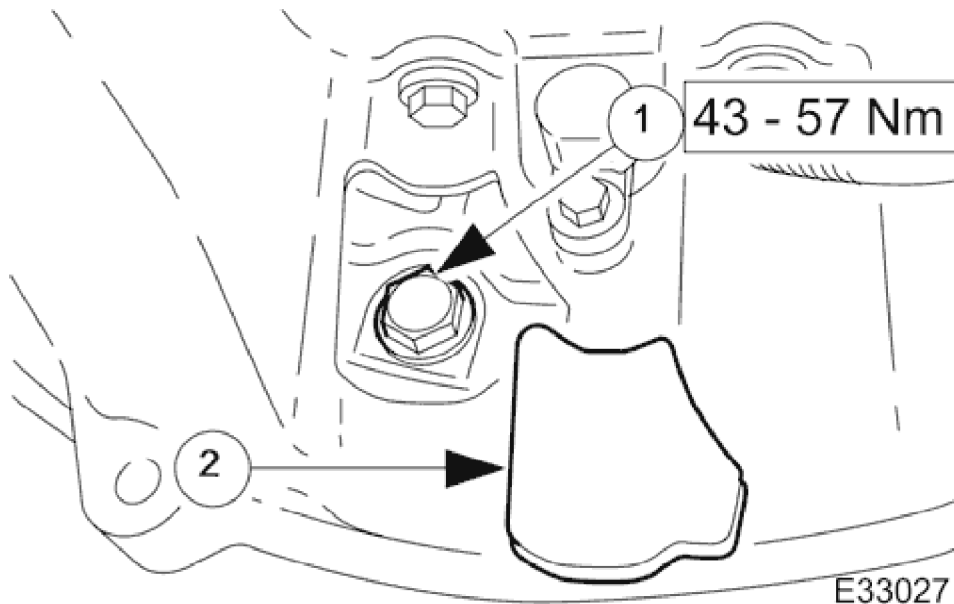

10. Fit the three bolts which secure the torque converter to the drive plate.
  1. Loosely assemble all three drive plate to torque converter bolts. Whilst preventing crankshaft rotation, tighten the three converter bolts to the specified torque figure.
  2. Fit the blanking plug.

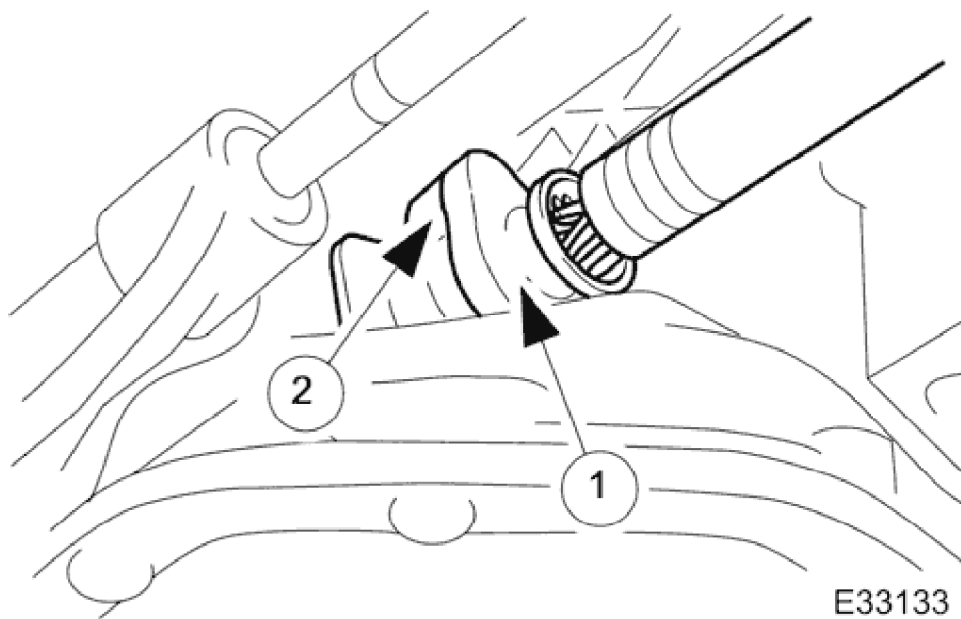

11. Connect the transmission harness multiplug.
  1. Engage the multiplug.
  2. Rotate the locking lever to secure.

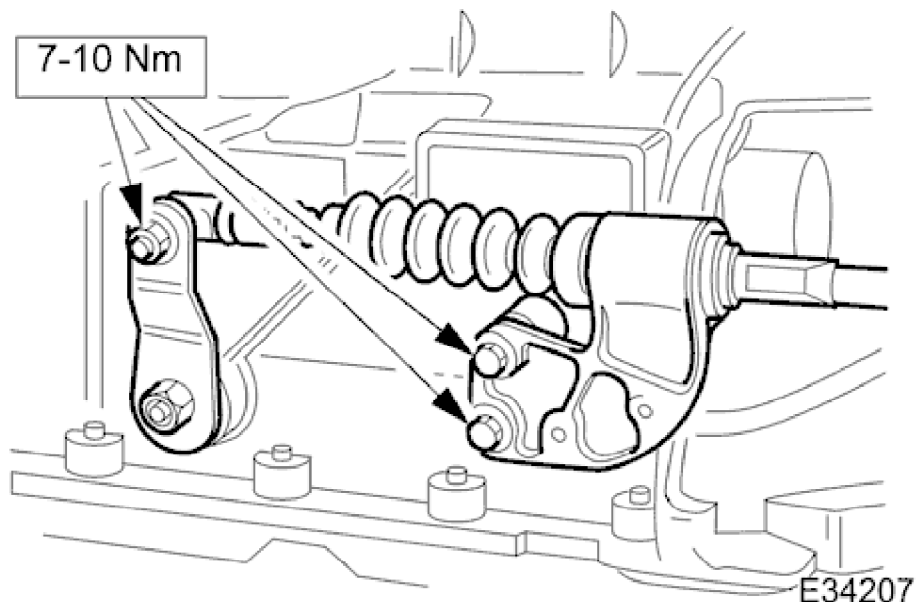

12. Connect the selector cable to the selector lever and fit the abutment bracket to the transmission casing. Tighten the nut and two bolts to the specified torque figure.

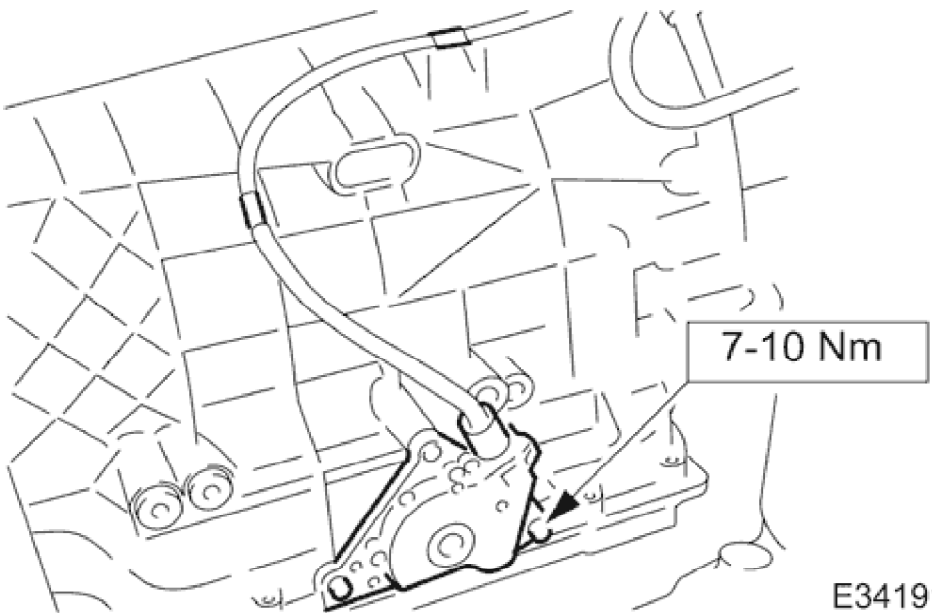

13. Refit the rotary switch and tighten the two screws to the specified torque figure. Locate the switch harness into the clips.

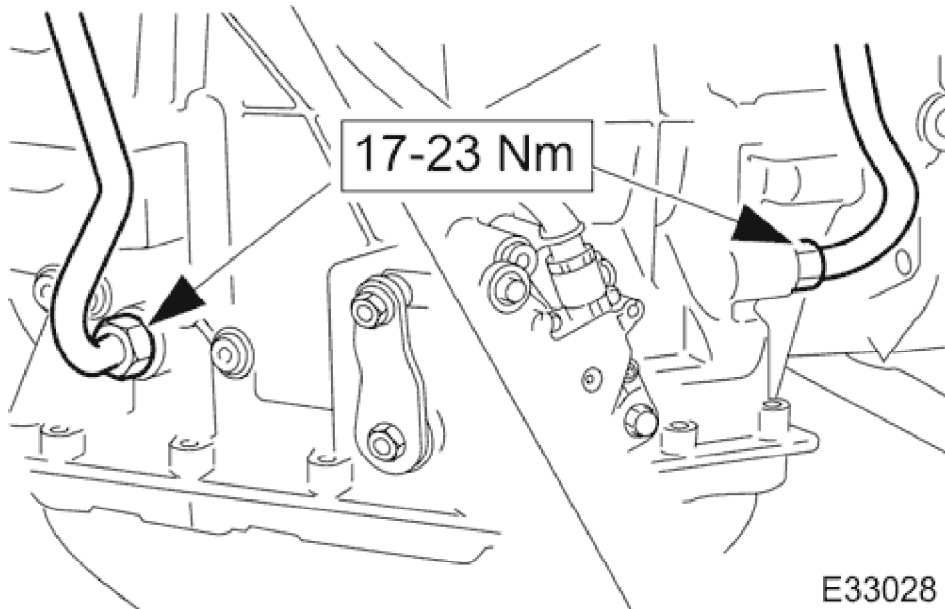

14. Connect the fluid cooler pipes to the transmission.
- Remove the blanking plugs.
  - Fit new O-ring seals.
  - Tighten the union nuts to the specified torque figure.

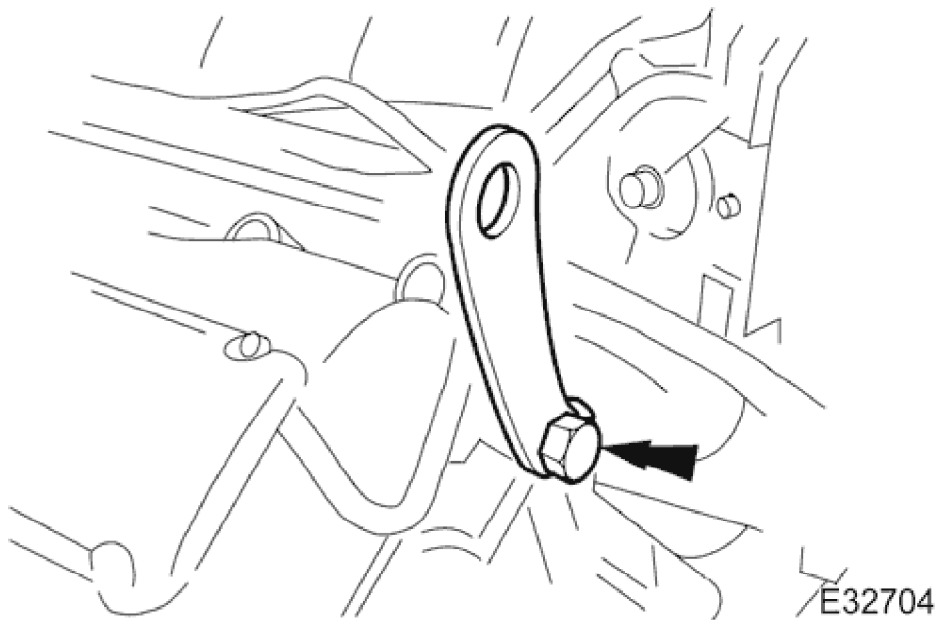

15. Remove the engine support beam.
- Remove both engine lifting brackets 303 - 536.

16. Refit the RH downpipe catalytic converter. Refer to Operation 17.50.09 and 17.50.10

17. Refit the front muffler. Refer to Operation <<30.10.18>>.



18. Refit the LH downpipe catalytic converter. Refer to Operation 17.50.09

19. Lower the vehicle on the ramp.

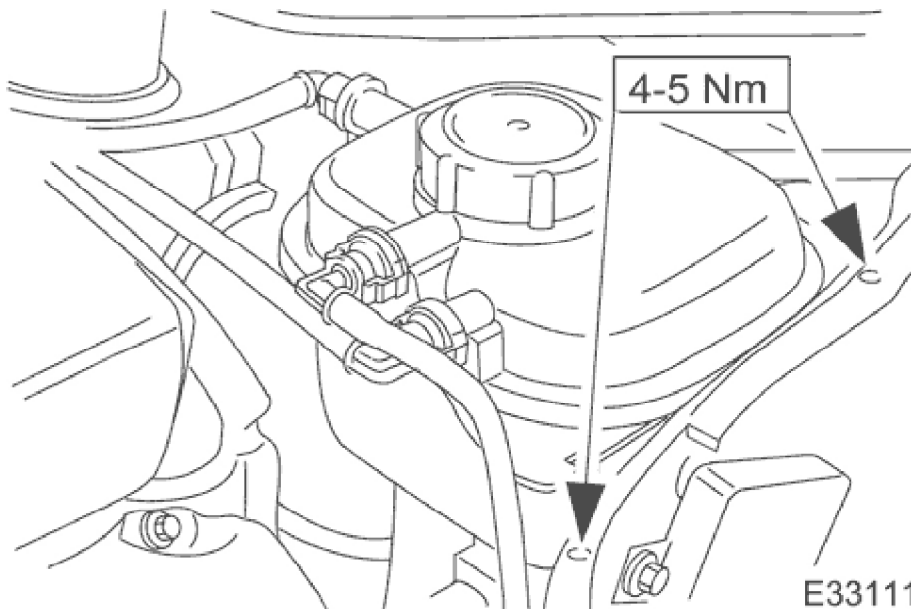

20. Reposition the coolant header tank and tighten the securing bolt to the specified torque figure.

21. Refit the air intake tube, MAFM and air cleaner cover assembly. Refer to Operation 19.10.30.

22. Refit the engine covers. refer to operation 12.30.06.

23. Connect the battery and fit the battery cover..

- Reset the radio and the clock.

24. Refill the transmission with new fluid. Refer to Operation <<44.24.02>>.

25. Remove the protection sheets and close the engine compartment.