

Windshield Wiper/Washer Switch 86.65.42

Removal

1. Ensure that steering wheel is in the straight ahead, fully lowered and fully extended position.
2. Remove battery cover and disconnect ground cable from battery terminal. Refer to <<86.15.19>>.

3.  **WARNING:**
FOLLOWING DISCONNECTION OF THE BATTERY, A PERIOD OF AT LEAST ONE MINUTE MUST BE ALLOWED TO ELAPSE BEFORE ANY WORK IS CARRIED OUT ON AN AIR BAG MODULE.

 **WARNING:**
FOLLOWING TEN YEARS IN SERVICE, AN AIR BAG MODULE MUST BE REMOVED AND DISPOSED OF IN THE APPROVED MANNER, AND A NEW AIR BAG MUST BE FITTED.

 **WARNING:**
AIR BAGS CONTAIN A CHEMICAL IRRITANT. IF AN AIR BAG IS RENEWED, THE ORIGINAL UNIT MUST BE DISPOSED OF IN ACCORDANCE WITH CURRENT SAFETY PROCEDURES.

 **WARNING:**
IN THE EVENT OF A FAULT RUPTURING THE 10A BATTERY SUPPLY FUSE (F4 LOCATED IN THE FUSE-BOX AT THE DRIVER'S END OF THE FASCIA), THE FUSE MUST NOT BE RENEWED UNTIL THE AIRBAG/SRS SYSTEM HAS BEEN DE-ACTIVATED. FUSES OF ANY OTHER VALUE MUST NEVER BE USED, AS THIS CAN CAUSE DISARM FAILURE.

Remove driver airbag. Refer to <<76.73.39>>.

4. Remove steering wheel.
5. Remove steering column lower cowl. Refer to <<76.46.03>>.
6. Remove steering column upper cowl. Refer to <<76.46.02>>.
7. Remove driver side underscuttle. Refer to <<76.46.11>>.

1999 XJ RANGE - Wipers and Washers - 501-16

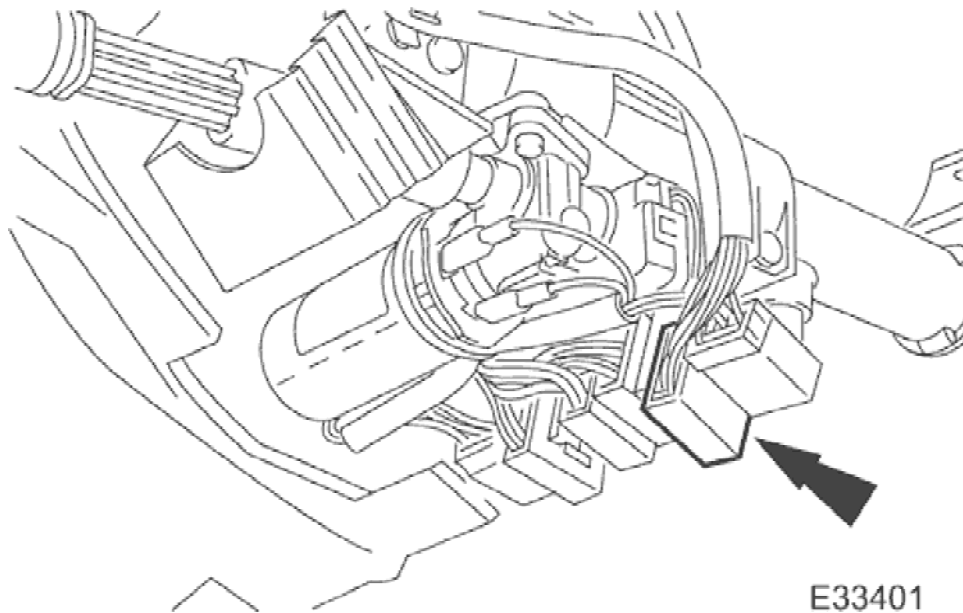

8. Release wipe/washer switch multiplug from retaining bracket and disconnect multiplug.

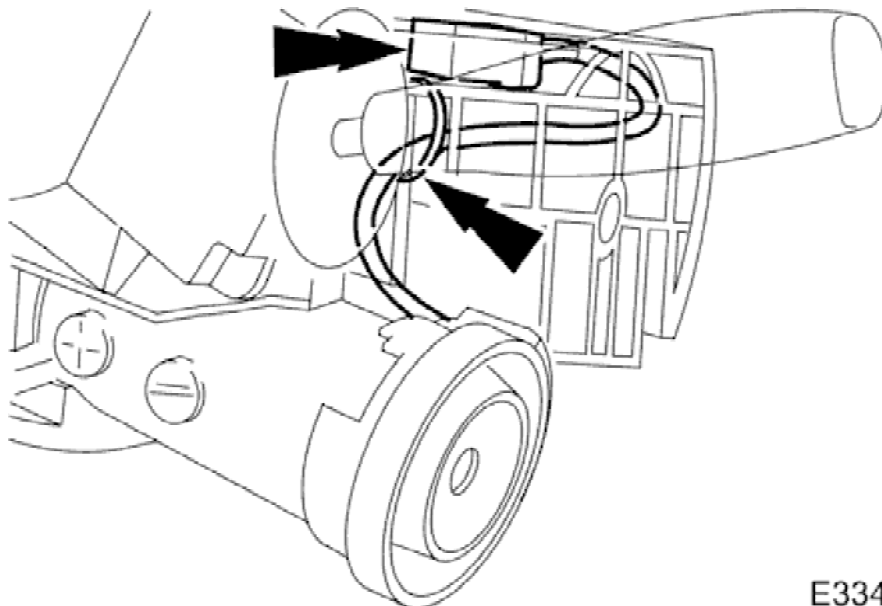

9. Sever and discard tie straps securing key transponder exciter coil multiplug to harness and disconnect multiplug.

1999 XJ RANGE - Wipers and Washers - 501-16

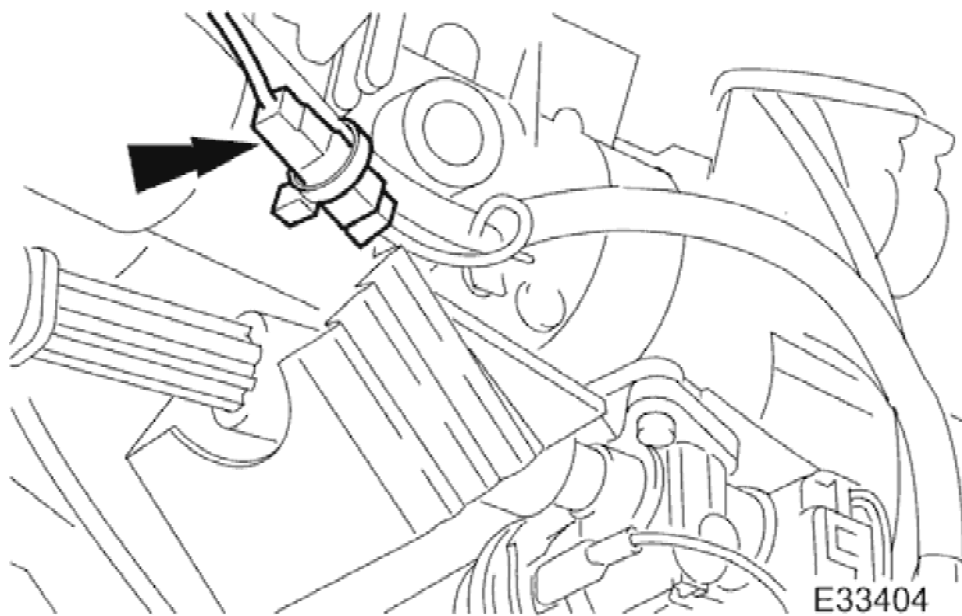

10. Disconnect key interlock solenoid harness multiplug.

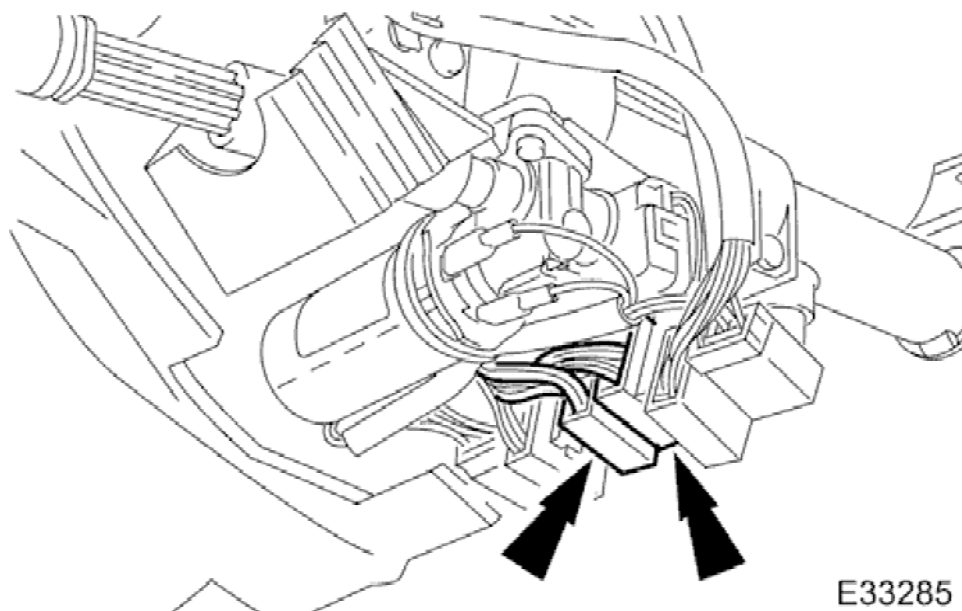

11. Release flasher/lamp/trip switch harness multiplugs from retaining bracket and disconnect multiplugs.

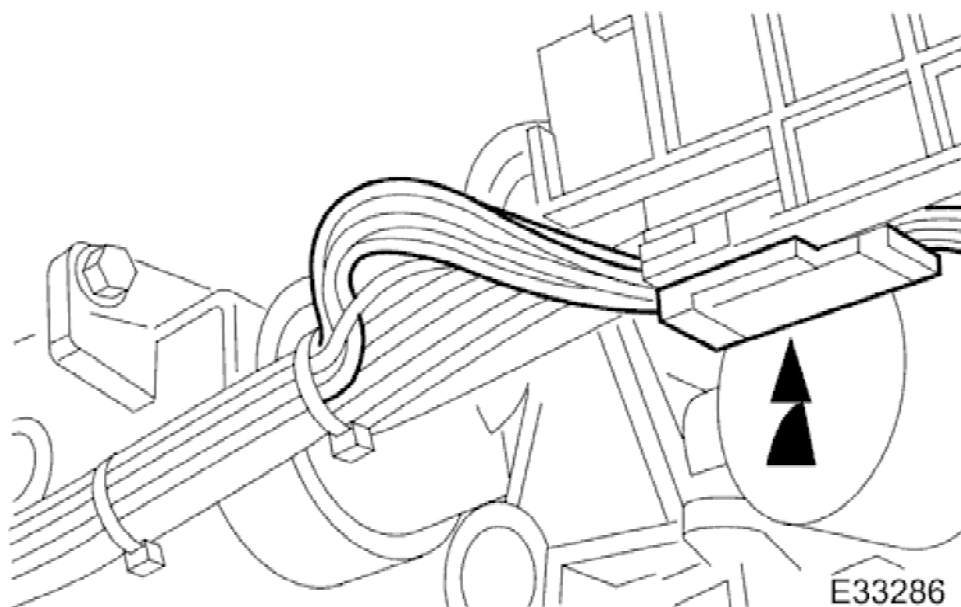

12. Disconnect cancellation module harness multiplugs.

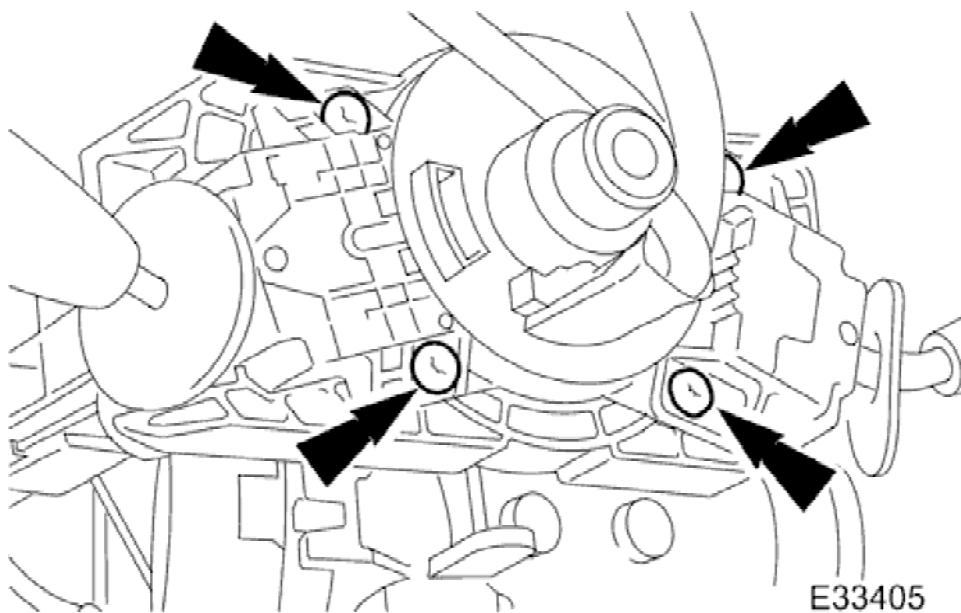

13. Slacken and remove bolts securing switch assemblies/cancellation module to column.

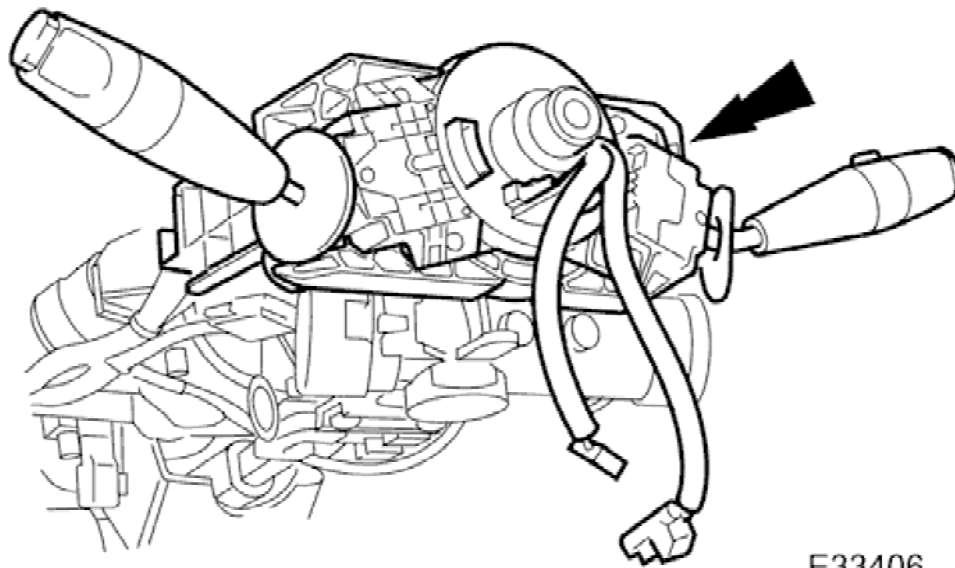

14. Remove steering column switchgear assembly for access.

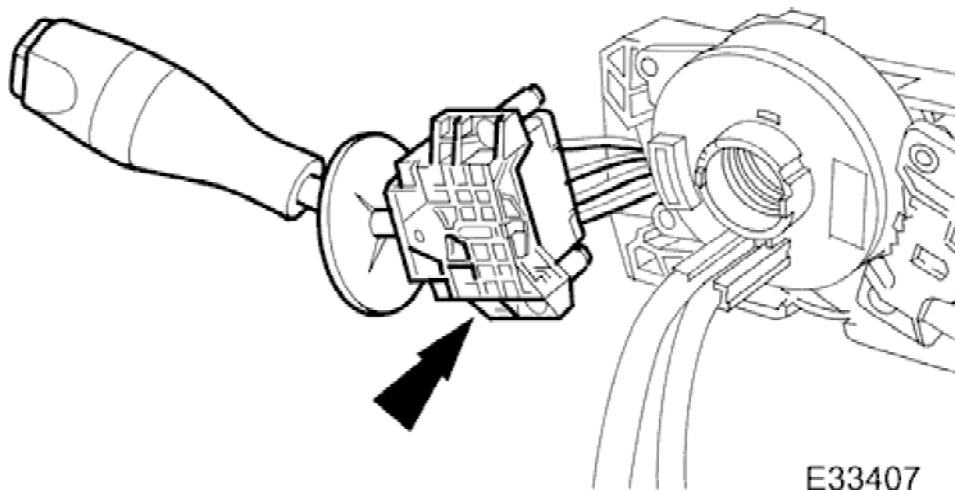

15. Remove flasher/lamp/trip switch assembly from switchgear bracket.

1999 XJ RANGE - Wipers and Washers - 501-16

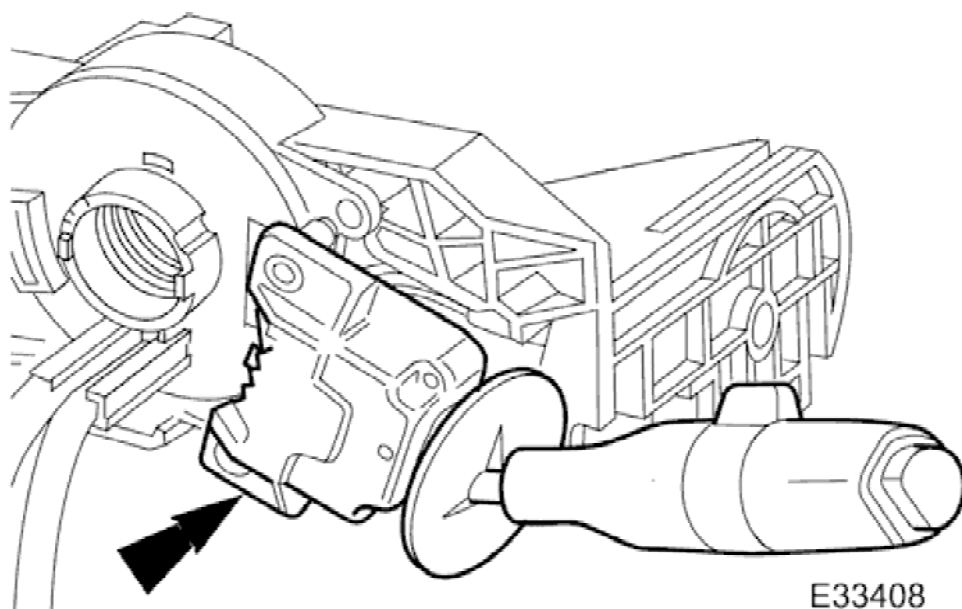

16. **NOTE:**

Due to soldered connections, it is not possible to remove wiper/washer switch at this stage.

Release windshield wiper/washer switch from switchgear bracket and position for access.

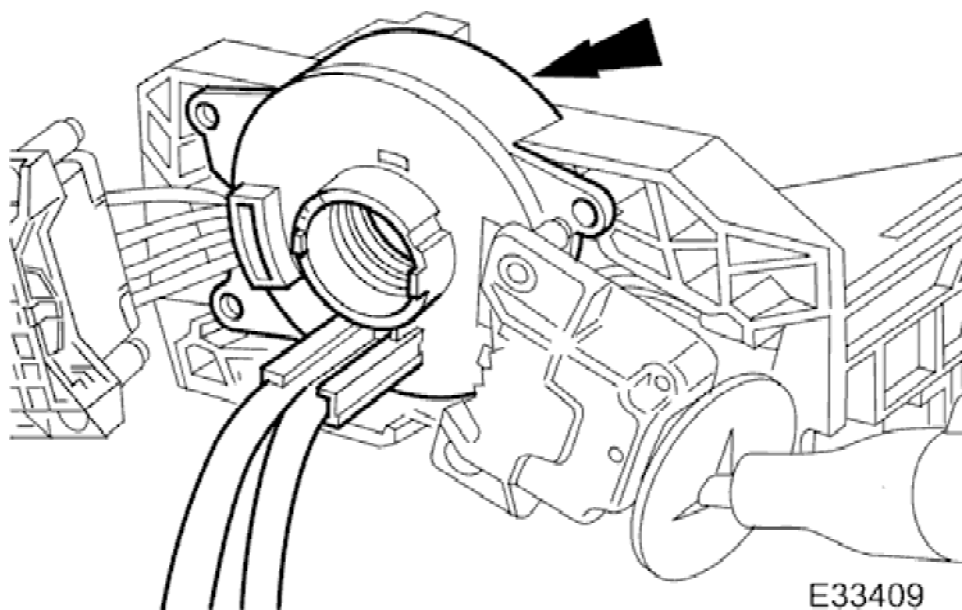

17. Remove cancellation module from mounting bracket.

18. Remove windshield wiper/washer switch/mounting bracket/audible warning speaker assembly from vehicle.

Installation

1. Position windshield wiper/washer switch/mounting bracket/audible warning speaker assembly for access in

1999 XJ RANGE - Wipers and Washers - 501-16

vehicle.

2. Fit cancellation module to mounting bracket.
3. Fit wiper/washer switch to cancellation module/mounting bracket.
4. Fit flasher/lamp/trip switch to cancellation module/mounting bracket.

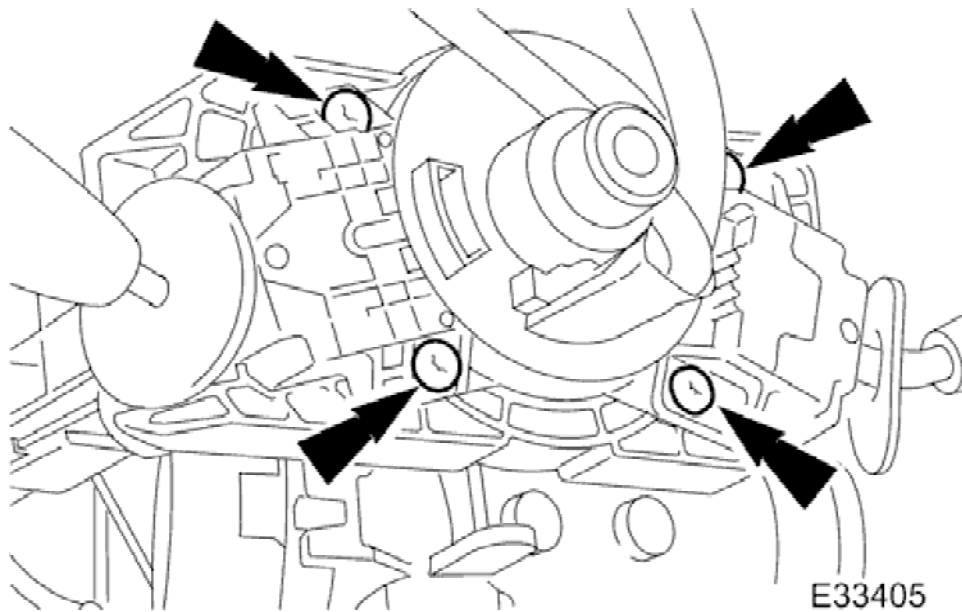

5. Position switchgear assembly on steering column and fit and tighten securing bolts.

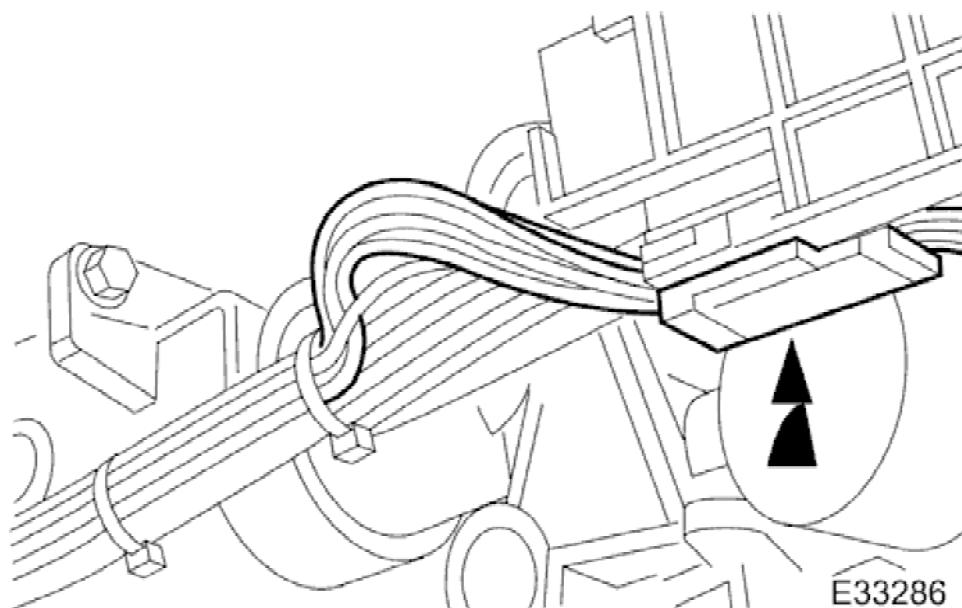

6. Connect cancellation module harness multiplugs and fit multiplugs to retaining bracket.

1999 XJ RANGE - Wipers and Washers - 501-16

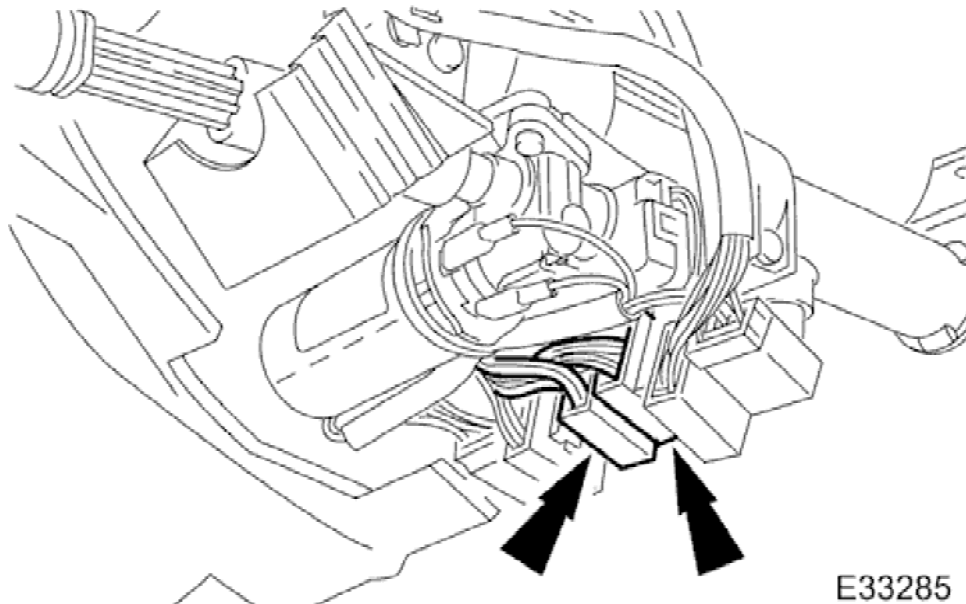

7. Connect flasher/lamp/trip switch harness multiplugs and fit multiplugs to retaining bracket.

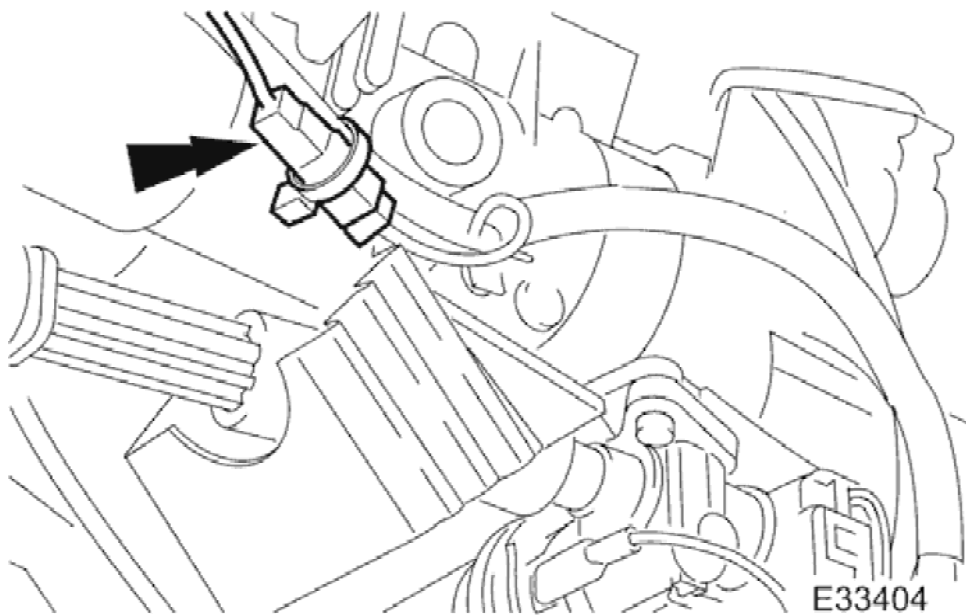

8. Connect key interlock solenoid harness multiplug.

1999 XJ RANGE - Wipers and Washers - 501-16

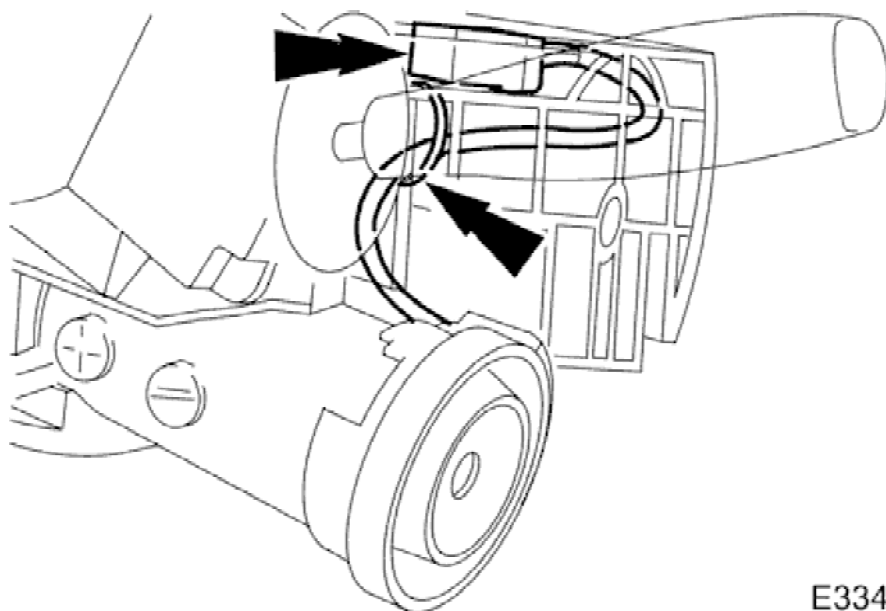

E33403

9. Connect key transponder exciter coil multiplug and using new tie straps, secure multiplug to harness.

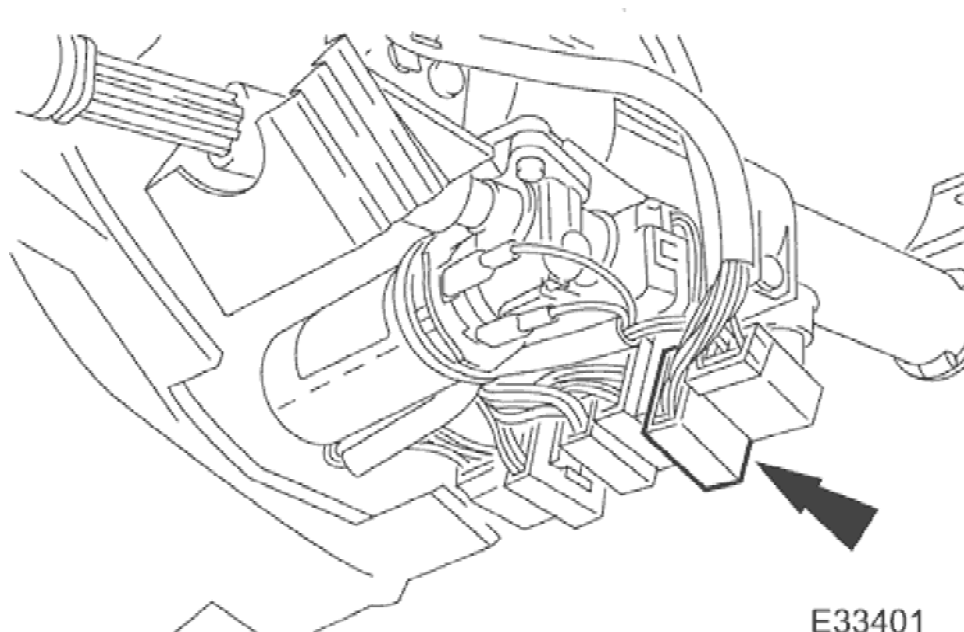

E33401

10. Connect wiper/washer switch multiplug, and fit multiplug onto retaining bracket.

11. Fit driver side underscuttle. Refer to <<76.46.11>>.

12. Fit steering column upper cowl. Refer to <<76.46.02>>.

13. Fit steering column lower cowl. Refer to <<76.46.03>>

1999 XJ RANGE - Wipers and Washers - 501-16

14. Fit steering wheel.

15. Fit driver airbag module. Refer to <<76.73.39>>.

16. Fit ground cable to battery terminal and fit battery cover. Refer to <<86.15.15>>.