

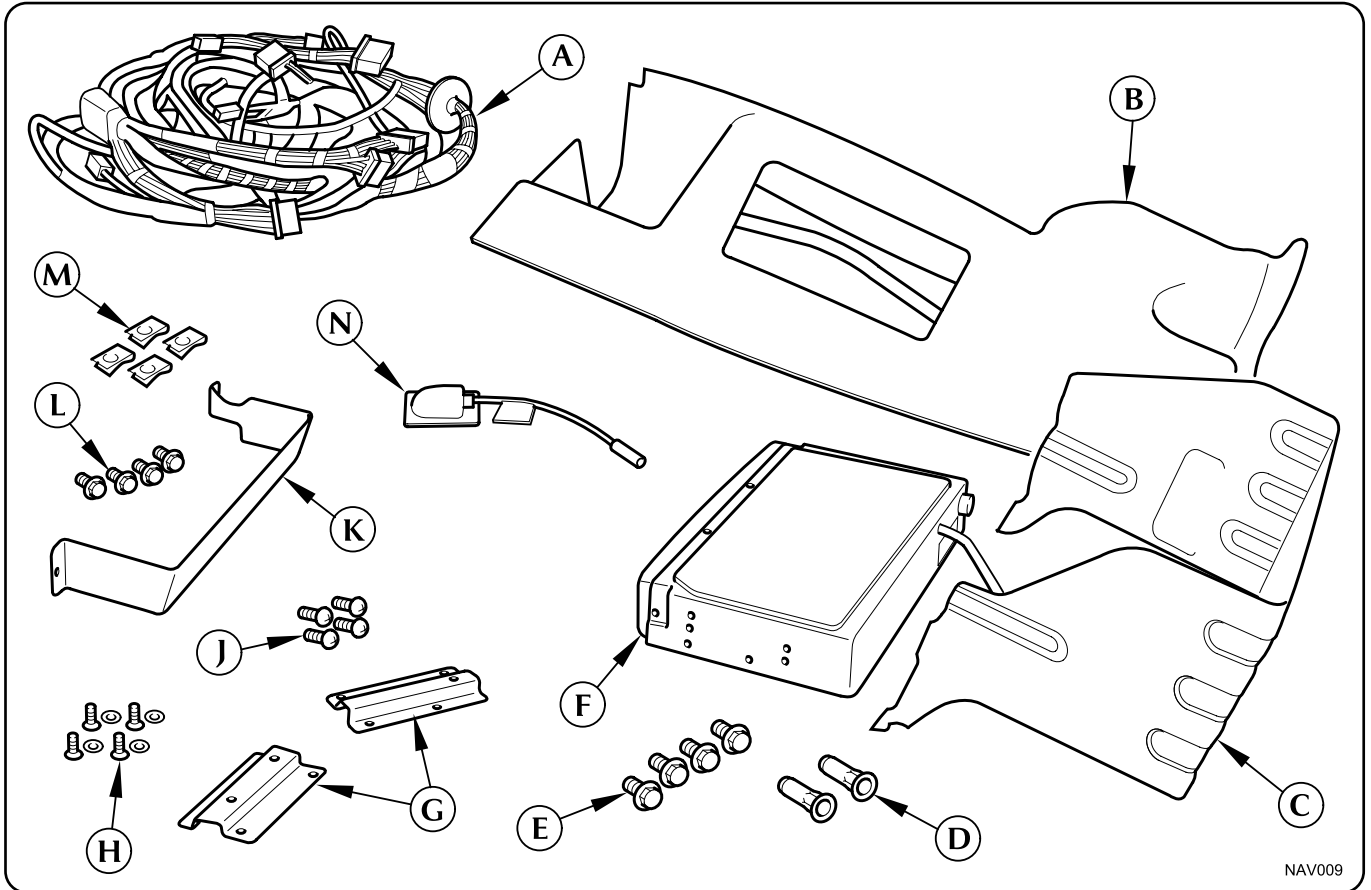

FITTING INSTRUCTIONS

V8 XJ Series
(NAS vehicles only)

Navigation System



NAV009

Content of kit

- A. ICE/NAV harness (premium or base)
- B. NAV trim panel
- C. ICE/NAV stack bracket
- D. Assembly riv nuts
- E. Fixing screws (ICE/NAV stack bracket to body)
- F. NAV ECM/CD unit
- G. RH and LH NAV brackets
- H. Screws & washers (NAV ECM to RH and LH NAV brackets)
- J. Fixing screws (NAV ECM/CD assembly to stack bracket)
- K. Trim panel support bracket
- L. Fixing screws (ICE amplifier trim panel support bracket)
- M. Spring nuts
- N. Antenna

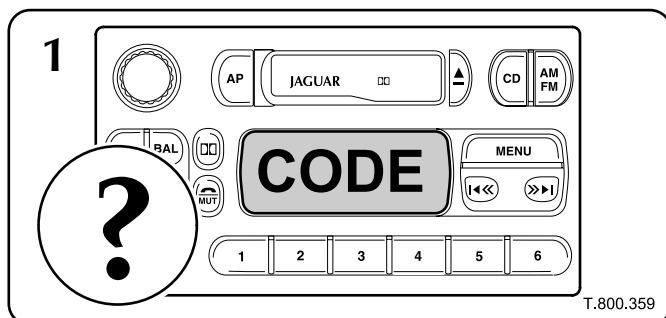

T.800.359

Notes:

1. Ensure radio code is available before disconnecting the battery.

MY 2001

Part No. **LNG3650FIT**

V8 XJ Series
(NAS vehicles only)

Navigation System

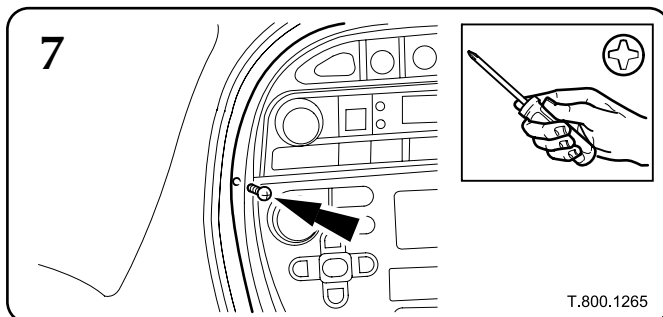
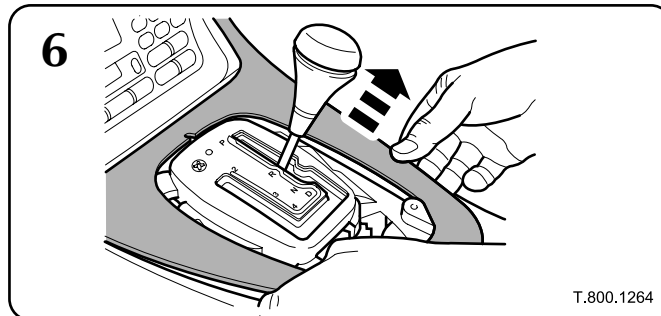
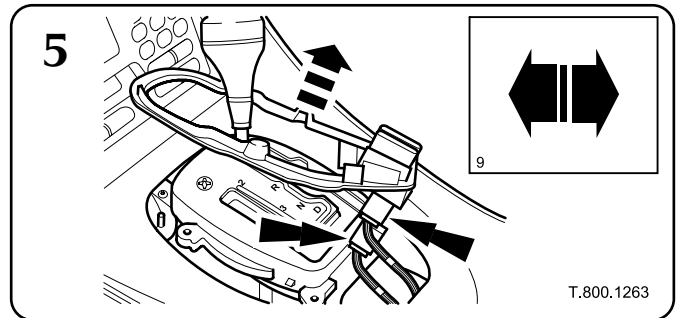
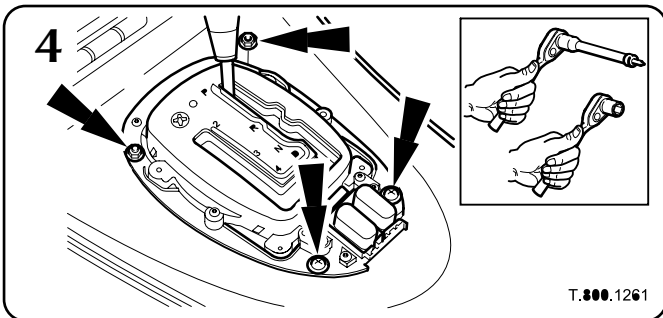
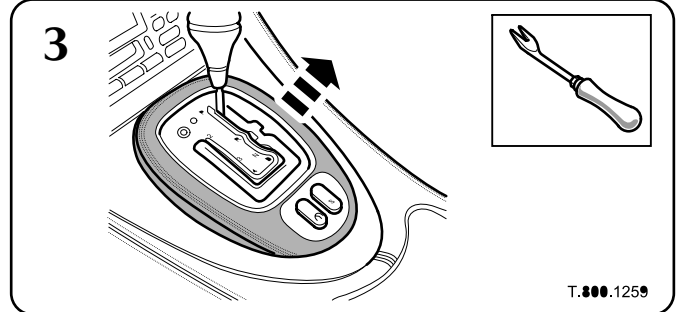
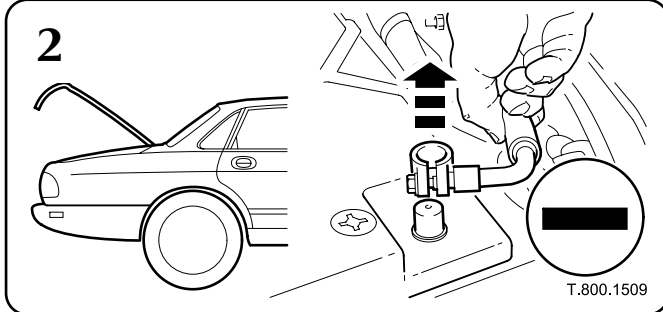

Notes:

- 7. Release 2 screws - LH and RH side of centre console.

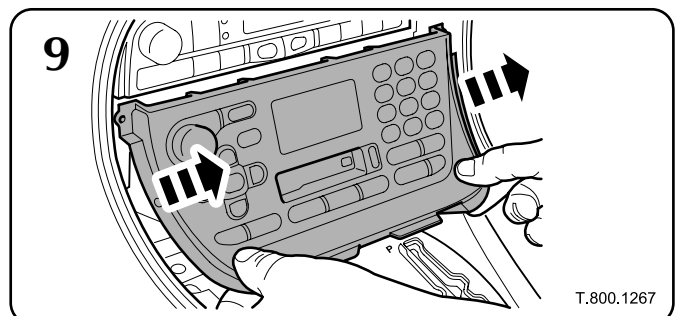
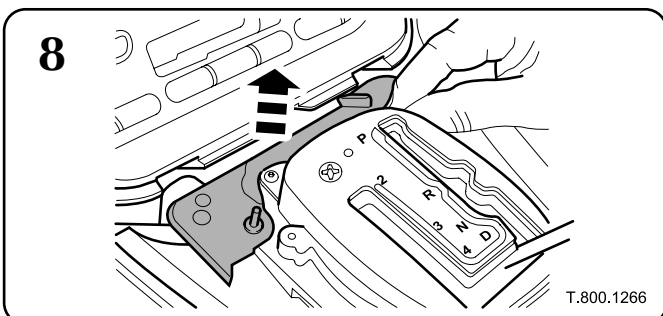

MY **2001**

Part No. **LNG3650FIT**

V8 XJ Series
(NAS vehicles only)

Navigation System

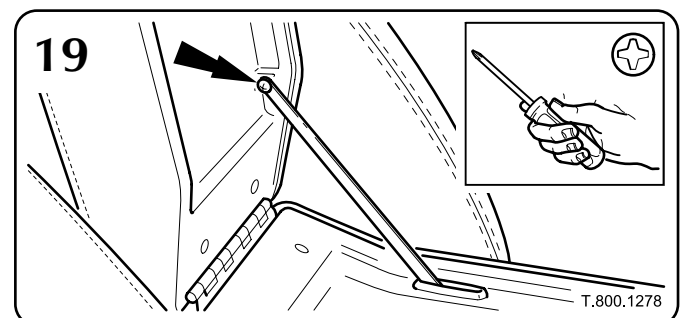
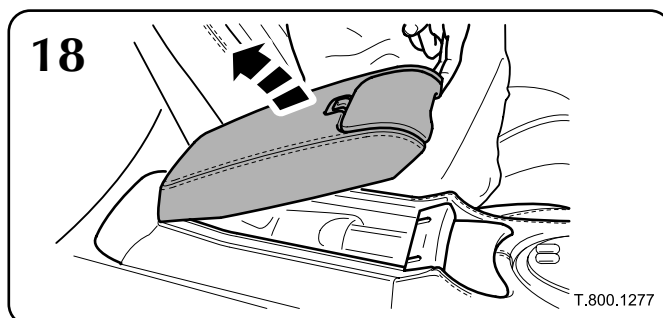
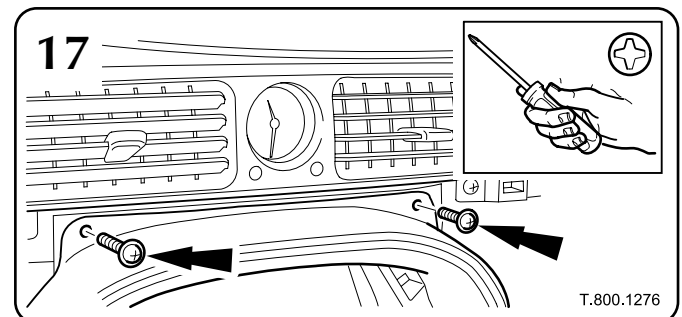
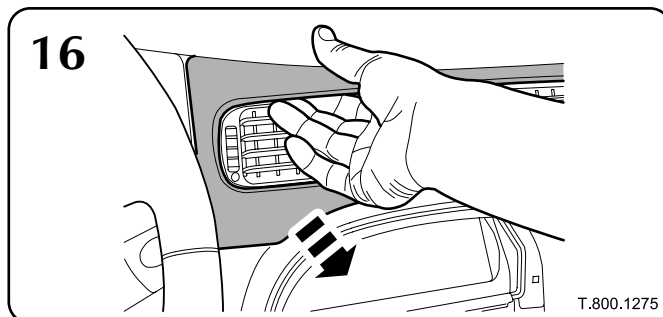
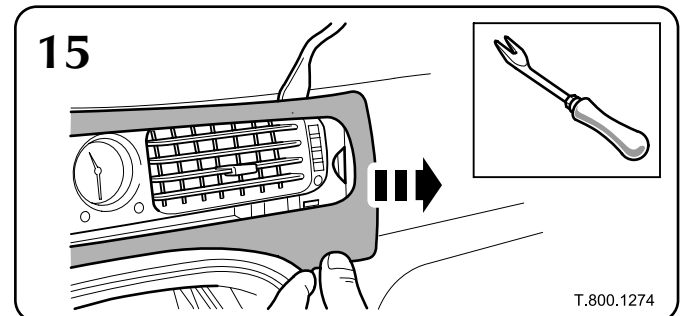
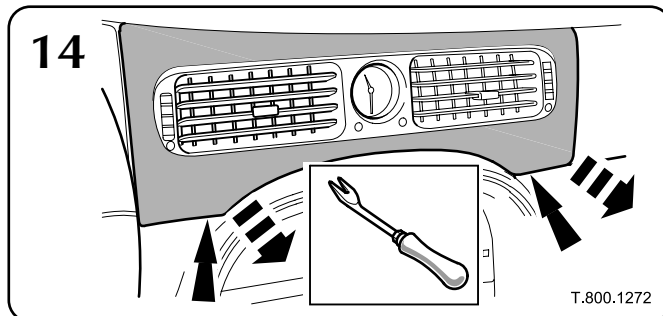
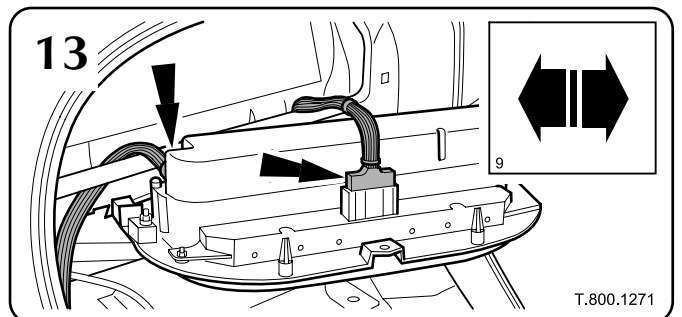
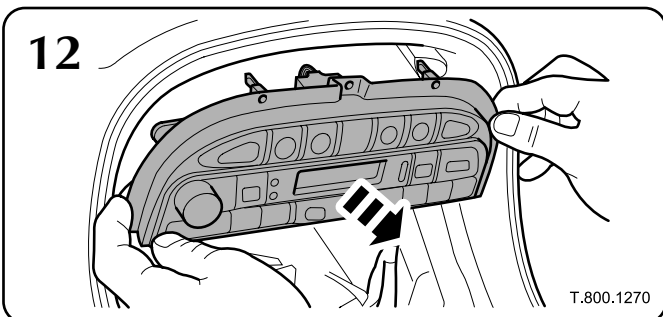
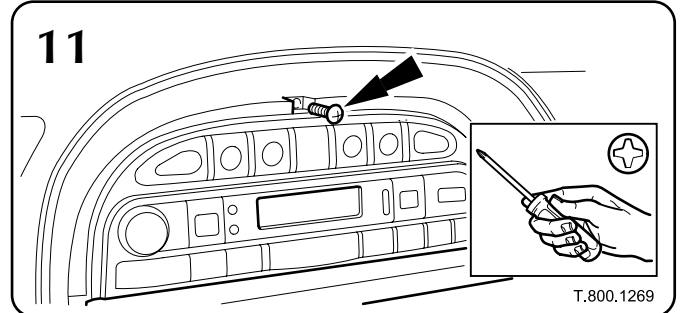
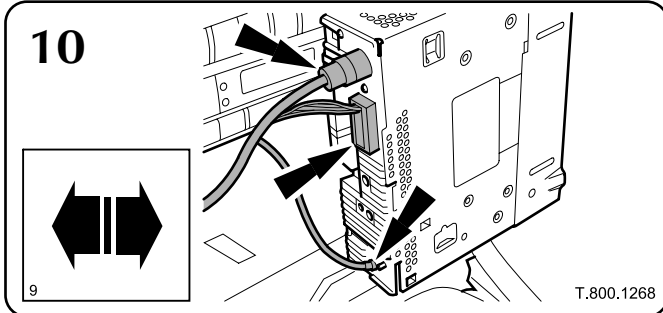

V8 XJ Series
(NAS vehicles only)

Navigation System

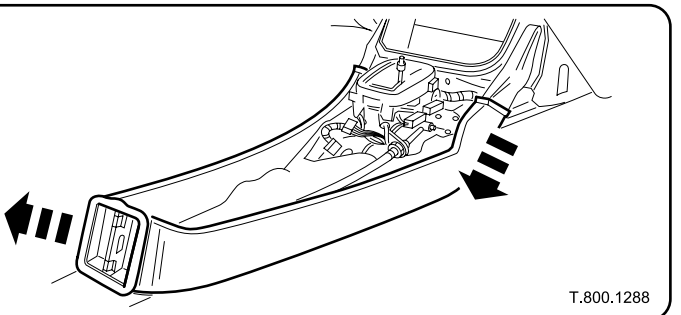
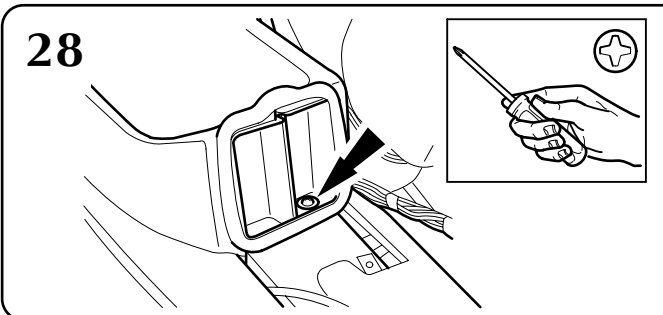
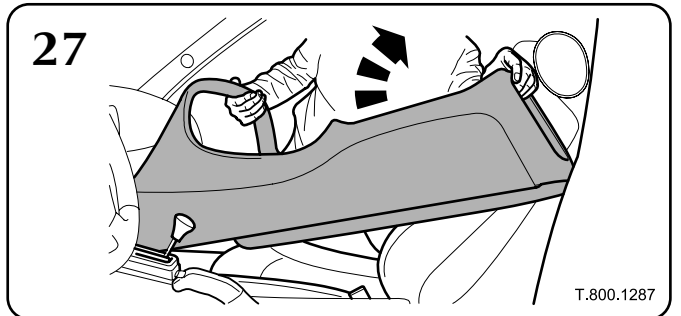
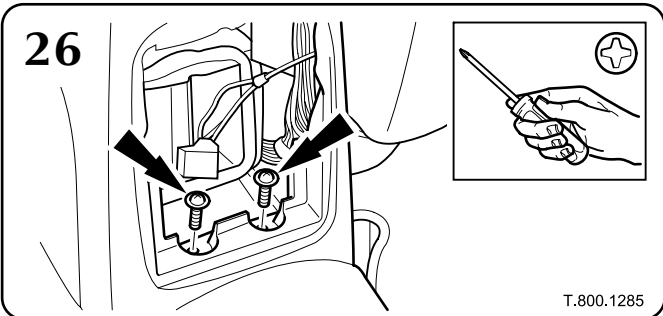
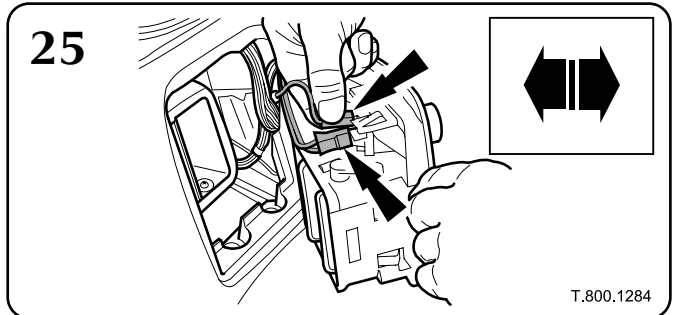
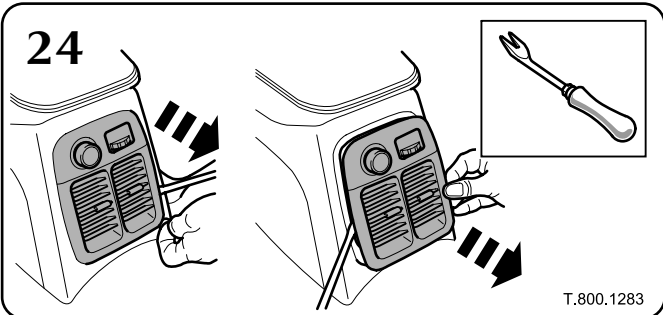
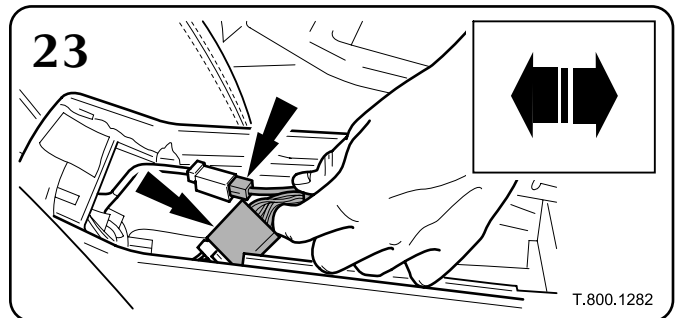
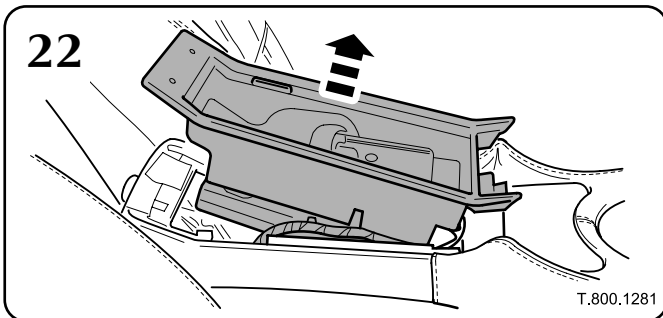
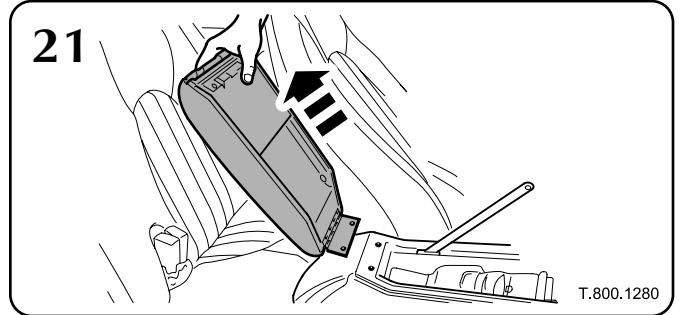
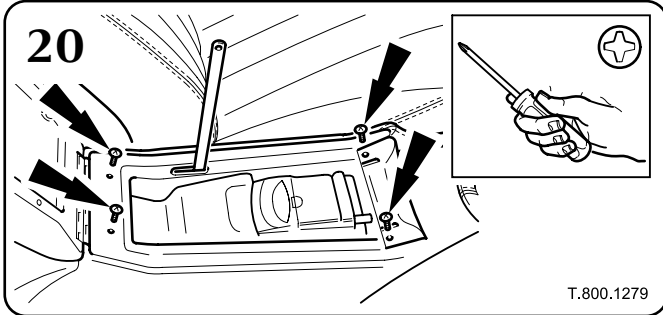

V8 XJ Series
(NAS vehicles only)

Navigation System

29

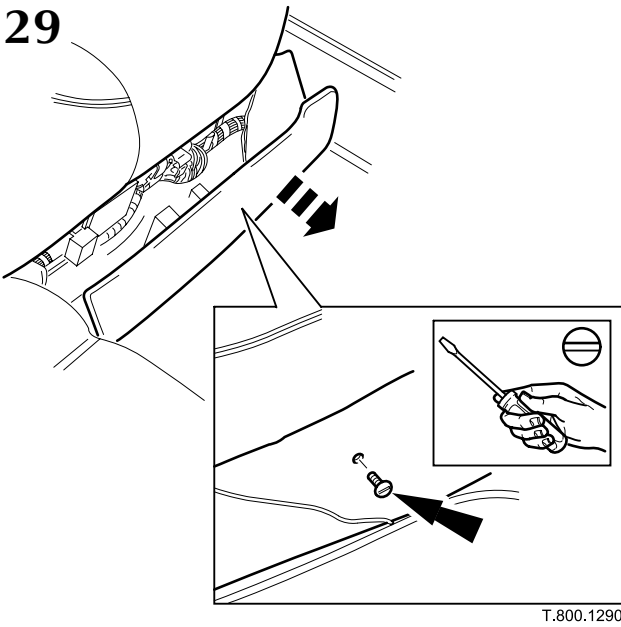

Notes:

29. Remove LH and RH heel boards.

30

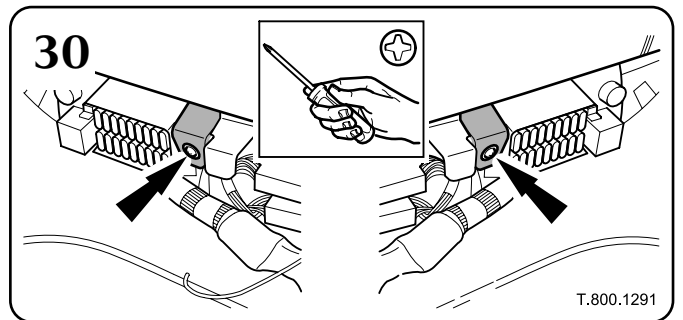

31

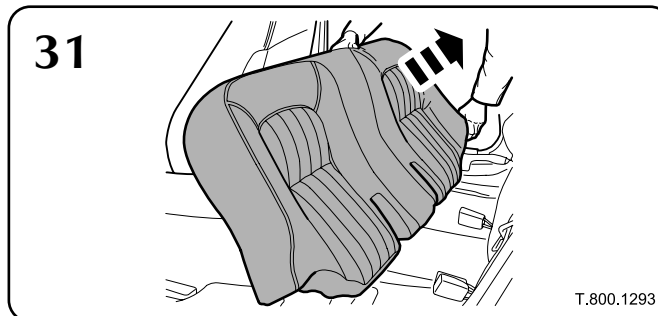

32

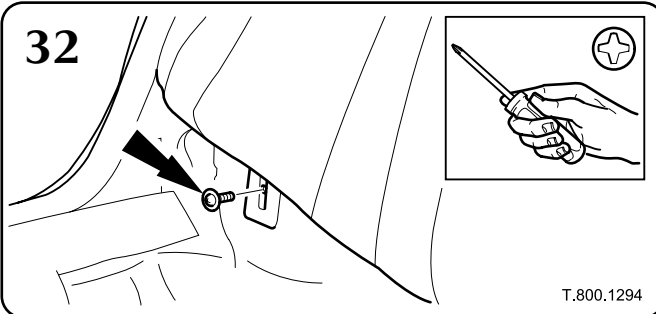

Notes:

32. Remove LH and RH seat squab fixing bolts.

33

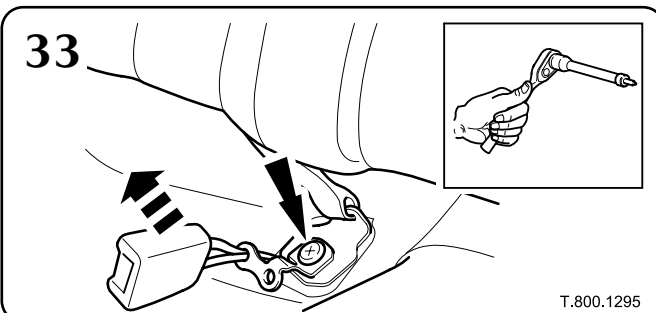

Notes:

33. Remove seatbelt anchor bolts.

V8 XJ Series
(NAS vehicles only)

Navigation System

34

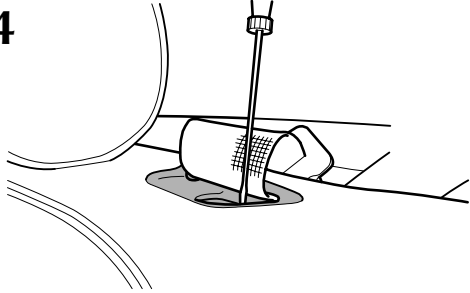

T.800.1296

Notes:

34. Release LH and RH seatbelt bezels.

35

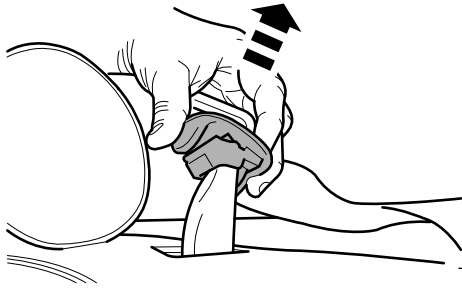

T.800.1297

36

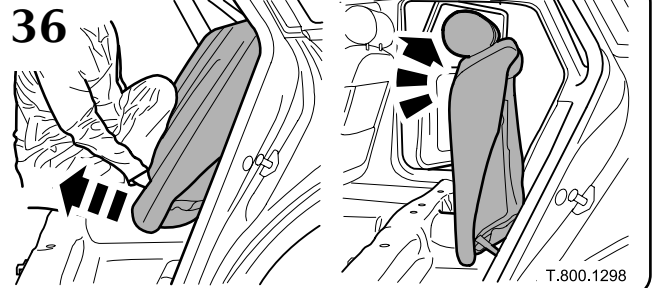

T.800.1298

37

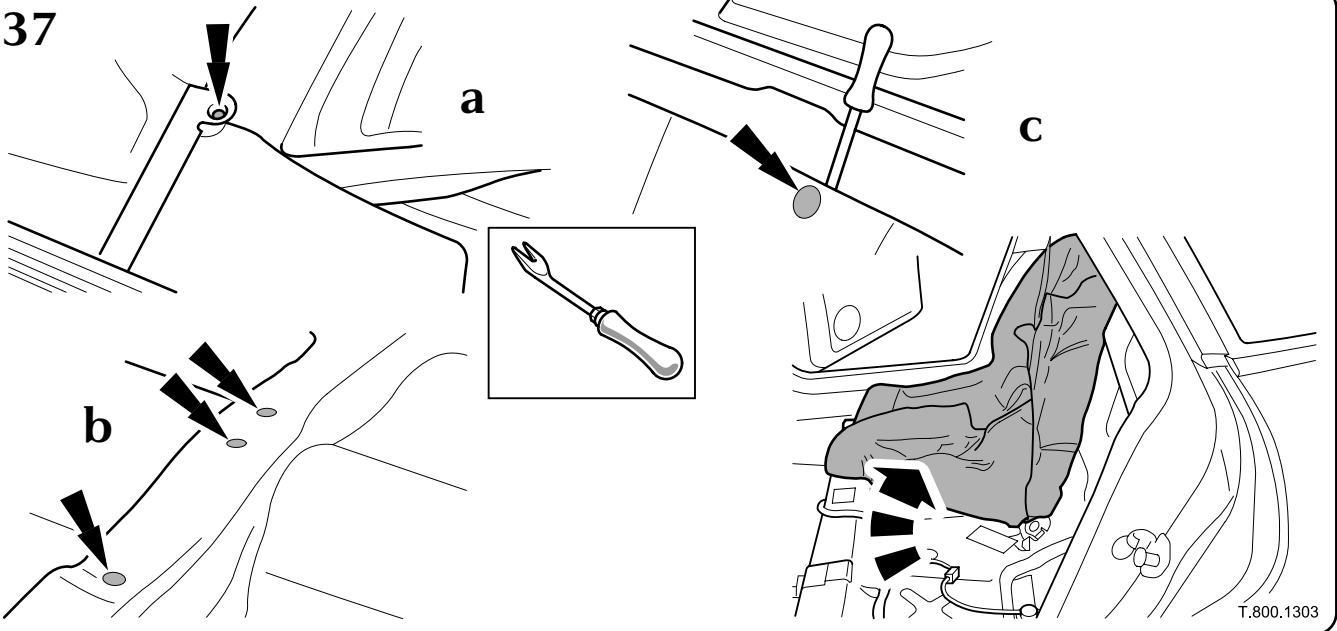

T.800.1303

38

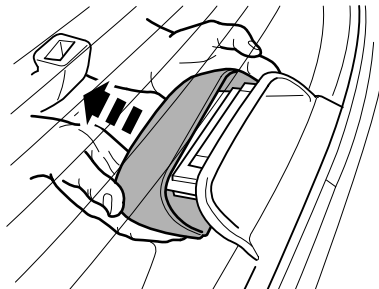

T.800.1304

V8 XJ Series
(NAS vehicles only)

Navigation System

39

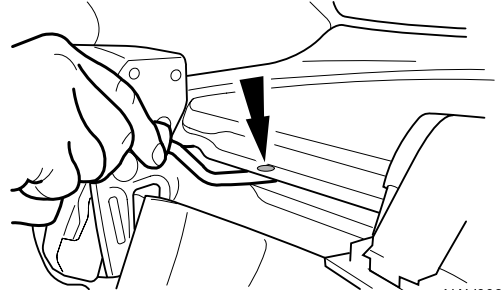
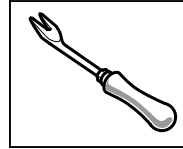
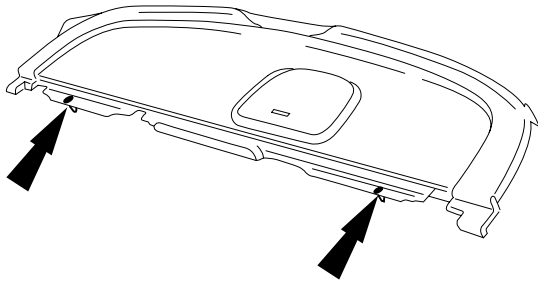

NAV008

40

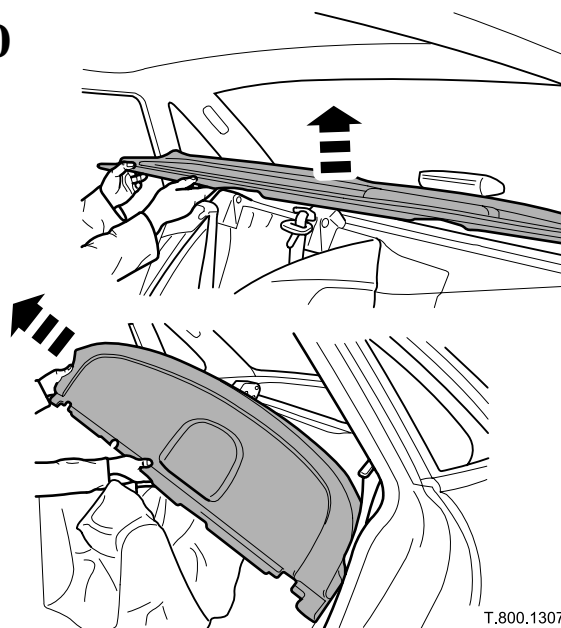

T.800.1307

41

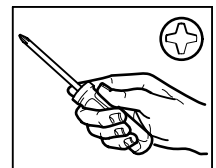
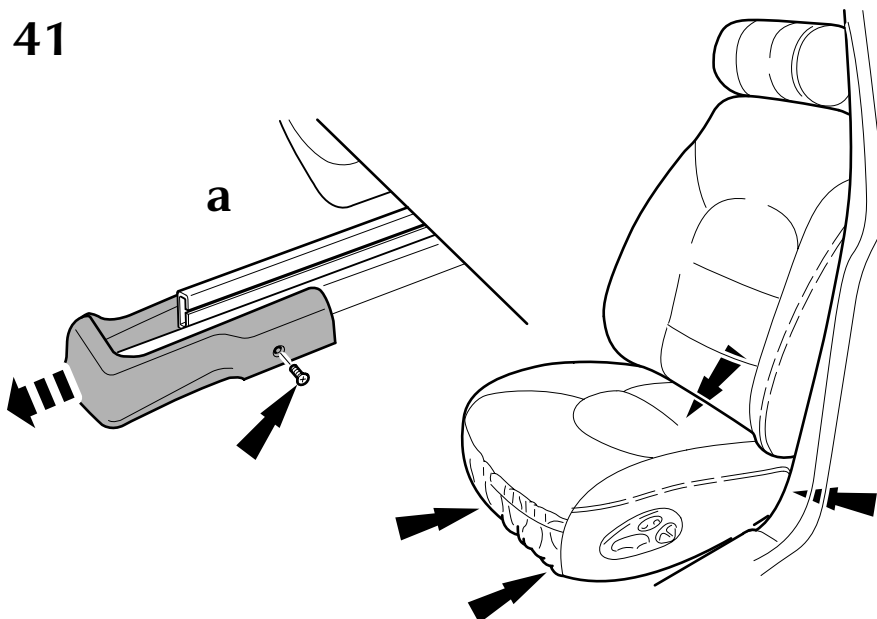

b

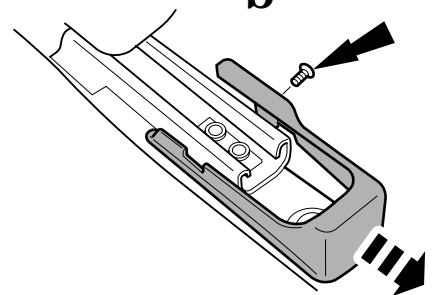

T.800.1308

MY 2001

Part No. *LNG3650FIT*

V8 XJ Series
(NAS vehicles only)

Navigation System

42

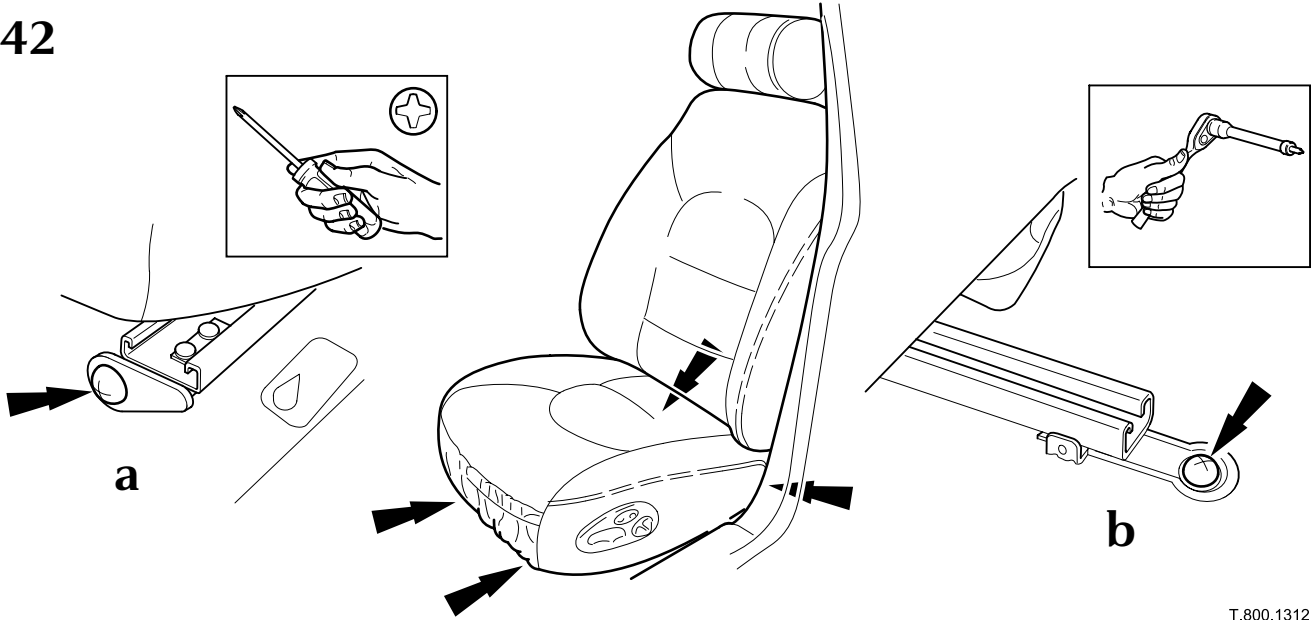

T.800.1312

43

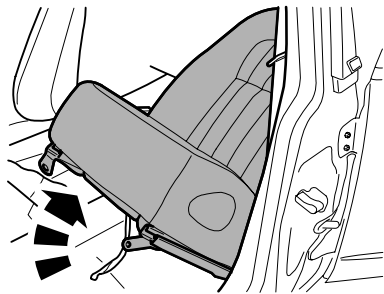

T.800.1314

44

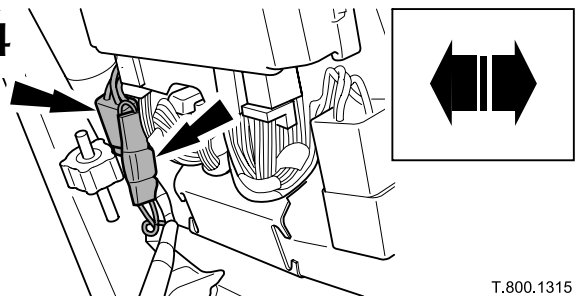

T.800.1315

45

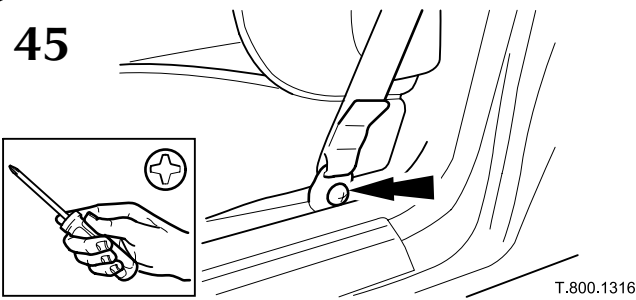

T.800.1316

46

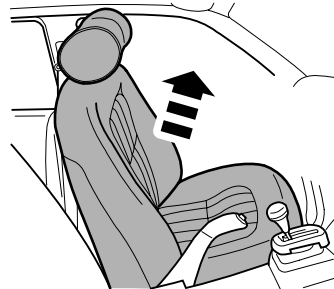

T.800.1317

47

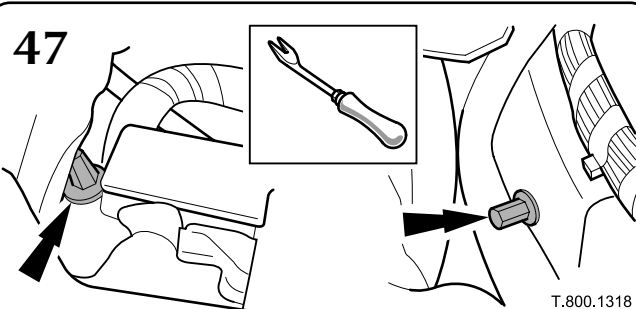

T.800.1318

Notes:

47. Release 2 harness clips at front of tunnel.

MY 2001

Part No. *LNG3650FIT*

V8 XJ Series
(NAS vehicles only)

Navigation System

48

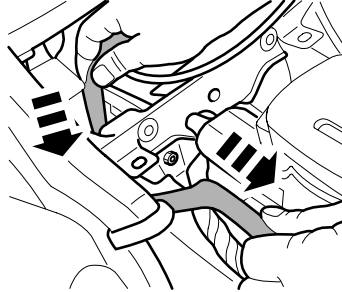

T.800.1319

49

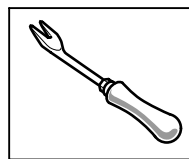
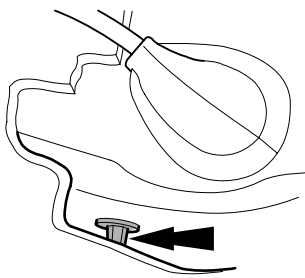

T.800.1320

Notes:

49. Release harness clip at side of tunnel.

50

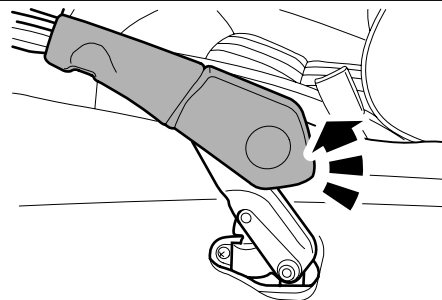

T.800.1321

51

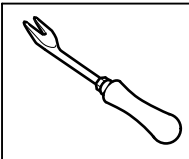
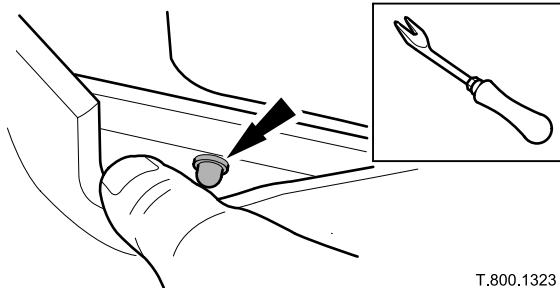

T.800.1323

Notes:

51. Lift carpet and release 2nd harness clip at side of tunnel.

52

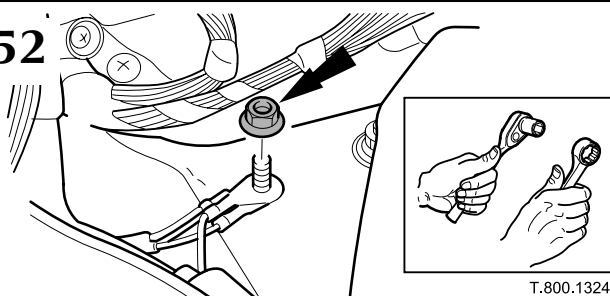

T.800.1324

Notes:

52. Release earth lead.

V8 XJ Series
(NAS vehicles only)

Navigation System

53

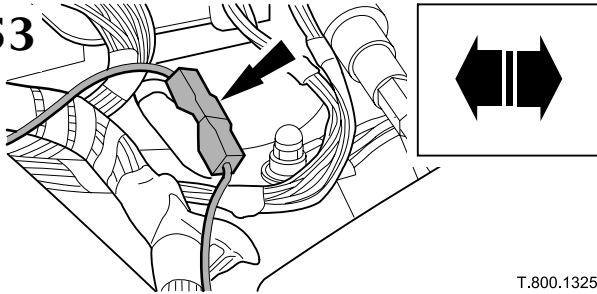

T.800.1325

Notes:

53. Disconnect handbrake switch.

54

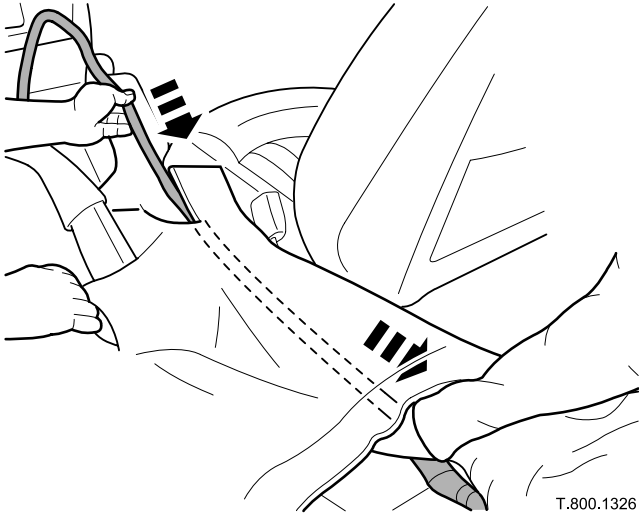

T.800.1326

55

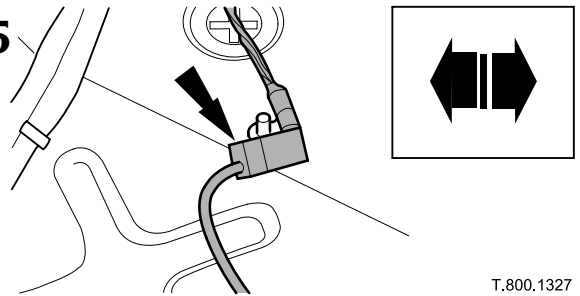

T.800.1327

56

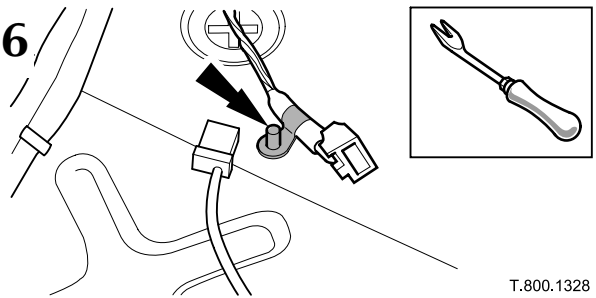

T.800.1328

57

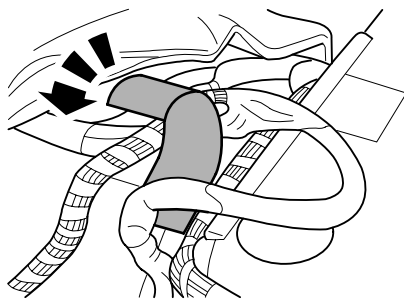

T.800.1329

Notes:

57. Remove adhesive tape securing harness to tunnel.

58

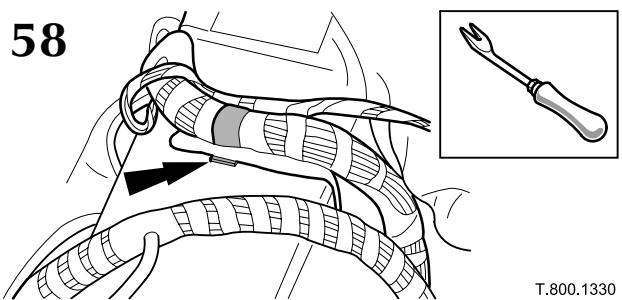

T.800.1330

59

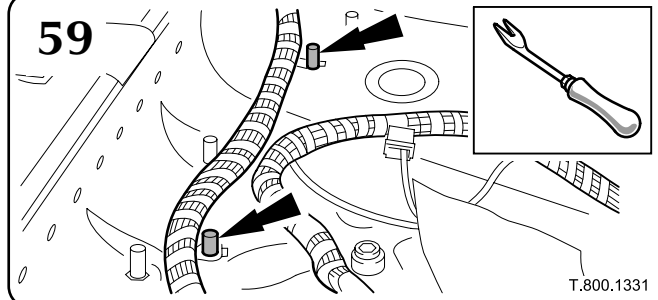

T.800.1331

MY 2001

Part No. **LNG3650FIT**

V8 XJ Series
(NAS vehicles only)

Navigation System

60

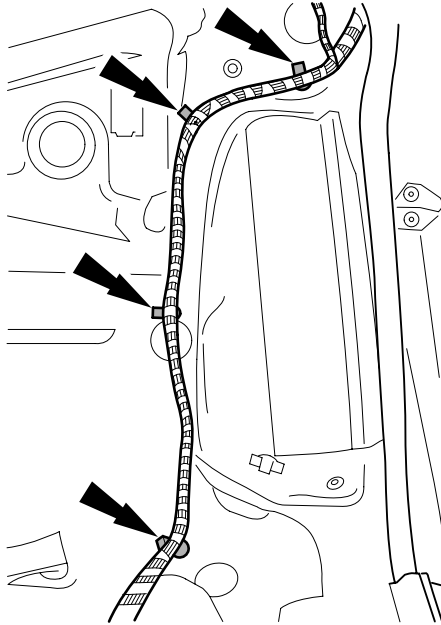

61

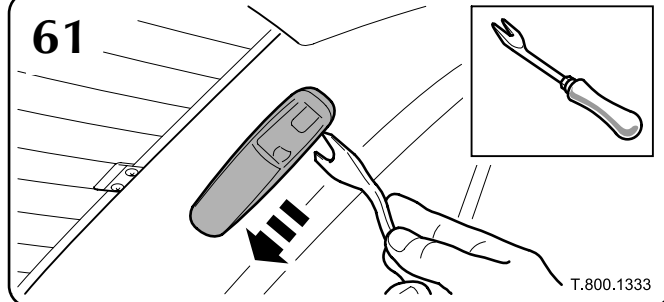

62

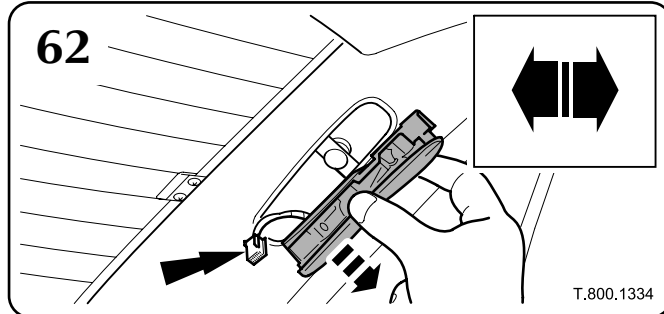

63

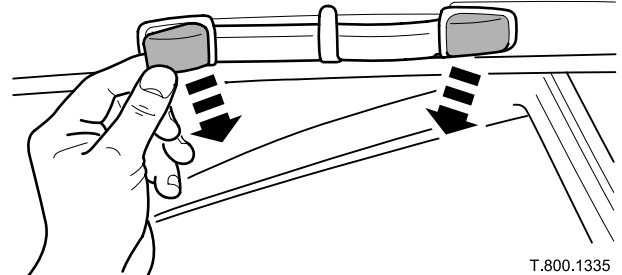
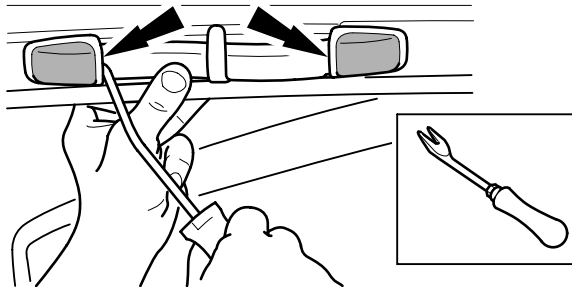

64

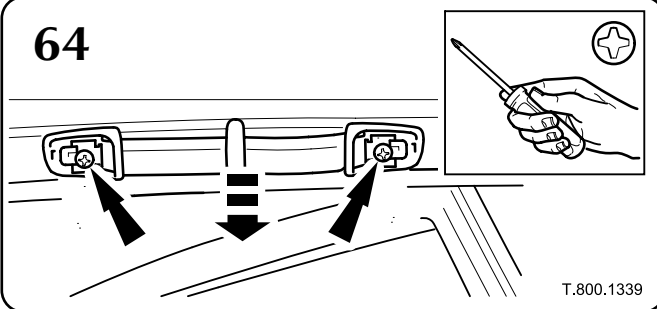

65

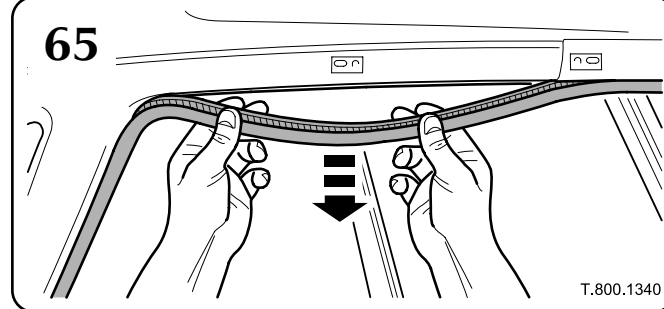

66

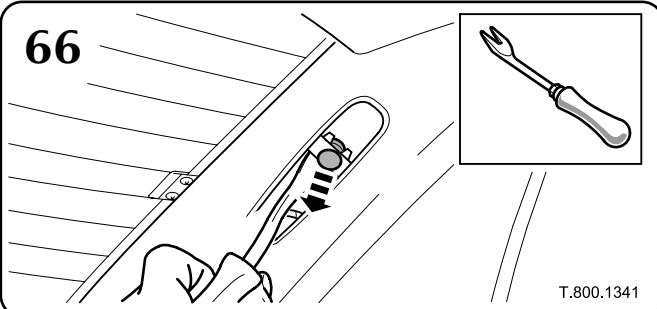

67

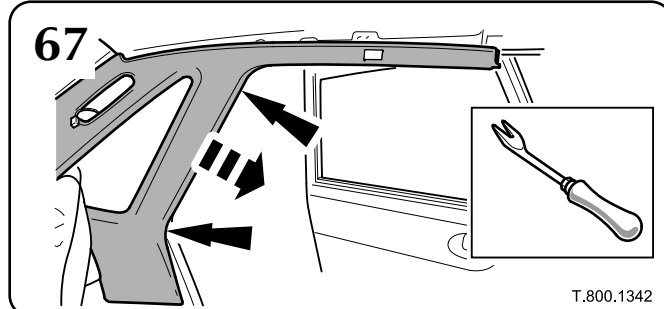

V8 XJ Series
(NAS vehicles only)

Navigation System

68

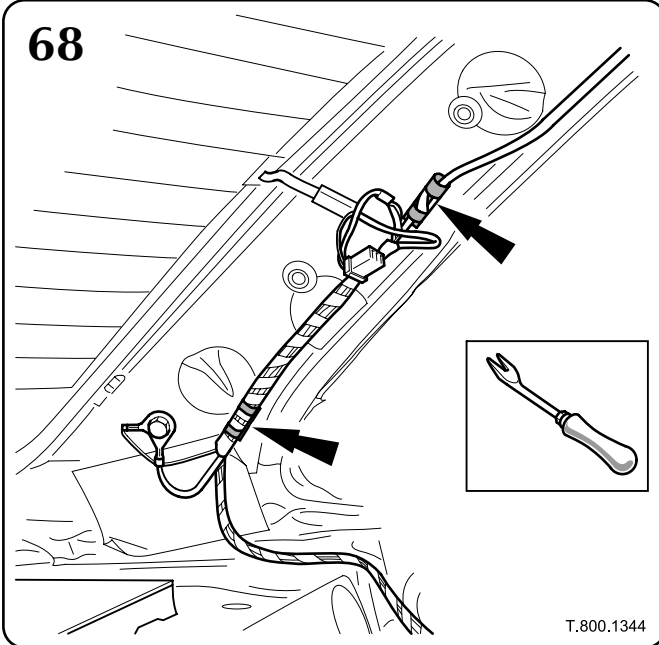

69

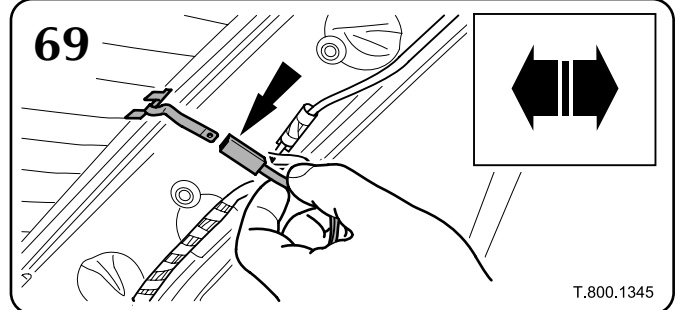

70

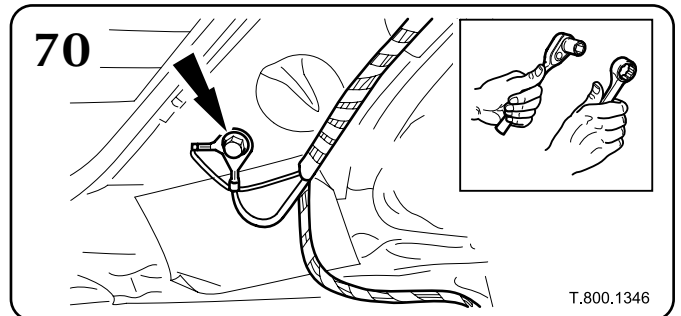

71

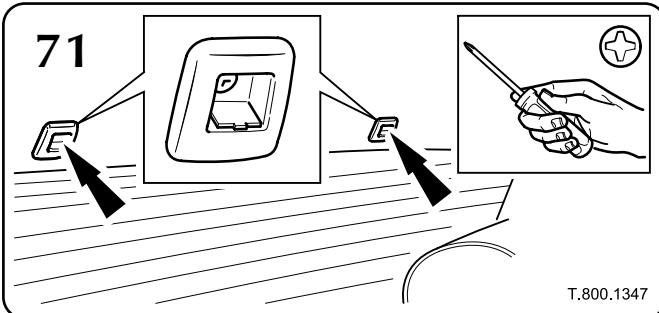

Notes:

71. Fixing screws located behind flap.

72

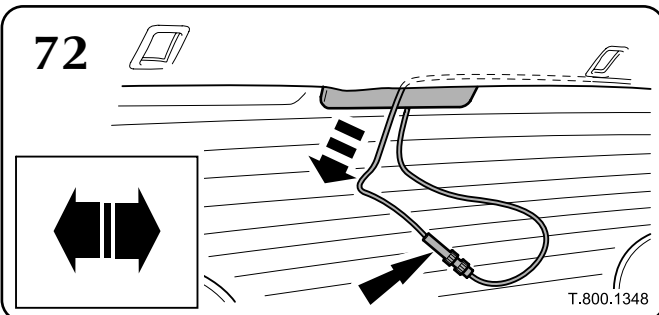

Notes:

72. Locate antenna lead and disconnect from harness.

73

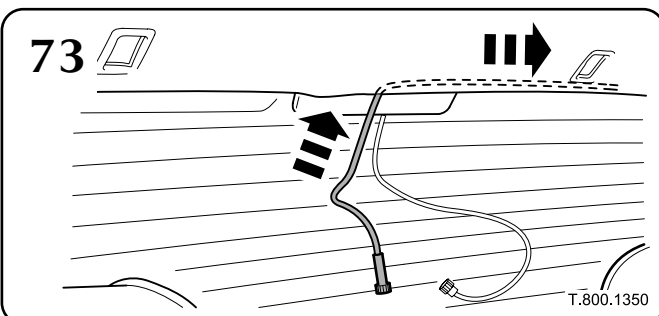

74

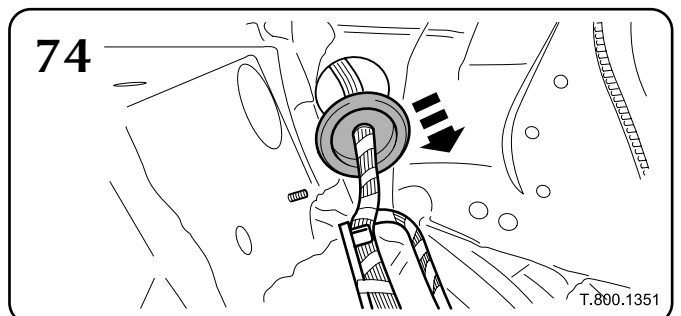

V8 XJ Series
(NAS vehicles only)

Navigation System

75

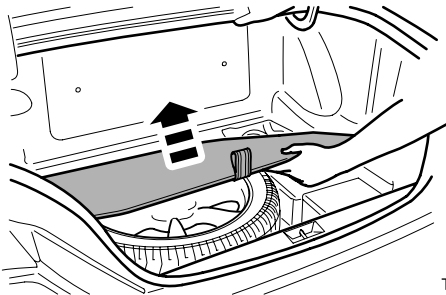

T.800.1352

76

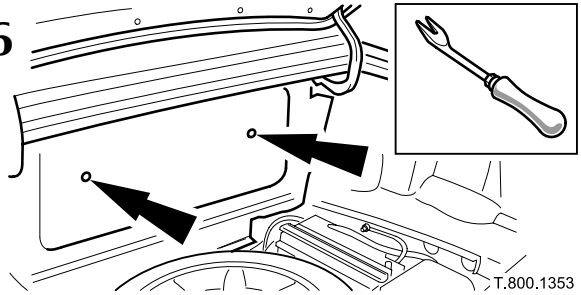

T.800.1353

77

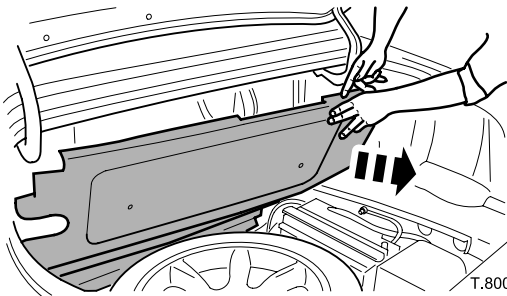

T.800.1354

78

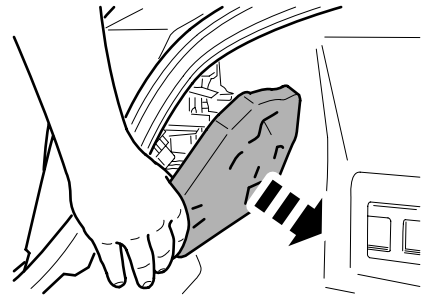

T.800.1355

79

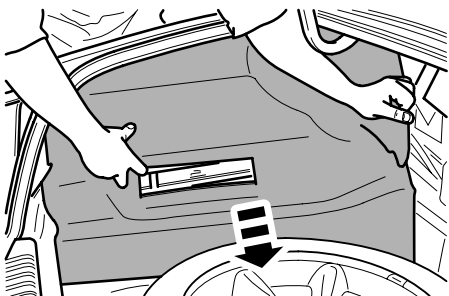

T.800.1356

80

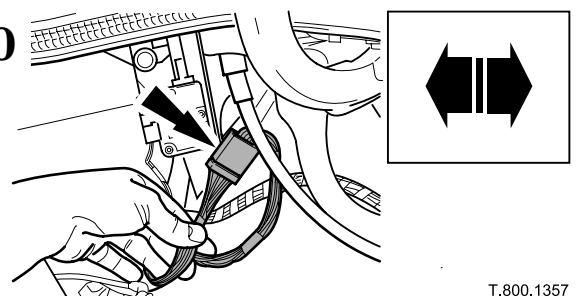

T.800.1357

81

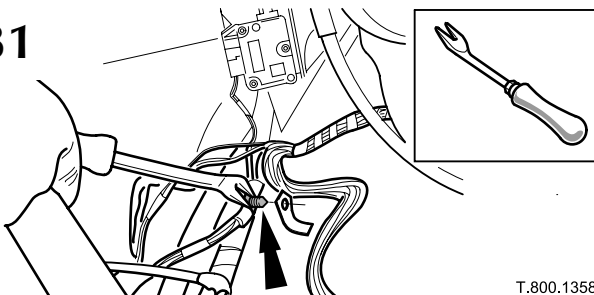

T.800.1358

82

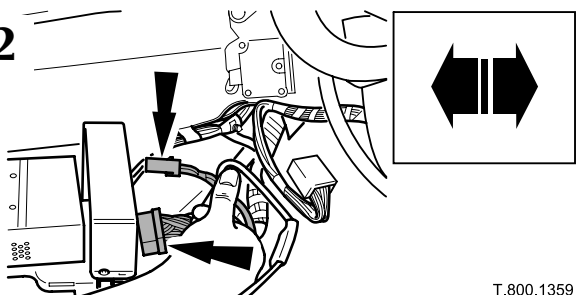

T.800.1359

83

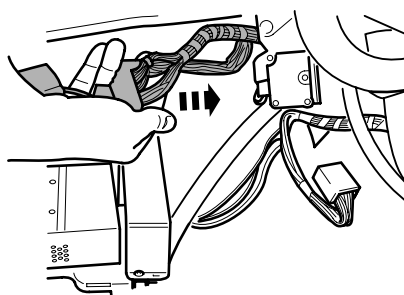

T.800.1360

MY 2001

Part No. *LNG3650FIT*

V8 XJ Series
(NAS vehicles only)

Navigation System

84

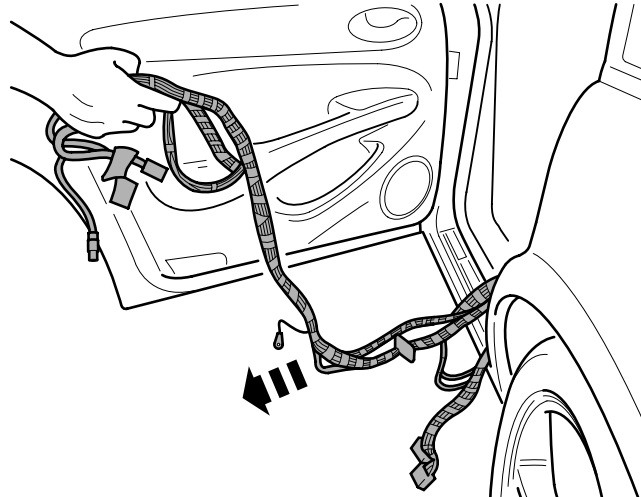

T.800.1361

85

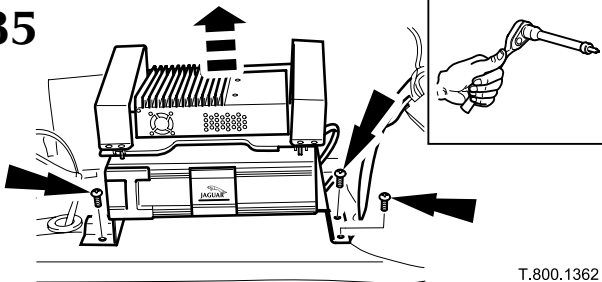

T.800.1362

86

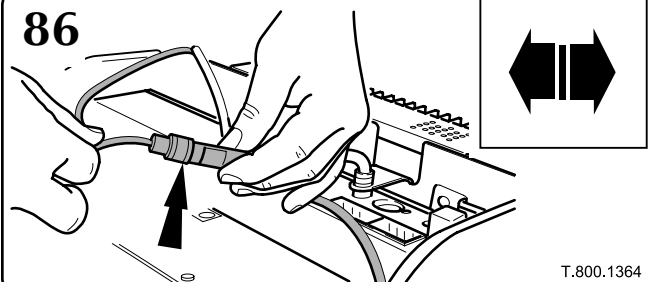

T.800.1364

87

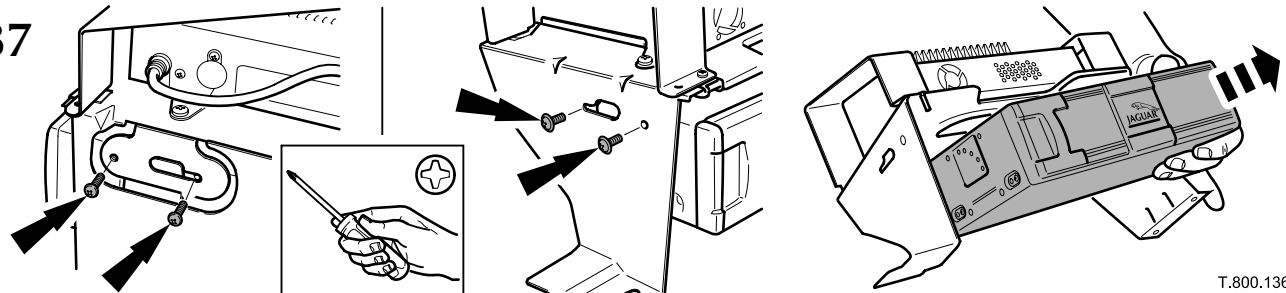

T.800.1365

88

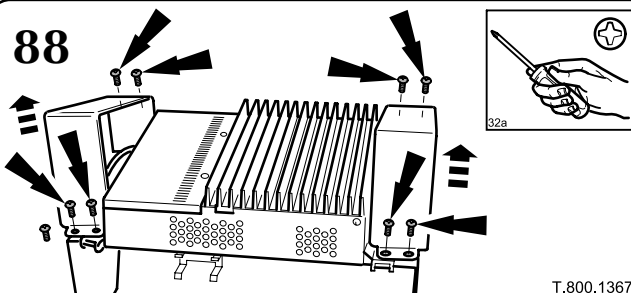

T.800.1367

89

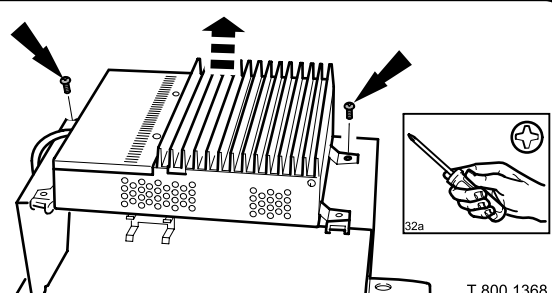

T.800.1368

MY 2001

Part No. **LNG3650FIT**

V8 XJ Series
(NAS vehicles only)

Navigation System

90

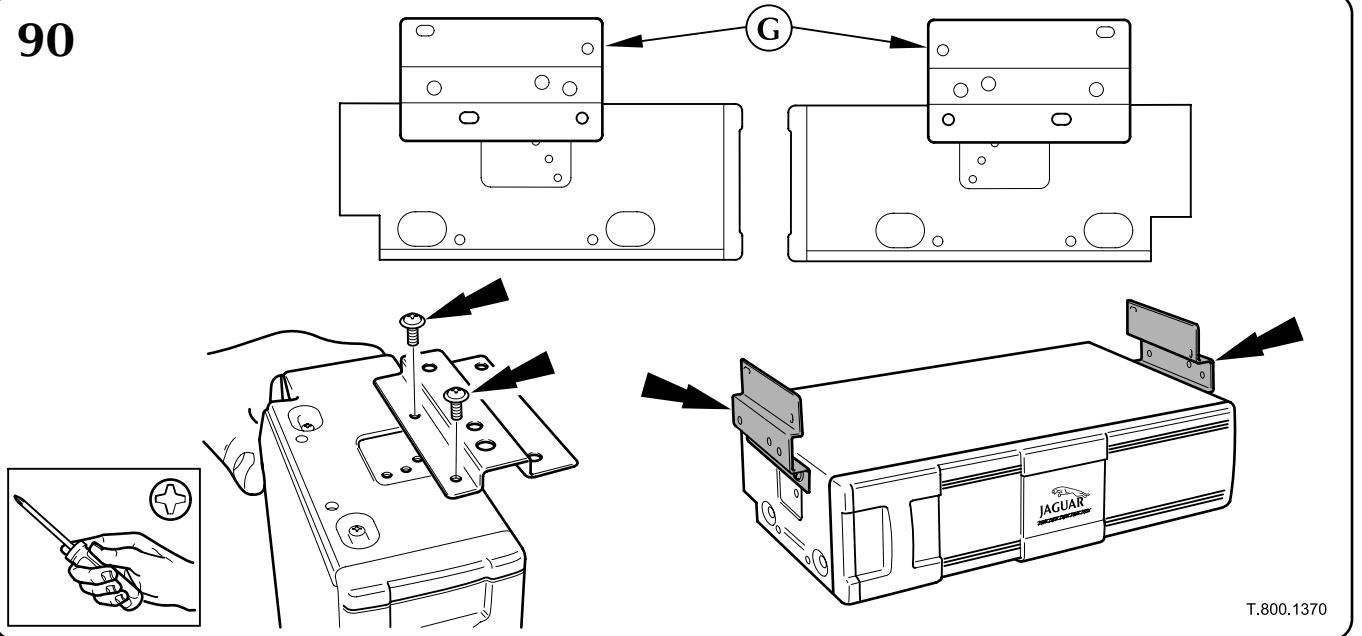

T.800.1370

Notes:

90. Use existing CD mounting screws (see picture 87).

91

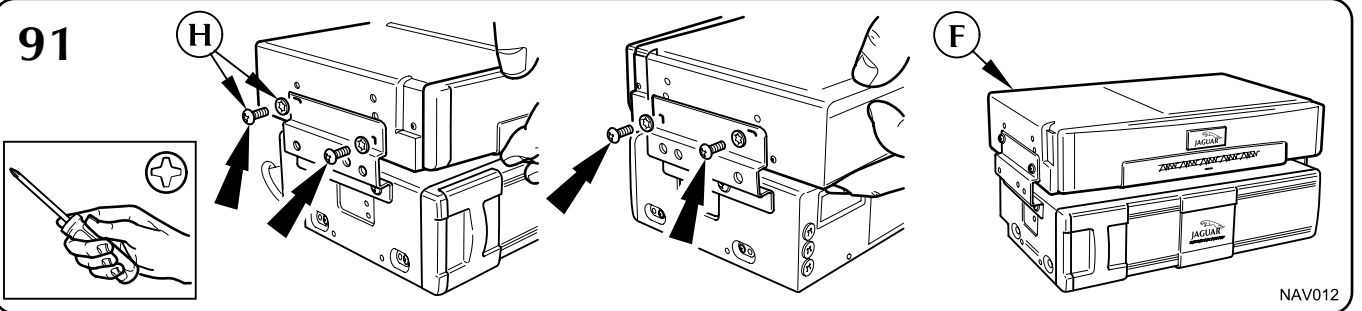

NAV012

92

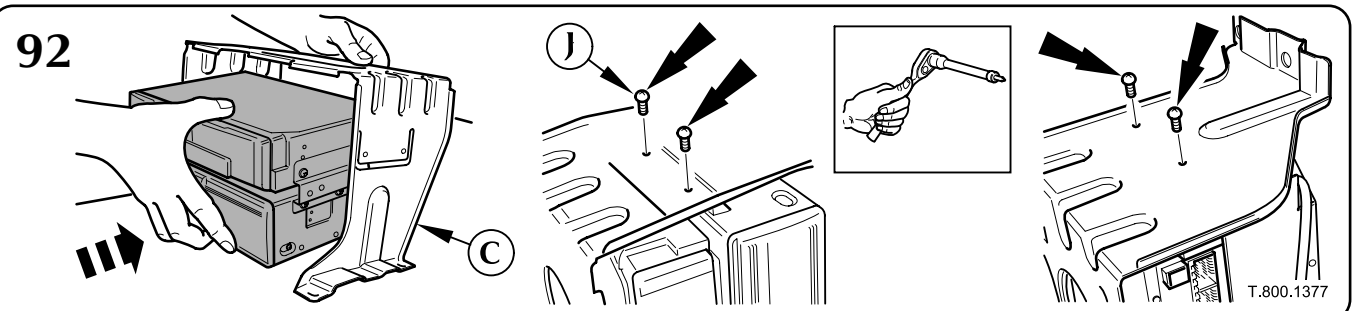

T.800.1377

MY 2001

Part No. **LNG3650FIT**

V8 XJ Series
(NAS vehicles only)

Navigation System

93

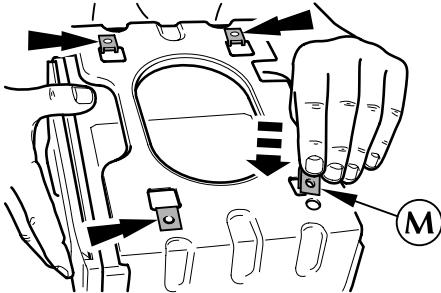

T.800.1380

94

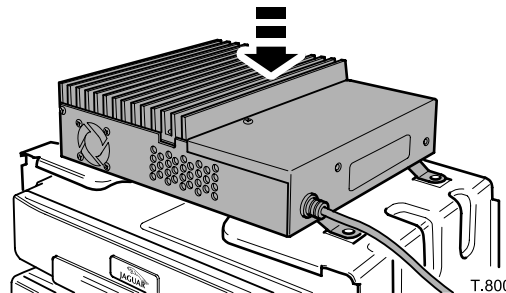

T.800.1381

95

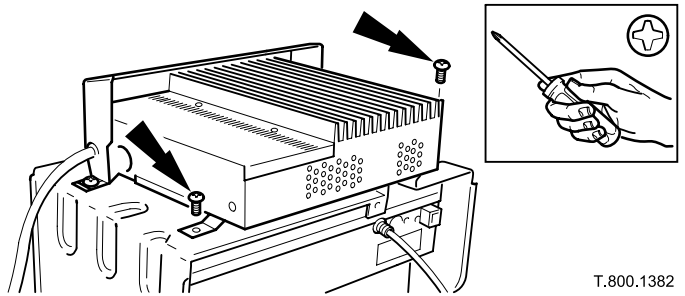
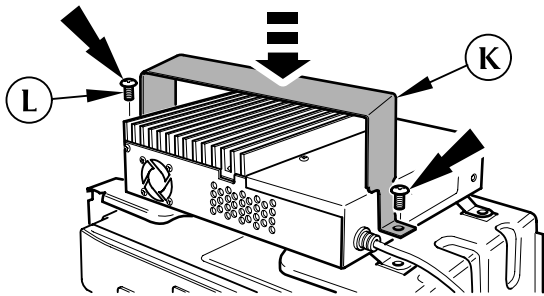

T.800.1382

96

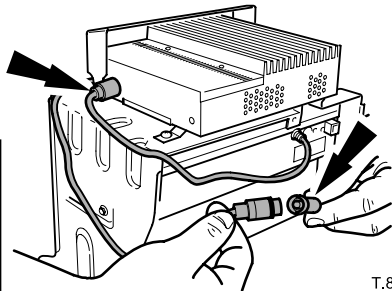

T.800.1387

97

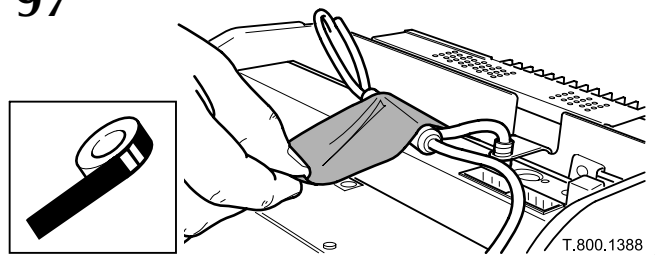

T.800.1388

98

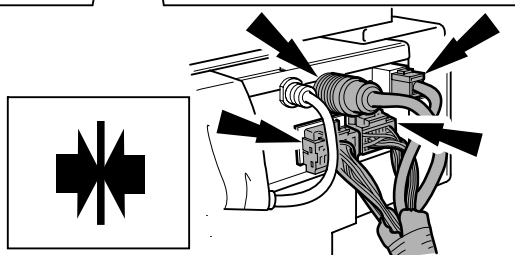
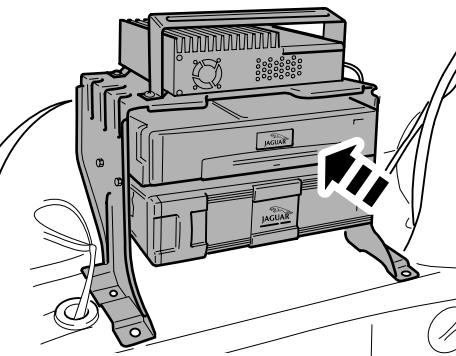

T.800.1390

99

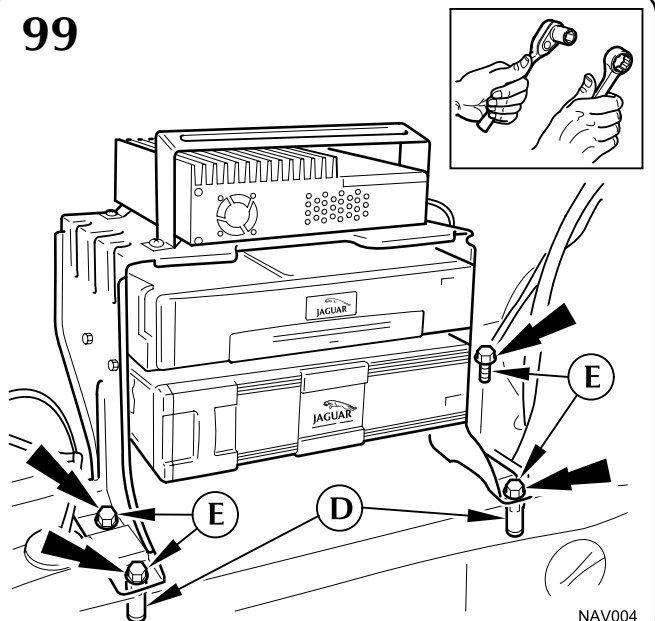

NAV004

V8 XJ Series
(NAS vehicles only)

Navigation System

100

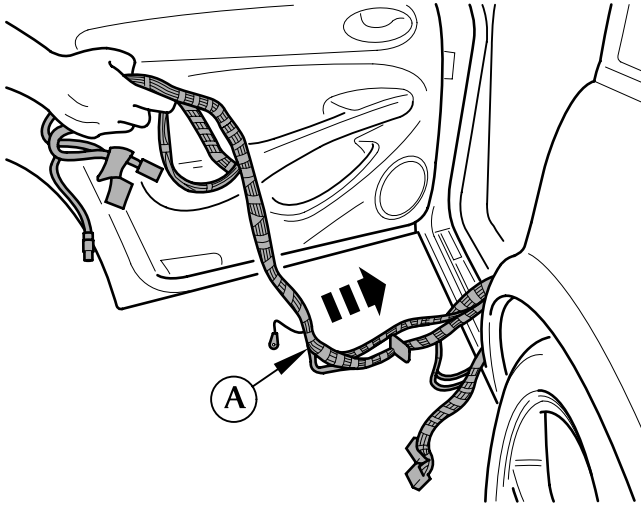

101

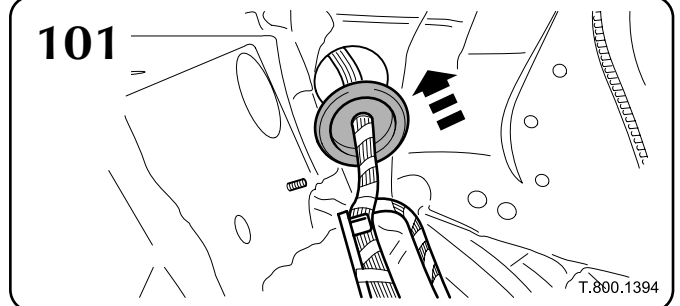

102

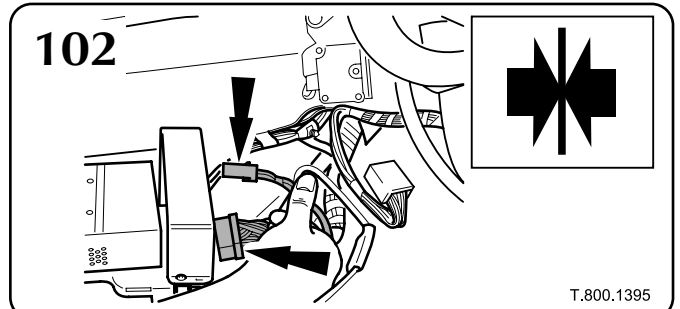

103

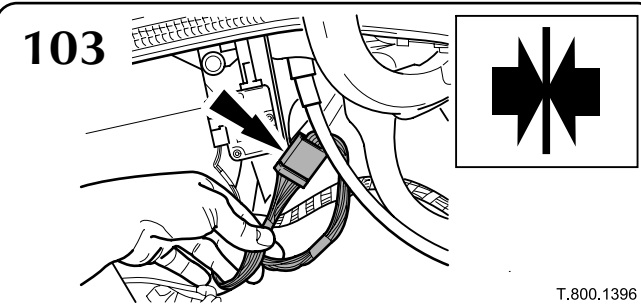

104

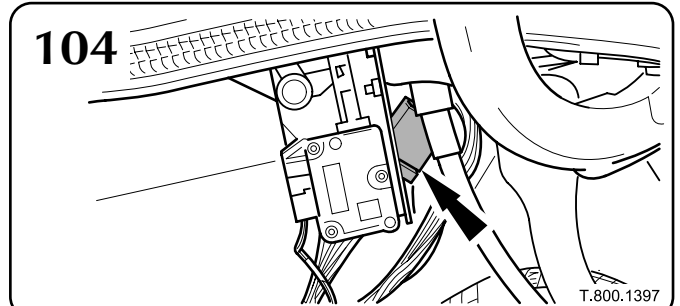

105

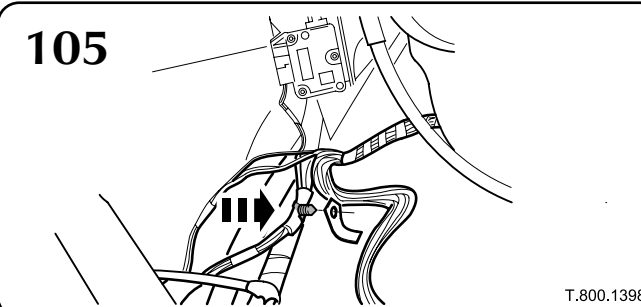

106

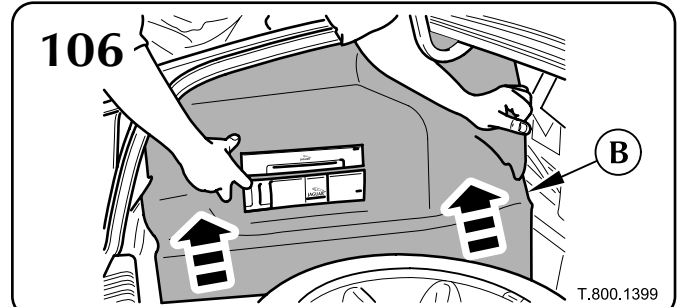

107

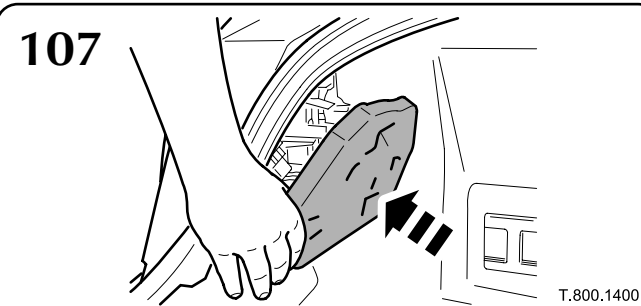

108

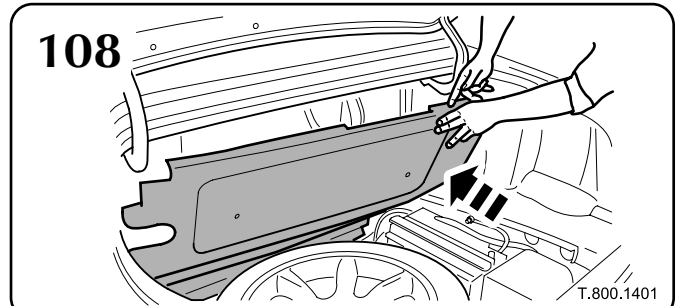

V8 XJ Series
(NAS vehicles only)

Navigation System

109

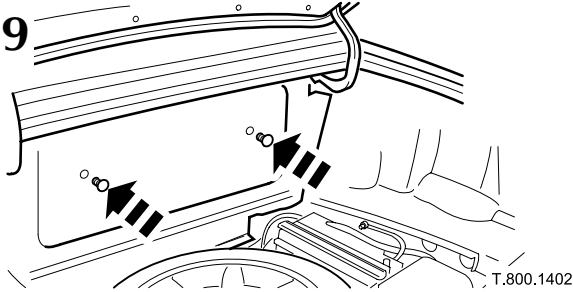

T.800.1402

110

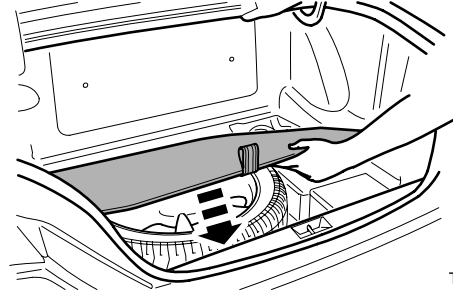

T.800.1403

111

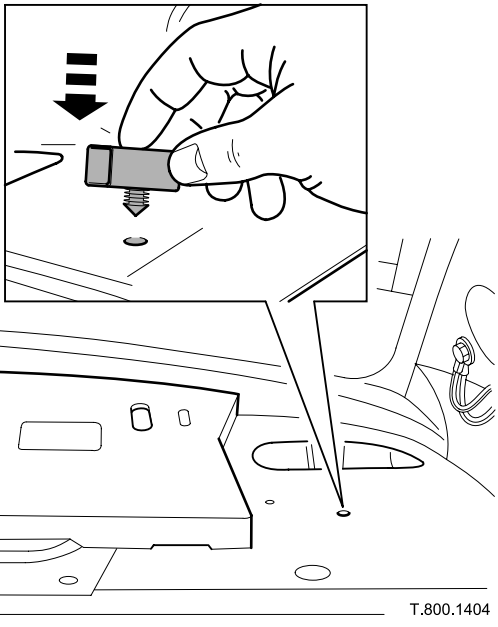

T.800.1404

112

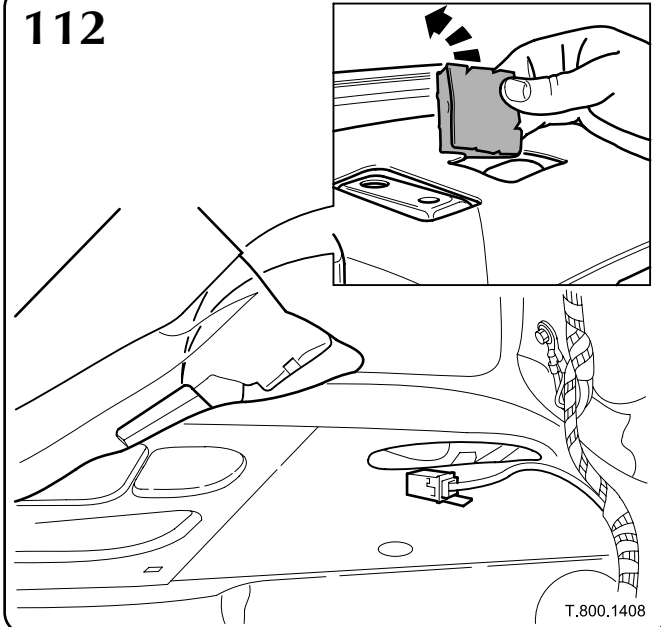

T.800.1408

113

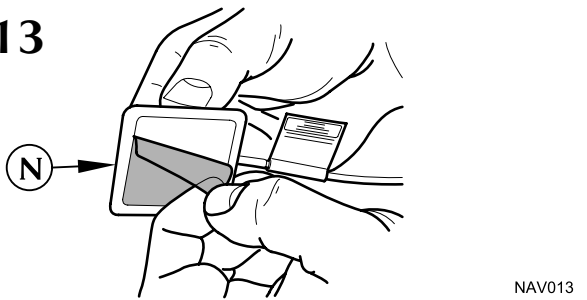

NAV013

Notes:

113. Remove adhesive protection on GSM antenna.

114

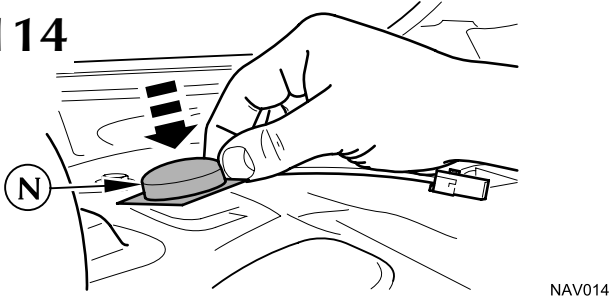

NAV014

Notes:

114. Position GSM antenna on parcel shelf below cut-out in insulation pad.

V8 XJ Series
(NAS vehicles only)

Navigation System

115

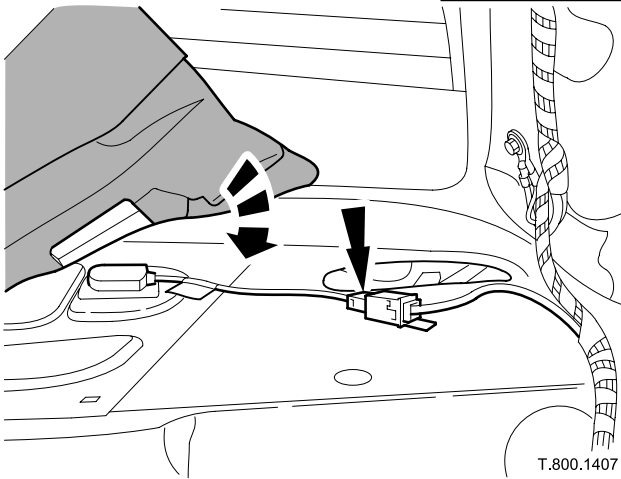
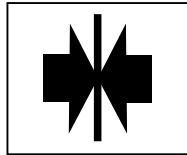

T.800.1407

116

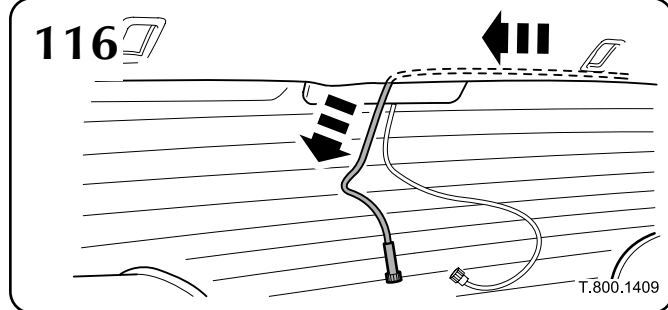

T.800.1409

117

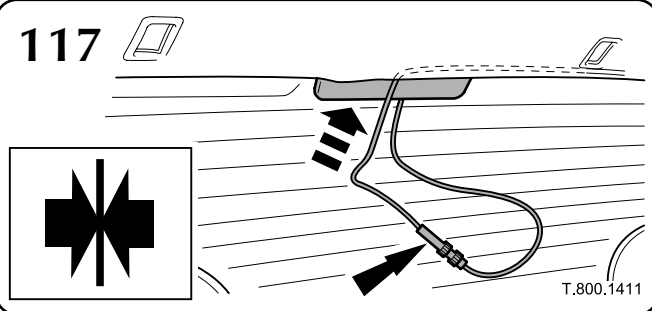

T.800.1411

118

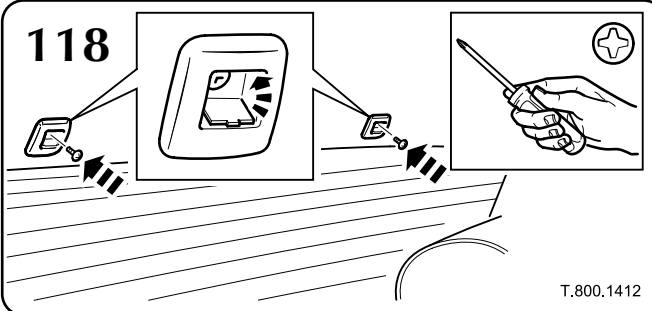

T.800.1412

119

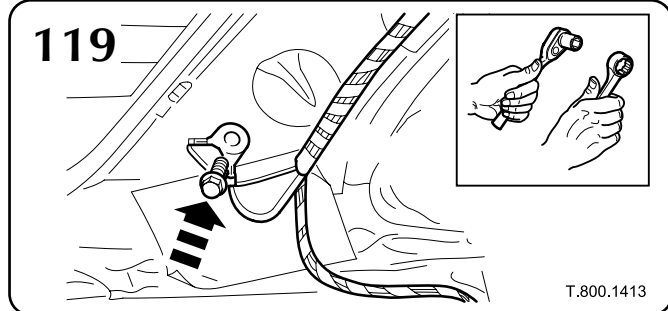

T.800.1413

120

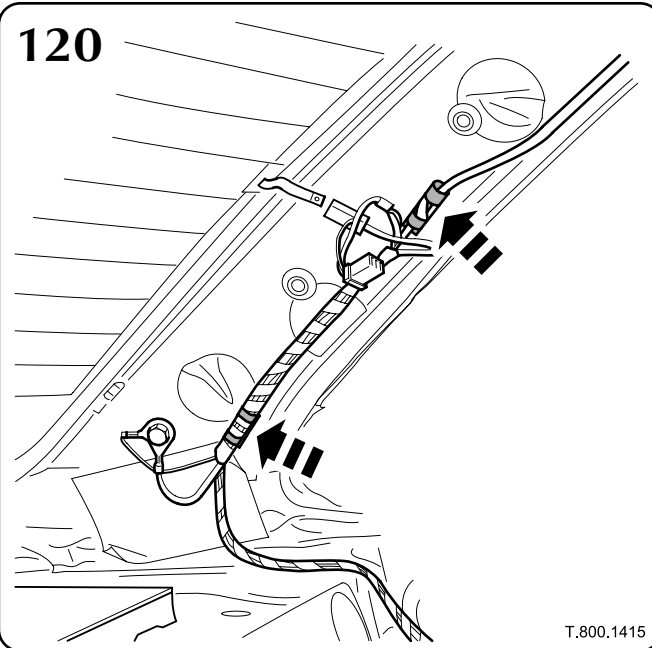

T.800.1415

121

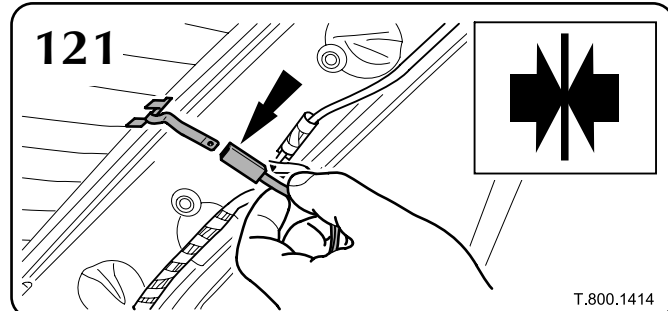

T.800.1414

122

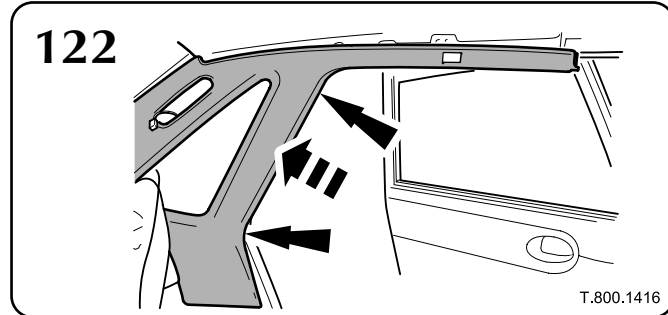

T.800.1416

MY 2001

Part No. **LNG3650FIT**

V8 XJ Series
(NAS vehicles only)

Navigation system – Système de guidage
Navigationssystem
Sistema di navigazione – Sistema de navegación

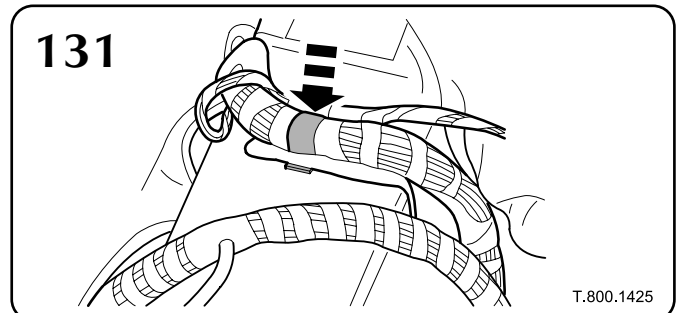
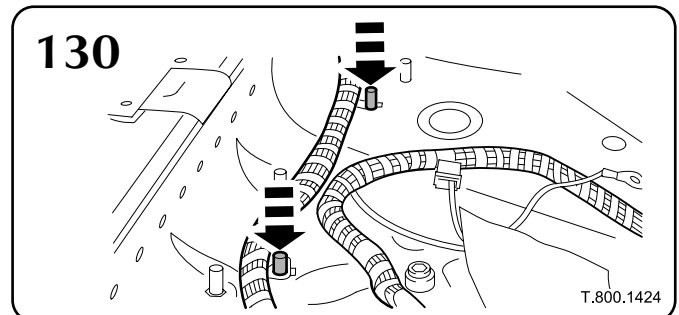
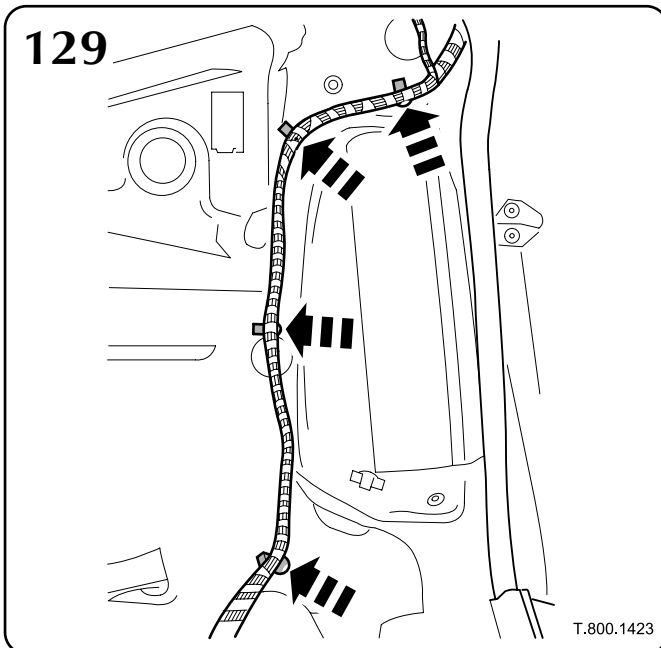
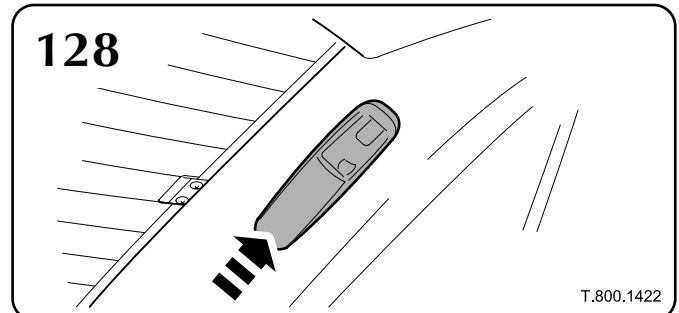
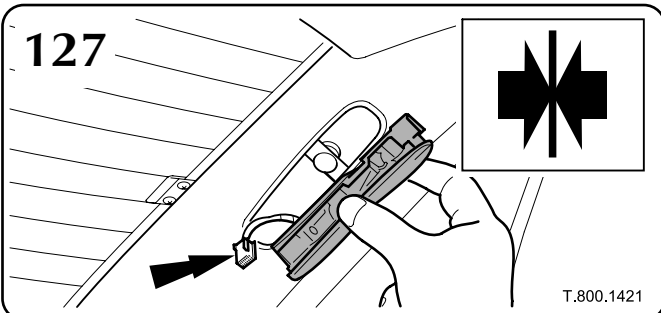
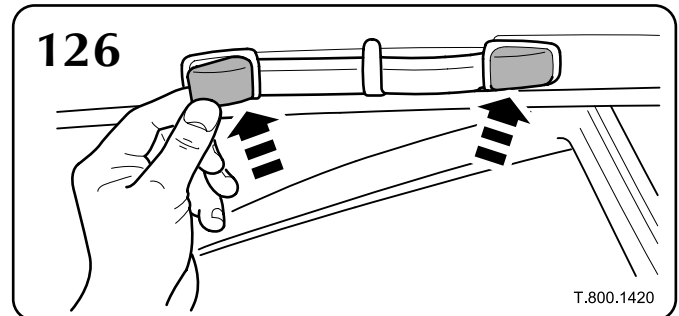
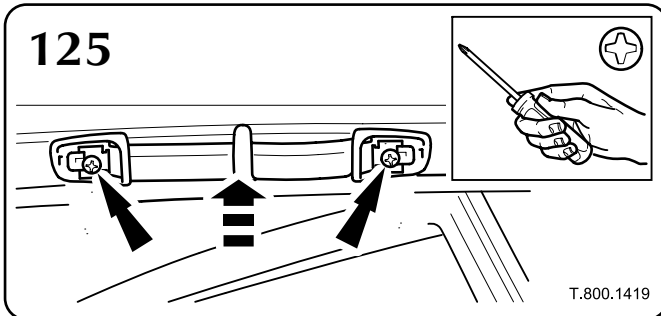
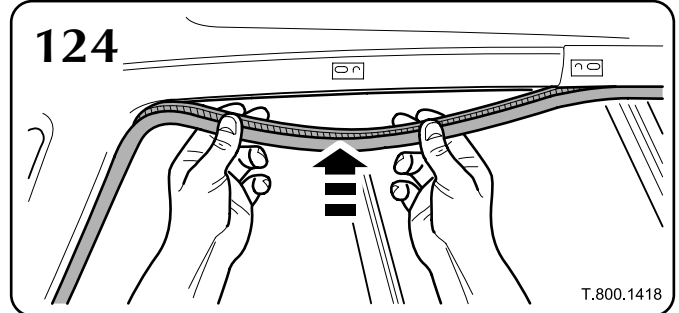
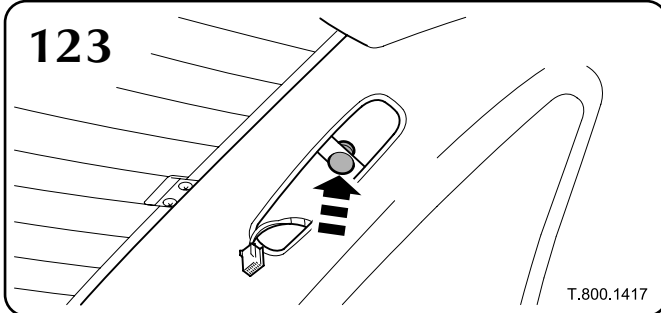

V8 XJ Series
(NAS vehicles only)

Navigation System

132

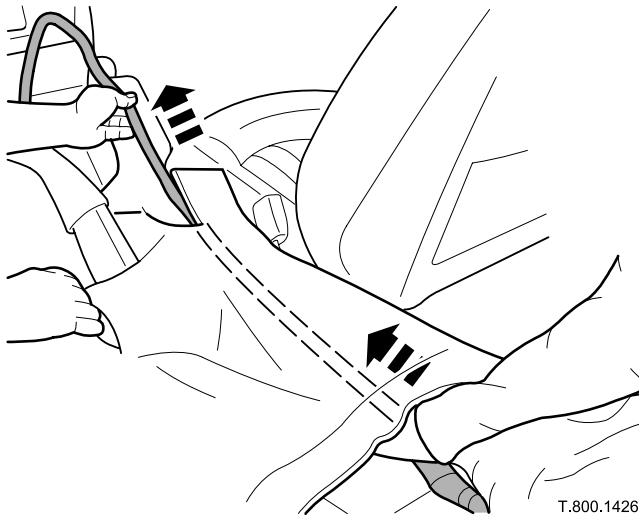

T.800.1426

133

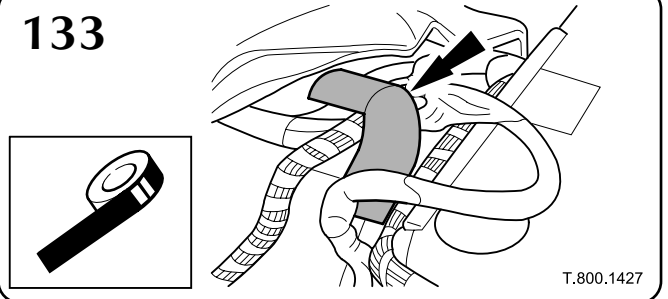

T.800.1427

Notes:

133. Secure harness with adhesive tape to rear of tunnel.

134

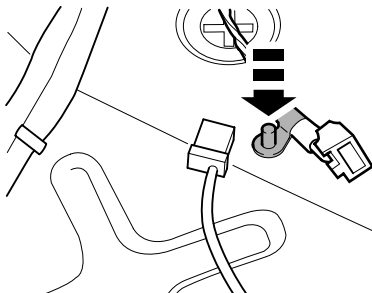

T.800.1428

135

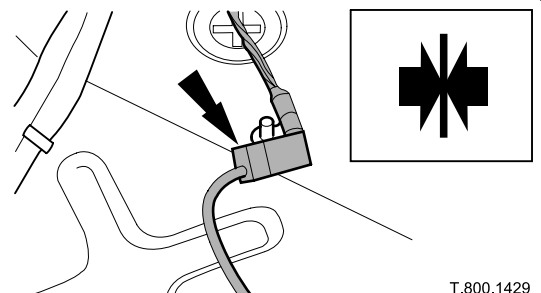

T.800.1429

Notes:

136. Re-connect handbrake switch.

136

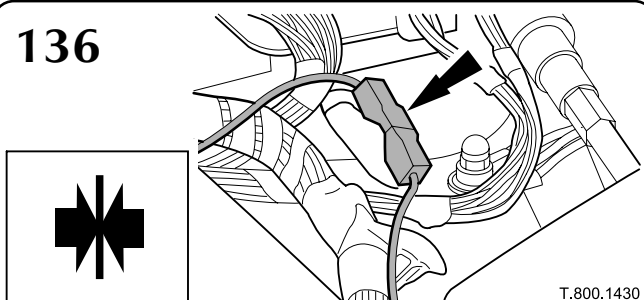

T.800.1430

137

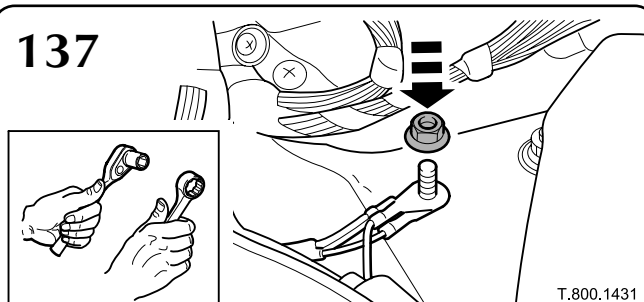

T.800.1431

Notes:

137. Refit earth lead.

MY 2001

Part No. **LNG3650FIT**

V8 XJ Series
(NAS vehicles only)

Navigation System

138

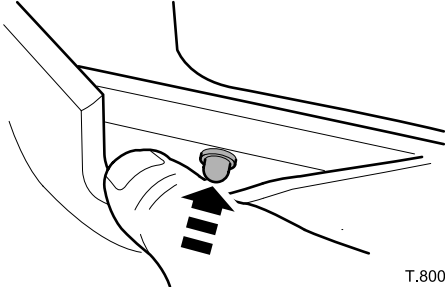

T.800.1332

Notes:

138. Refit harness clip to tunnel and reposition carpet.

139

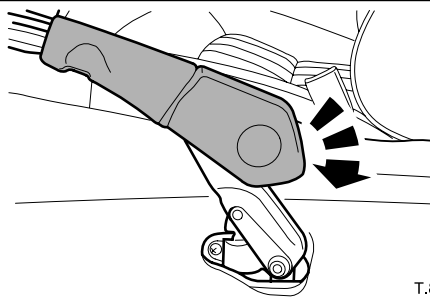

T.800.1434

140

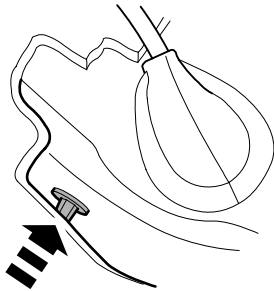

T.800.1435

Notes:

140. Refit harness clip to tunnel.

141

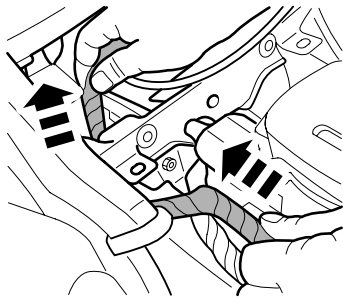

T.800.1436

142

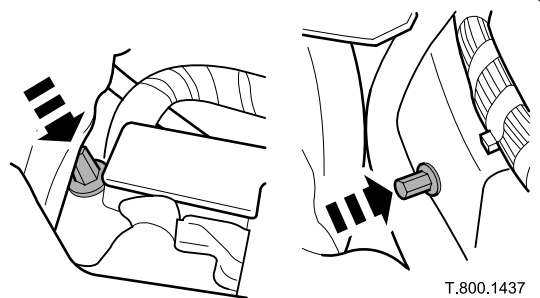

T.800.1437

143

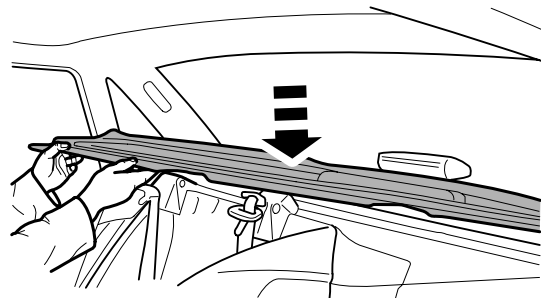
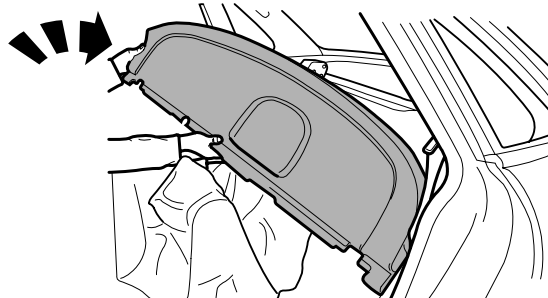

NAV010

MY 2001

Part No. *LNG3650FIT*

V8 XJ Series
(NAS vehicles only)

Navigation System

144

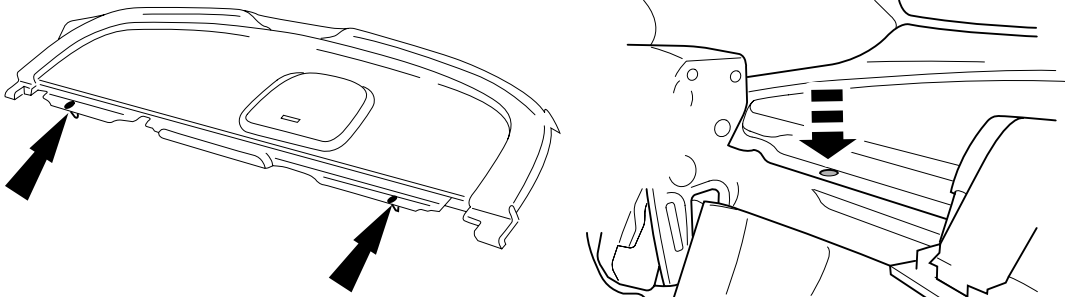

NAV011

145

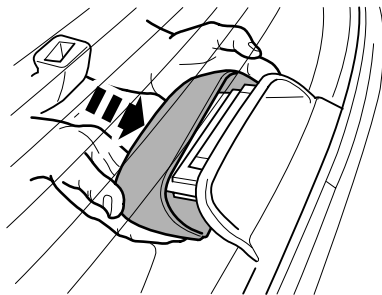

T.800.1441

146

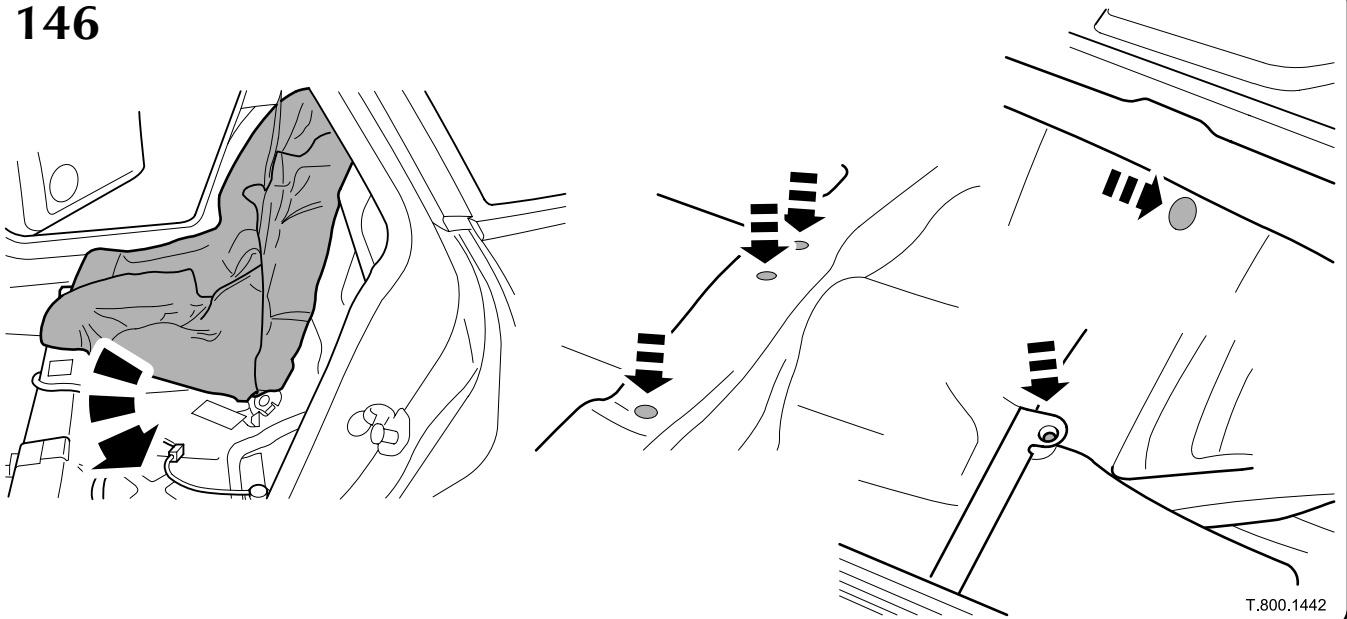

T.800.1442

147

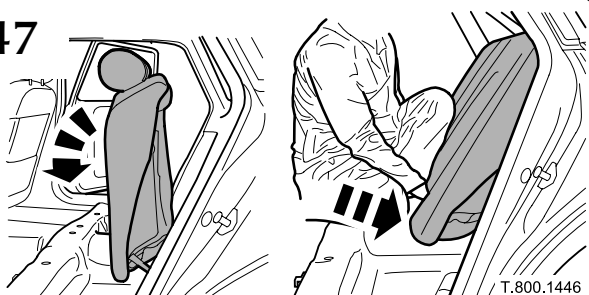

T.800.1446

148

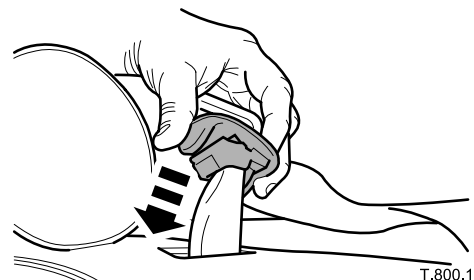

T.800.1448

MY 2001

Part No. **LNG3650FIT**

V8 XJ Series
(NAS vehicles only)

Navigation System

149

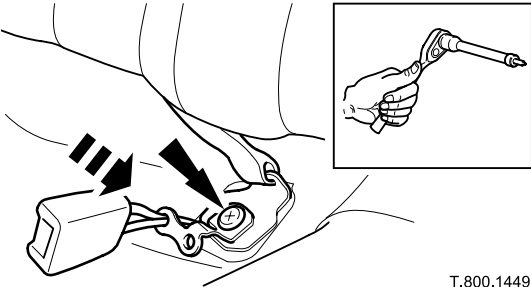

T.800.1449

Notes:

149. Refit seat belt anchor bolts.

150

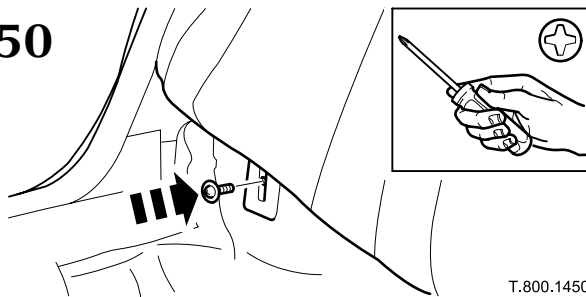

T.800.1450

151

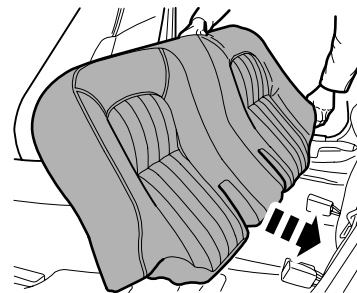

T.800.1451

152

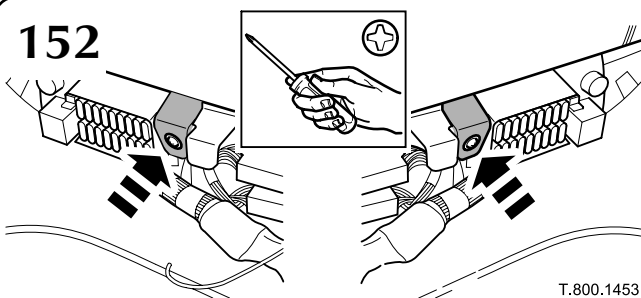

T.800.1453

Notes:

152. Refit heel boards and heel board securing screws.

153

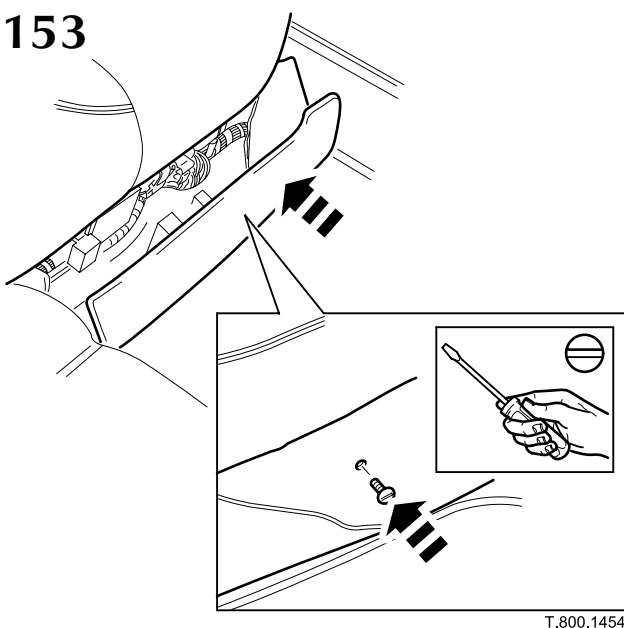

T.800.1454

154

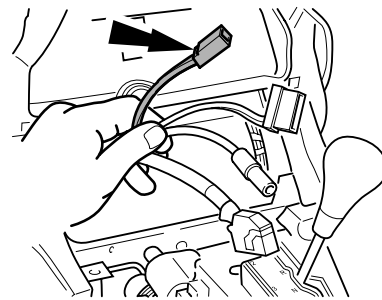

T.800.1455

Notes:

154. Locate navigation connector on harness.

V8 XJ Series
(NAS vehicles only)

Navigation System

155

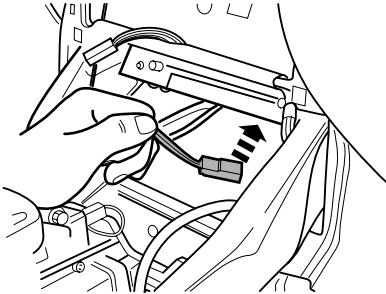

T.800.1456

Notes:

155. Feed navigation connector through aperture.

156

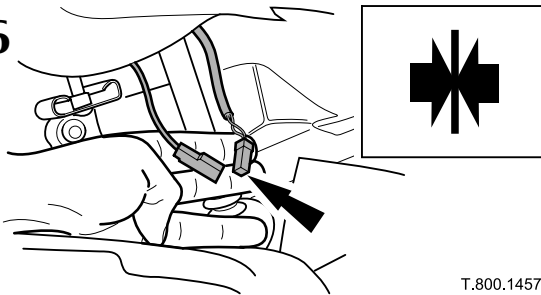

T.800.1457

Notes:

156. Locate facia harness plug and connect to navigation harness connector.

157

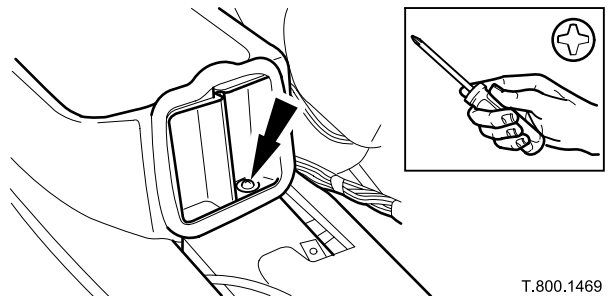
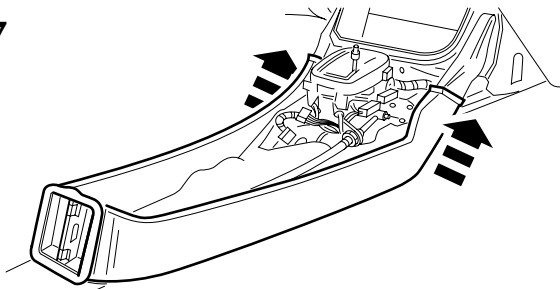

T.800.1469

158

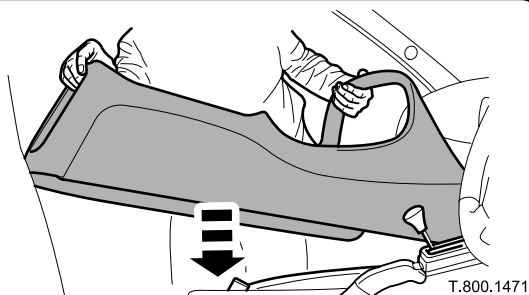

T.800.1471

159

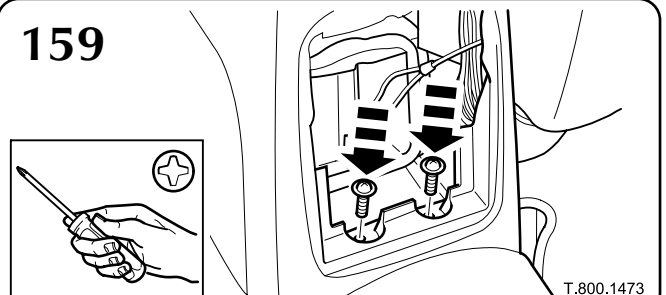

T.800.1473

160

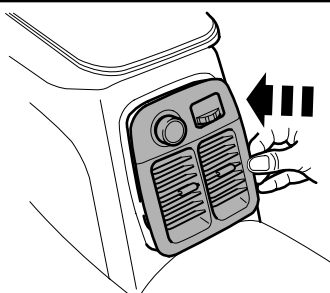

T.800.1475

161

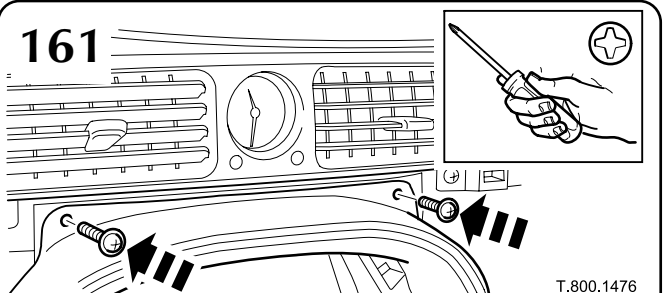

T.800.1476

MY 2001

Part No. *LNG3650FIT*

V8 XJ Series
(NAS vehicles only)

Navigation System

162

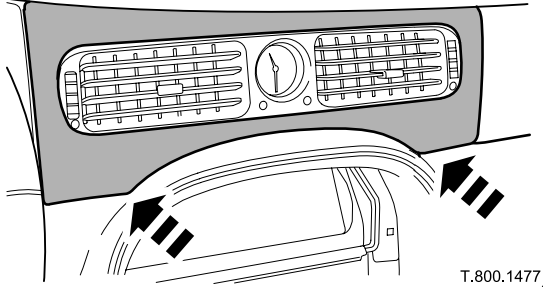

T.800.1477

163

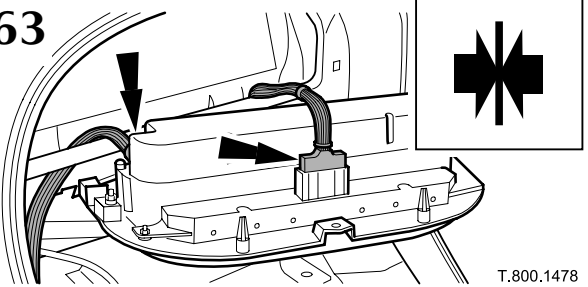

T.800.1478

164

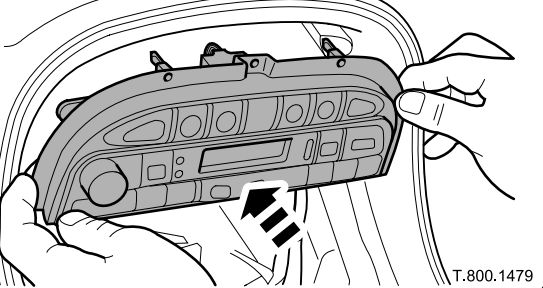

T.800.1479

165

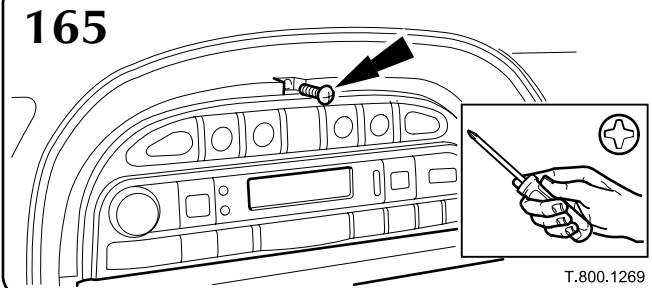

T.800.1269

166

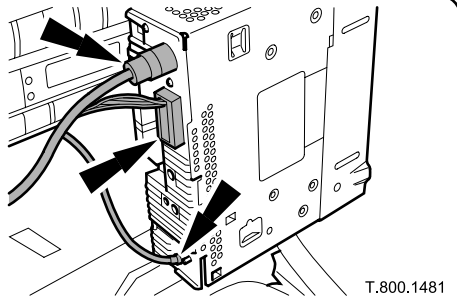
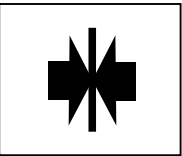

T.800.1481

167

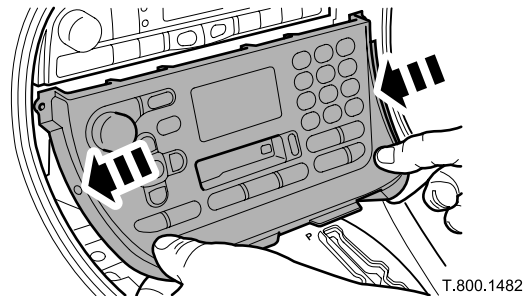

T.800.1482

168

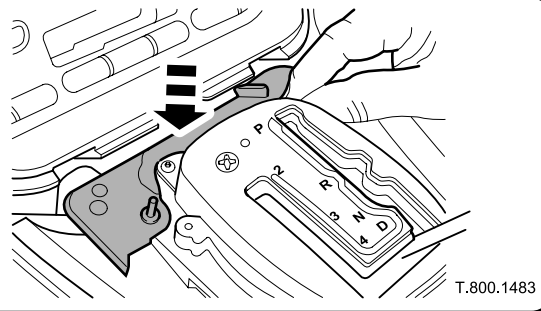

T.800.1483

169

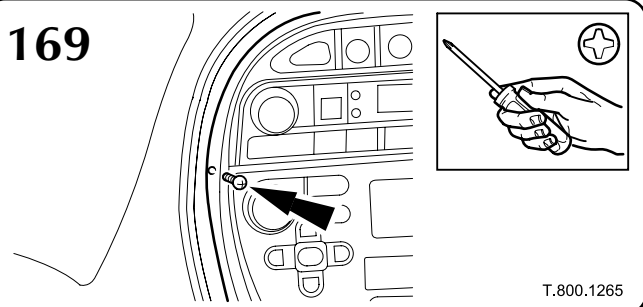

T.800.1265

Notes:

169. Refit 2 screws - LH and RH.

V8 XJ Series
(NAS vehicles only)

Navigation System

170

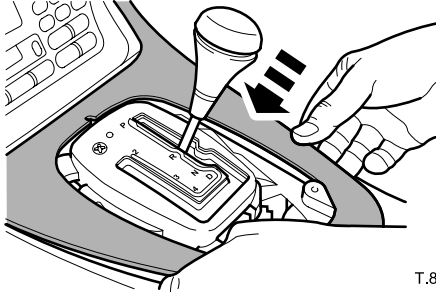

T.800.1485

171

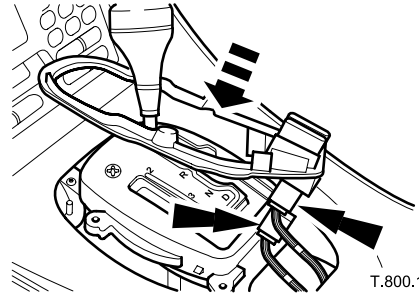
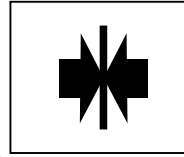

T.800.1486

172

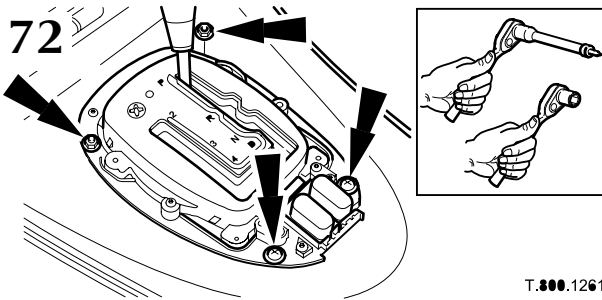

T.800.1261

173

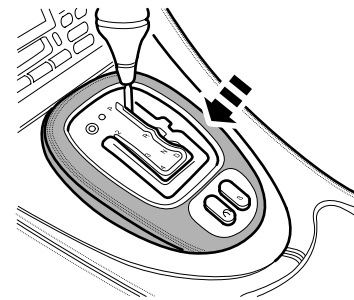

T.800.1489

174

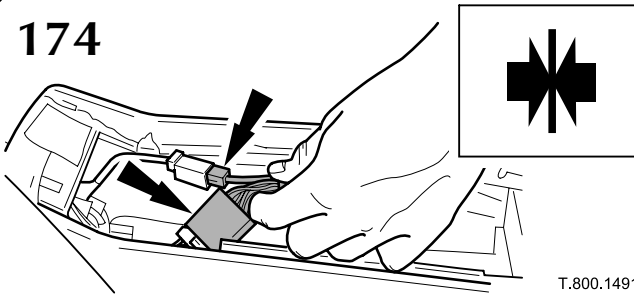

T.800.1491

Notes:

174. Locate the phone harness connectors and connect to the cup-holder assembly connectors.

175

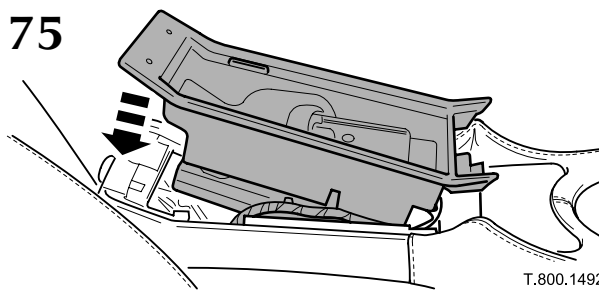

T.800.1492

176

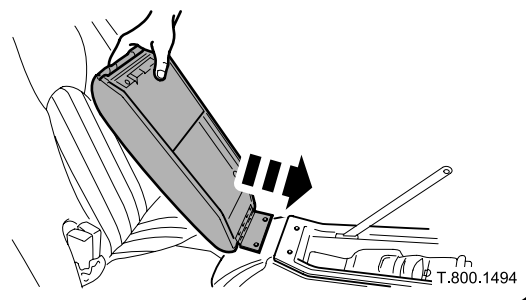

T.800.1494

177

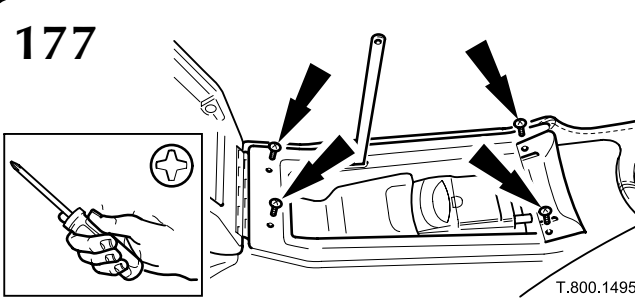

T.800.1495

178

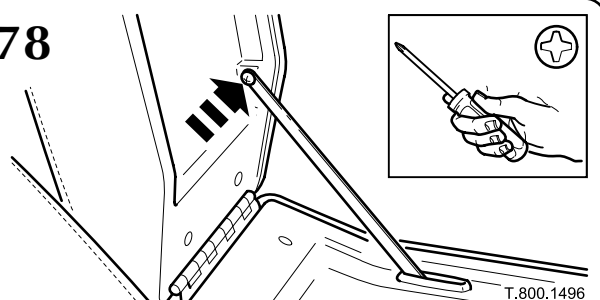

T.800.1496

MY 2001

Part No. **LNG3650FIT**

V8 XJ Series
(NAS vehicles only)

Navigation System

179

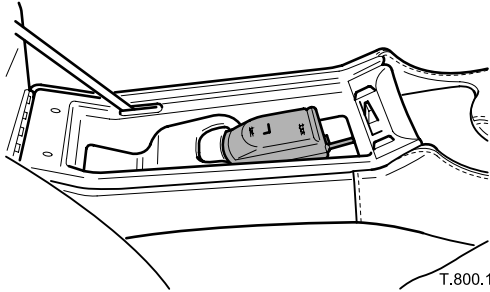

180

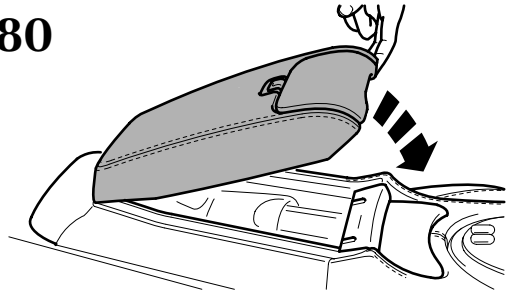

181

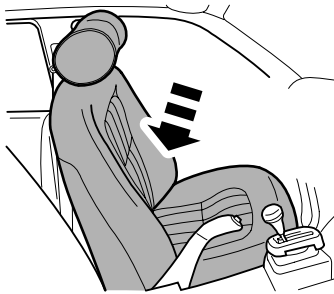

182

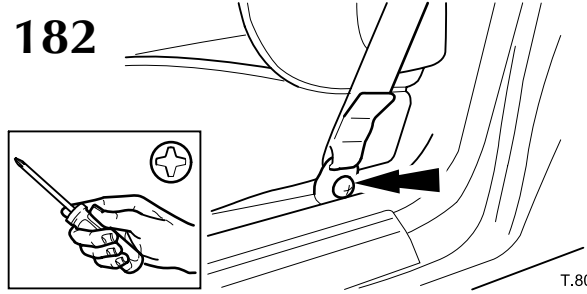

183

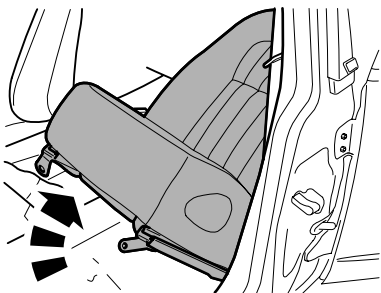

184

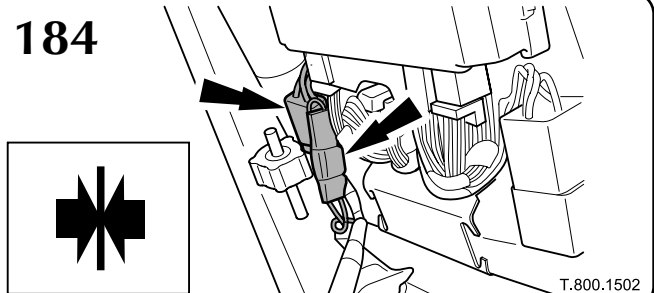

185

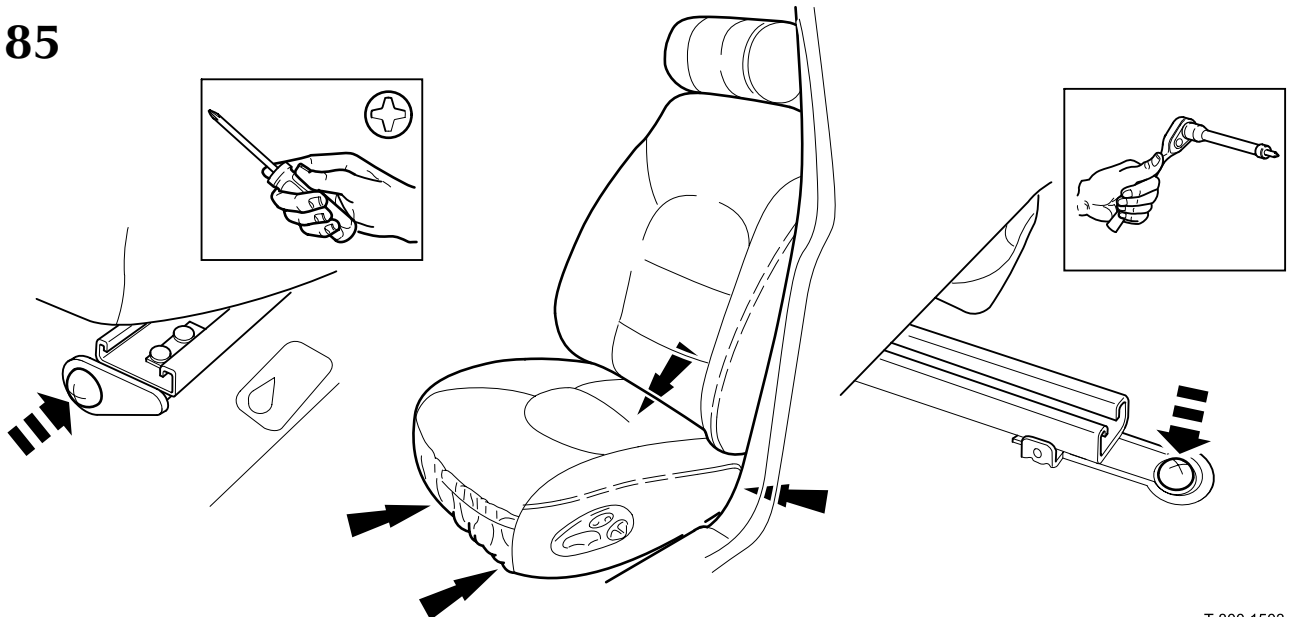

MY 2001

Part No. **LNG3650FIT**

V8 XJ Series
(NAS vehicles only)

Navigation System

186

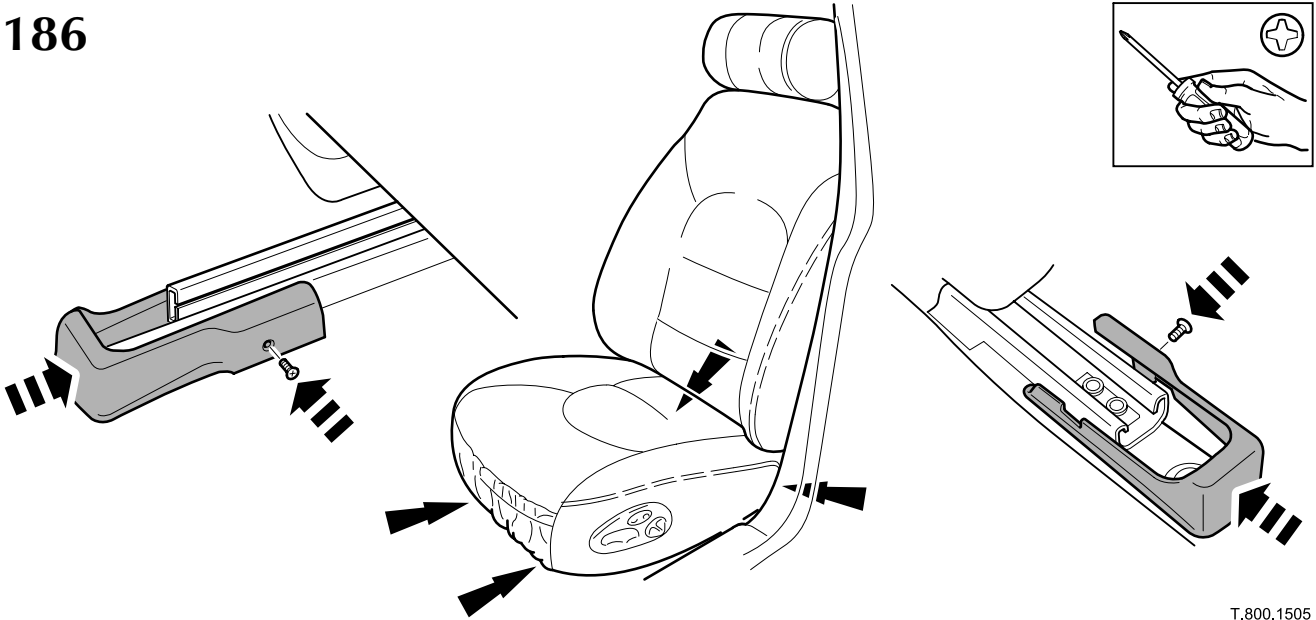

T.800.1505

187

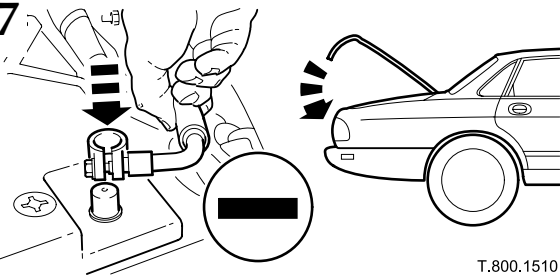

T.800.1510

188

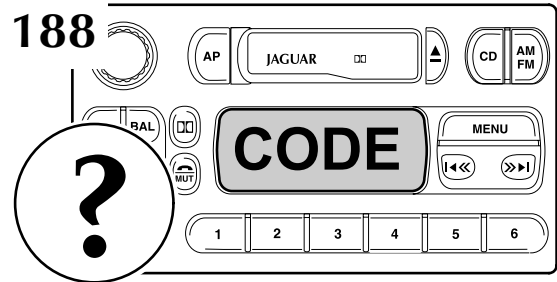

T.800.359

Notes:

188. Reset the radio code.