

Windows and Mirrors

ELECTRIC WINDOWS

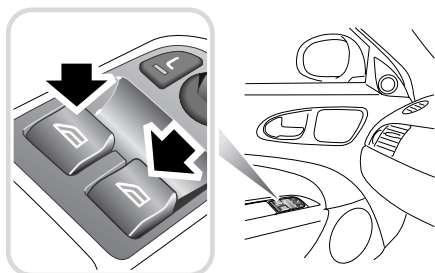

JAG0160L



WARNING:

- **Before operating power windows you should verify they are free of obstructions and ensure that children and or pets are not in the proximity of window openings. Failure to do so could result in serious personal injury. It is the primary responsibility of the supervising adults to never leave a child unattended in a vehicle.**
- **When raising windows ensure all occupants are clear.**
- **When leaving the vehicle take the ignition keys to prevent misuse of the window switches by remaining occupants, especially children.**

Switches on the driver's door controls both the driver and passenger door windows.

The passenger door is provided with a switch to control that door window only.

The ignition system must be ON to operate the windows.

These switches will only operate the windows for five minutes when the ignition switch remains in the **convenience mode** position and the driver's and passenger's doors remain closed.

Raise and lower

To lower a window, press and hold the front of the switch until the desired position is reached, then release.

To raise a window, pull up and hold the front of the switch until the desired position is reached, then release.

If the switches are held for longer than six seconds, for example, when attempting to overcome frozen or jammed windows, the window drive will be switched off for a few seconds to protect the window drive motors.

One-touch operation

Each window has a one-touch facility enabling the occupant to fully open or close the window in one quick movement.

Press the switch briefly to close or open the window in one movement. Window travel can be stopped at any time by pressing the switch again, but will then be controlled by pressing and holding the switch.

Automatic window drop for door opening

The frameless door windows create a seal against the convertible top or the roof seals. If fully raised, the door windows will drop partially when the door release lever is operated, this is to allow easy door opening. When the door is closed the windows rise to the fully closed position.

Windows and Mirrors

The doors must not be opened if power for automatic window drop is not available, e.g. with battery disconnected. However, in an emergency the doors can be opened with the windows fully up.

Window anti-trap protection



WARNING:

- **Careless closing of the windows can override the protection function and cause injuries.**
- **If the battery is disconnected or discharged the window anti-trap protection feature is lost. When the battery is reconnected or recharged the window anti-trap protection system must be reset.**

Each electrically operated window has a anti-trap protection feature. If the upward movement of the window detects an obstacle the anti-trap detection system will immediately stop the window closing, then move it downwards for a short distance.

Anti-trap protection override



WARNING:

While the window is being closed for the third time, the anti-trap detection function is disabled. Make sure there are no obstacles in the way of the closing window.

The anti-trap protection will also stop the window closing if a blockage or resistance occurs e.g. in the window guide channels.

Typically this might be due to icing in winter but could also be caused by damage or misalignment of the guide channels or seals.

- After the initial attempt to close the window and the anti-trap detection has initiated, operate the close switch a second time. This action must be carried out within ten seconds.
- The window will attempt to close again and operate the anti-trap detection. The window will now close again for the third time, but will only operate by pressing and holding the switch with the anti-trap detection disabled. The window will now close with full power. The icing in the seal can now be broken and dispersed.
- Repeat the override action until the window has closed. Each time the window stops, the switch must be operated immediately to initiate further override action.

If this procedure fails to move the blockage, the anti-trap detection feature will be lost and must be reset after the blockage has been cleared.

Reset window anti-trap protection

Ensure that the respective door is closed and, if fitted, the convertible roof closed.

- Fully close the window, then release the switch. Again pull the switch to close the window and hold for two seconds.
- Open the window fully and release the switch. Again press the switch to open the window and hold for two seconds.

Windows and Mirrors

- Check to confirm the operation by opening the window and then use one touch operation to close the window.
- Repeat for the remaining electrically operated windows.

Thermal overload

If the windows are repeatedly opened and closed (e.g. by a child), a protection system will de-activate window operation for a short period to avoid overheating of the window motors.

Caution: Do not close the door with the windows fully up as damage to the seals and the glass will occur.

Rear quarter window operation (Convertible only)

The rear quarter windows operate automatically in conjunction with convertible roof opening or closing.

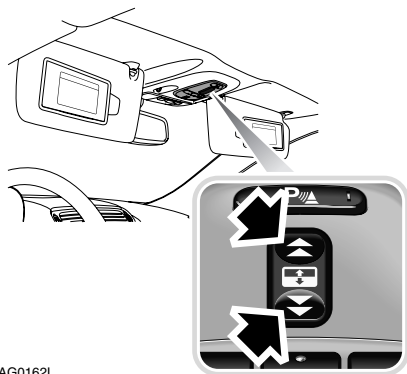

JAG0162L

The rear quarter windows may also be operated independently of the convertible roof when the convertible roof is closed, by means of the convertible roof switch on the overhead console, as follows:

To lower: Press the rear of the switch for less than a second and the rear quarter windows will be driven down fully.

To raise: Press the front of the switch and hold and the rear quarter windows will rise for as long as the switch is held.

Notes on rear quarter window operation:

1. When the convertible roof is opened the rear quarter windows are automatically lowered and cannot be operated until the roof is closed. When the roof is closed the rear quarter windows are automatically raised.
2. The rear quarter windows operate together and cannot be operated individually.

WINDOW TINTING

Caution: Do not have your vehicle windows tinted with a metal oxide tinting (for maximum heat reduction from the sun) if you have a telephone or navigation system fitted to your vehicle.

Metal oxide tinting prevents the reception of the Global Positioning System (GPS) signals by the antenna, causing the navigation system to stop functioning.

A nonmetal tinting should be used if you require window tinting and if in doubt, contact your Jaguar Dealer for advice.

Windows and Mirrors

ELECTRIC EXTERIOR MIRRORS

Caution: The right-hand mirror is convex, providing a wider field of vision. As a result, objects viewed in the mirror are closer than they appear.

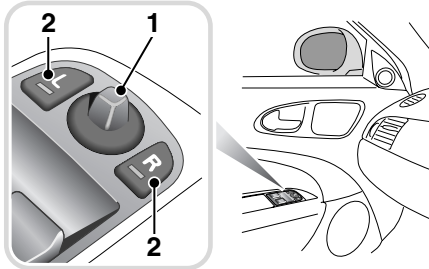

JAG0041L

Both electrochromic door mirrors are adjusted from the driver's door switchpack.

The four-way adjustment button **1** moves the mirrors to the required position. The selector button **2** selects the mirror to be moved, **L** for the left-hand side mirror and **R** for the right-hand side mirror.

The mirror housings are designed to pivot against the vehicle upon impact.

Caution: If door mirrors have been folded against the vehicle due to an impact, reposition the mirrors manually.

Mirror heating

Caution: Do not use a scraper to remove ice from the mirrors as this will damage the surface.

The door mirrors have heating elements which operate automatically based on the external ambient temperature of the vehicle. The mirror heater will clear all ice from the mirror surface.

Mirror dip when reversing

Reverse mirror dipping is selected via the touch-screen.

From the main **Home** touch-screen menu, select **Vehicle**:

- Select **Veh. settings**.
- The **Security** button is selected automatically as the default.

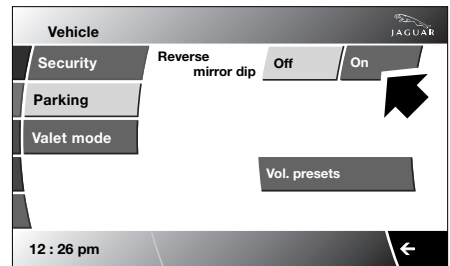

JAG0165NAS

- Select **Parking**.
- Select **Reverse mirror dip ON**.

When reverse gear is selected, the passenger mirror inclines downwards to provide a close up view of the rear side area. When the gear selector is moved out of reverse, the mirror will return to its original position.

Windows and Mirrors

The reverse mirror dip alignment can be adjusted by using the four-way adjustment button **1** when the mirror has completed movement to its reverse dip position. This new selected position is maintained until re-adjusted

Note: When reversing, if a speed of greater than 7 km/h (4 mph) is achieved, then the mirrors will revert to the previous position. However, if the speed is then reduced to below 7 km/h (4 mph), then the mirrors will revert to the dipped position.

- *The automatic darkening of the mirror will not operate properly if the light that would otherwise strike the mirror is obstructed.*

INTERIOR MIRROR

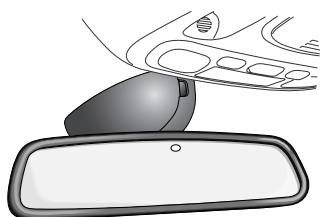

JAG0168L

During night time driving with the ignition switched on, the interior mirror will darken automatically in proportion to the amount of glare detected from a following vehicle's headlights.

When you shift the gear selector lever into reverse, the interior mirror dimming feature will be automatically switched off for a clearer view whilst reversing.

Note:

- *Should a mirror assembly become detached from the windshield, it must be refitted by a Jaguar Dealer.*
- *Ensure that the windshield in front of the mirror is kept clean. Where fitted, the moisture sensor for wiper operation is located to the front of the mirror casing. Any dirt may affect the operation of this sensor.*