

# Rear Quarter Window Glass - 2-Door (76.31.31)

## Removal

- 1 . Release the door aperture seal.
  - ▶ Release from the 2 clips.
- 2 . Remove the rear quarter window glass.
  - ▶ Remove the bolt.

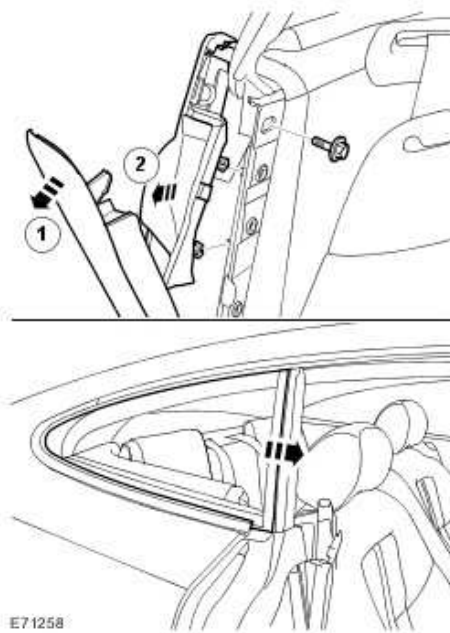

## Installation

- 1 . Install the rear quarter window glass.
  - ▶ Tighten the bolt to 10 Nm (7 lb.ft).
- 2 . Attach the door aperture seal.
  - ▶ Release from the 2 clips.
  - ▶ Secure in the clips.