

## Exterior Lighting

### Front Lamps

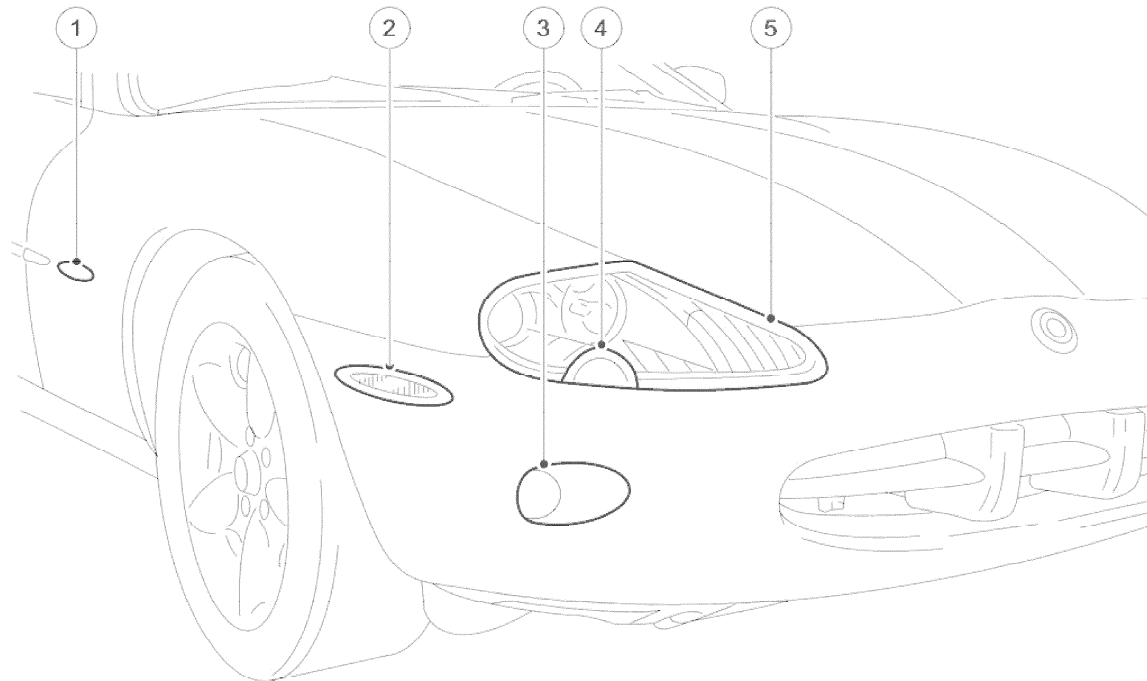

E39225

Item	Description
1	Side turn signal lamp
2	Front side marker lamp/reflector
3	Front fog lamp
4	Headlamp washer jet
5	Headlamp assembly

The headlamp assembly incorporates a high beam lamp, a low beam lamp, a front turn signal lamp, a side lamp, a headlamp washer jet and a headlamp leveling motor. Vehicles with high intensity discharge (HID) headlamp also incorporate a ballast and leveling module. Access for bulb replacement is from the engine compartment except for the dipped beam bulb, which is accessible through a panel in the wheelarch liner.

The fog lamps are located in the front bumper and retained by three screws. Access for bulb replacement is through the opening panel in the wheelarch liner. The lamps are not interchangeable, because of the orientation of the fixing holes and shape of the glass.

The front side marker lamps (if equipped) incorporate a reflector and are retained by a spring clip at each end of the lamp unit. In markets where they are not specified, a reflector is fitted.

The side turn signal lamps (if equipped) are retained by a spring clip at each end of the lamp unit.

The headlamps are operated by the left-hand steering column multifunction switch. The steering column multifunction switch also operates the side lamps, high beam lamps, auto mode and the turn signal lamps.

### Rear Lamps

## 2004 XK RANGE - Exterior Lighting - 417-01

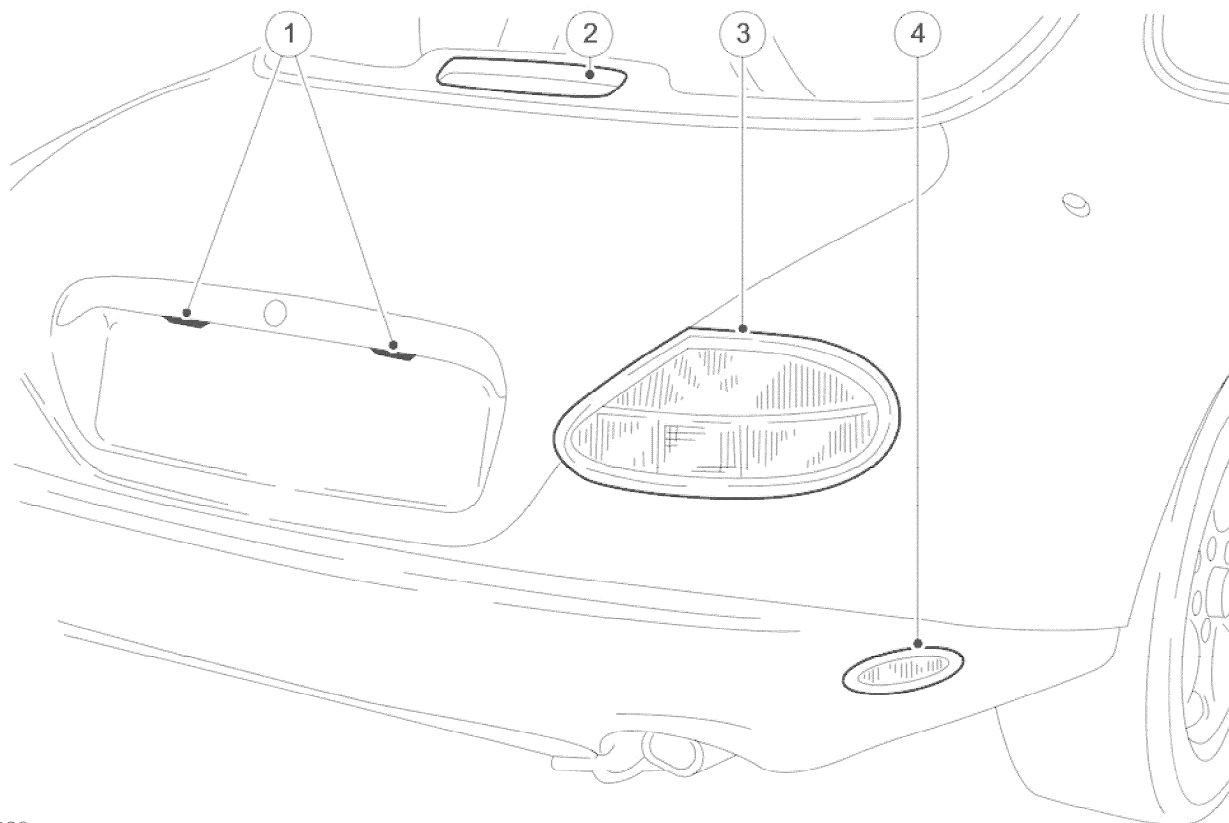

E39226

Item	Description
1	License Plate Lamps
2	High Mounted Stop Lamp
3	Rear Lamp Assembly
4	Rear side marker lamp/reflector

The rear side marker lamps (where fitted) incorporate a reflector and are secured by a spring clip at each end of the lamp unit. In markets where they are not specified, a reflector is fitted.

Each rear lamp assembly incorporates a stop lamp, a side lamp, a fog lamp, a reversing lamp and a turn signal lamp. Access for bulb replacement is from the luggage compartment.

The license plate lamps are located on a trim finisher panel, secured to the luggage compartment lid by four nuts. Each bulb is accessible after removing the relevant lens by releasing the retaining tang.

A High Mounted Stop Lamp (if equipped) is fitted inside the rear screen on coupe models (as shown above) and externally, on the luggage compartment lid, on convertible models. These lamps operate using sixteen LEDs instead of conventional bulbs. Individual LEDs cannot be replaced; the complete lamp unit must be renewed if one LED is inoperative.

### High Intensity Discharge (HID) Lamps

## 2004 XK RANGE - Exterior Lighting - 417-01

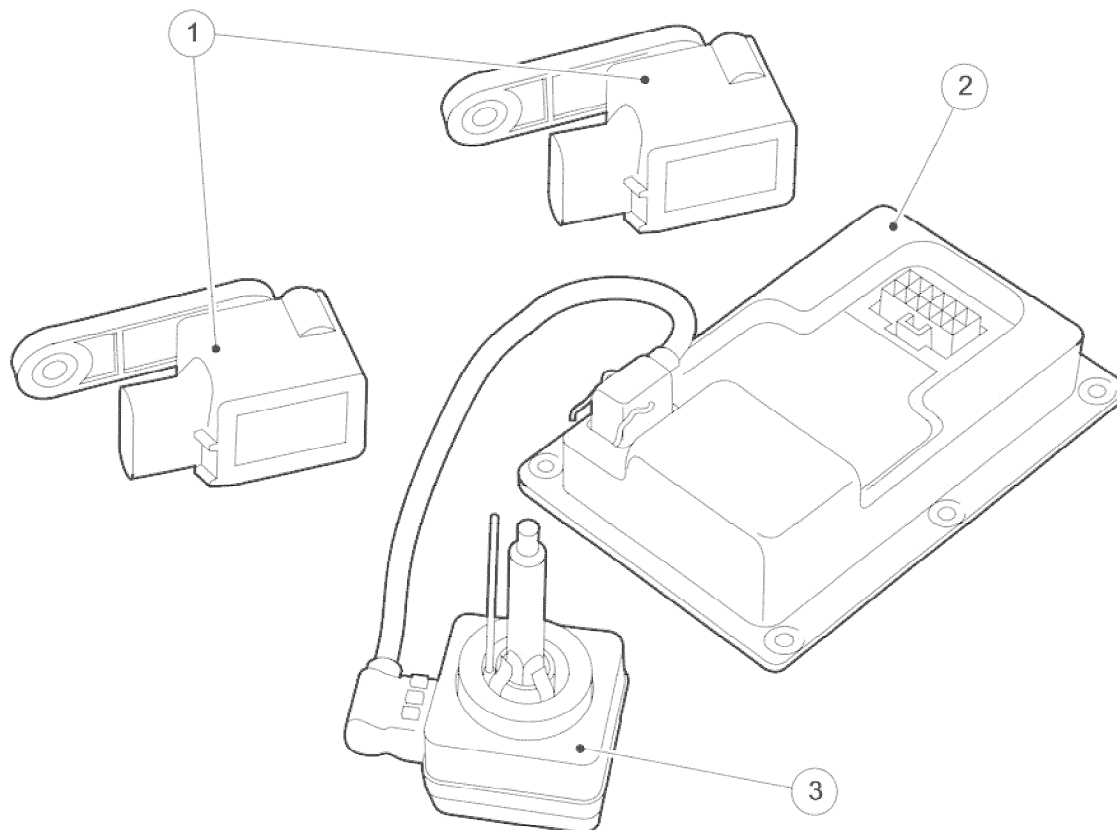

E39236

Item	Description
1	Headlamp leveling sensor
2	Ballast and headlamp leveling module
3	Low beam headlamp bulb

The ballast has an integrated automatic levelling module which receives electrical inputs from the vehicle height sensors and outputs a signal to the levelling motor, as well generating a 1 kv voltage to the HID light source. A single wire bus is used to transmit the signals from the two vehicle height sensors. The high luminous flux provided by the HID system significantly improves long distance visibility. The increased beam width and consistency of the beam also provides better illumination of the side of the road. While HID bulbs last considerably longer than halogen bulbs, there are several characteristics that indicate that a bulb is approaching the end of its service life. These symptoms are characterized by low light output and/or intermittent illumination. Visual signs include blackening at the ends of the arc tube and electrode tip deterioration.

### NOTE:

If a headlamp leveling sensor, a ballast leveling module, or a headlamp are to be renewed, the system must be initialized. For additional information, refer to the Jaguar Approved Diagnostic System.

The HID bulbs contain metals, including mercury, that are harmful to the environment. Dispose of used HID bulbs whilst complying to local health and safety standards.