

Air Distribution and Filtering

Air Distribution

Outside air enters the plenum via two inlets in the lower finisher at the base of the windshield.

If the air conditioning system is operating in FRESH mode (not recirculation mode), then air is drawn through an air particle filter (where fitted) and into the air conditioning unit via the blower interconnecting ducts in the LH and RH blower assemblies. Air is cooled and dehumidified as it passes through the evaporator and is then 'reheated' to the required temperature as it passes through the heater matrix.

In RECIRCULATION mode, the air in the passenger compartment is drawn into the air conditioning unit via the recirculation air inlets on the blower assemblies.

In FRESH mode, air flows from the cabin into the trunk via extraction slots in the rear parcel shelf at the base of the backlight on the Coupe and the hood containment panel on Convertible. The air is exhausted from the vehicle through extraction vent assemblies (incorporating one way flaps) whose outlets are above the rear mufflers.

Air Flow Path

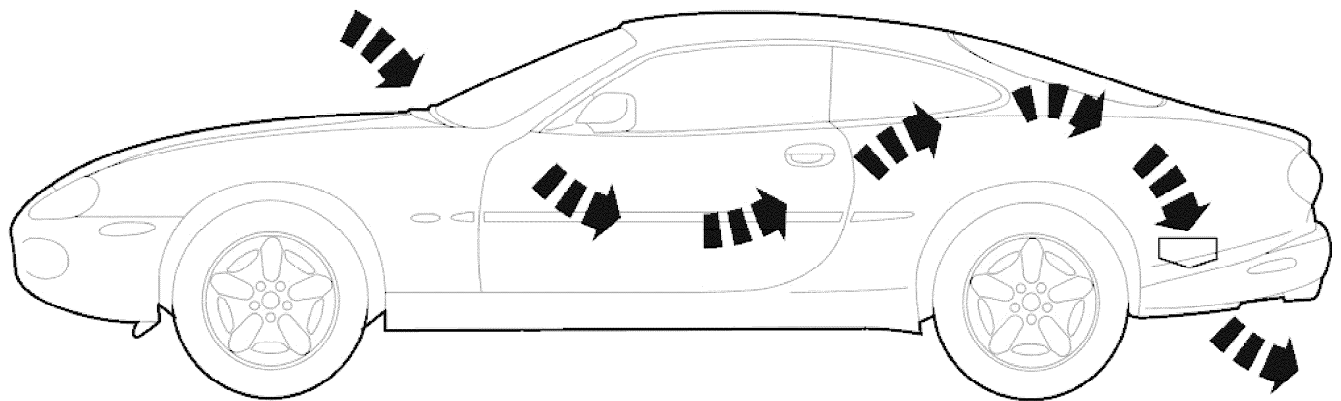

E34325

Air Distribution Modes

Bi-level mode. Minimum temperature differential.

2001 XK RANGE - Air Distribution and Filtering - 412-01

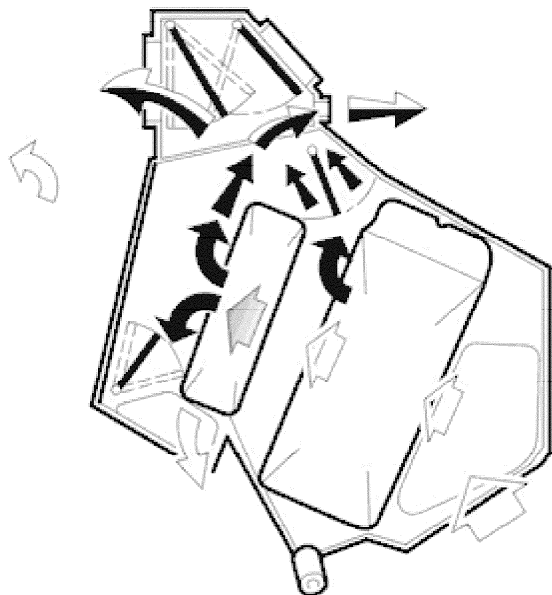

E34312

Bi-level mode. Maximum temperature differential.

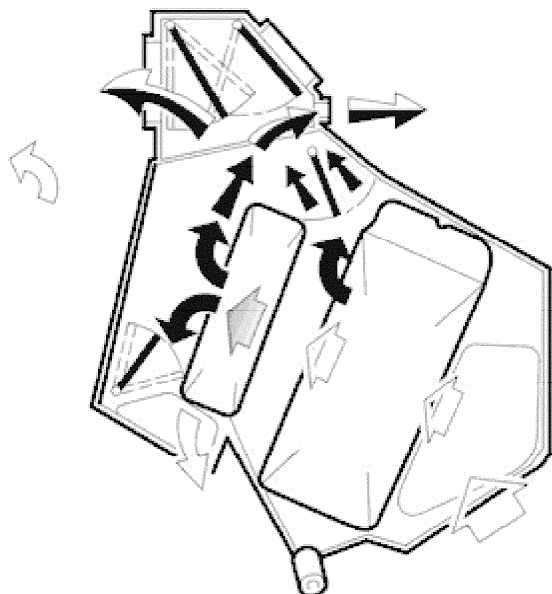

E34312

Foot / defrost mode.

2001 XK RANGE - Air Distribution and Filtering - 412-01

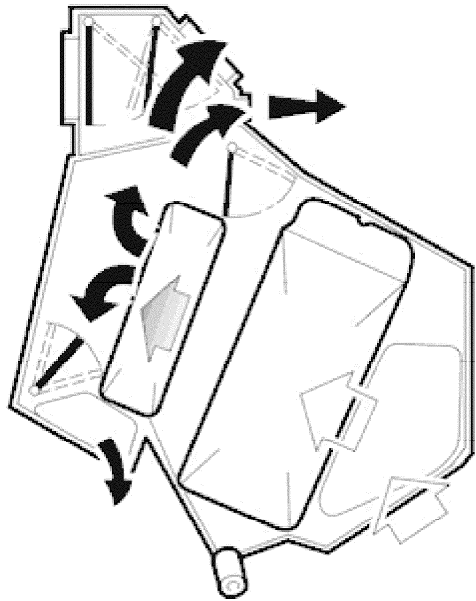

E34313

Face mode.

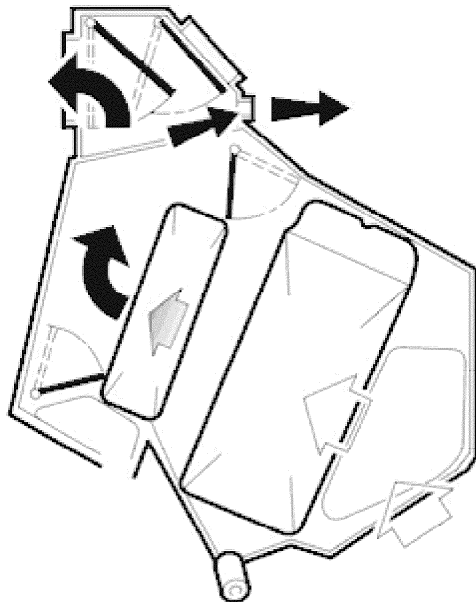

E34314

Defrost mode.

2001 XK RANGE - Air Distribution and Filtering - 412-01

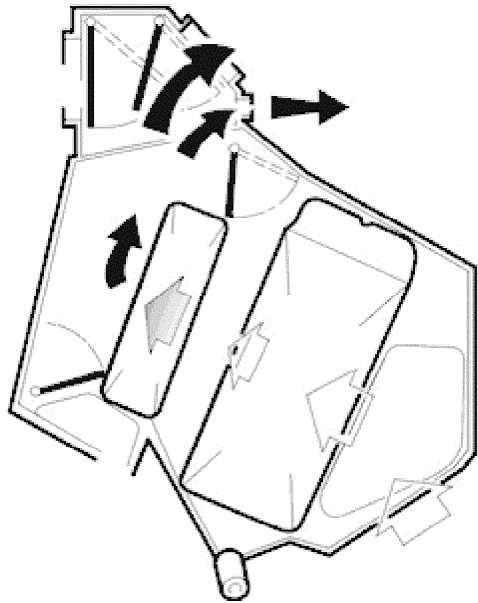

E34315
Foot mode.(with automatic air bleed to the windshield)

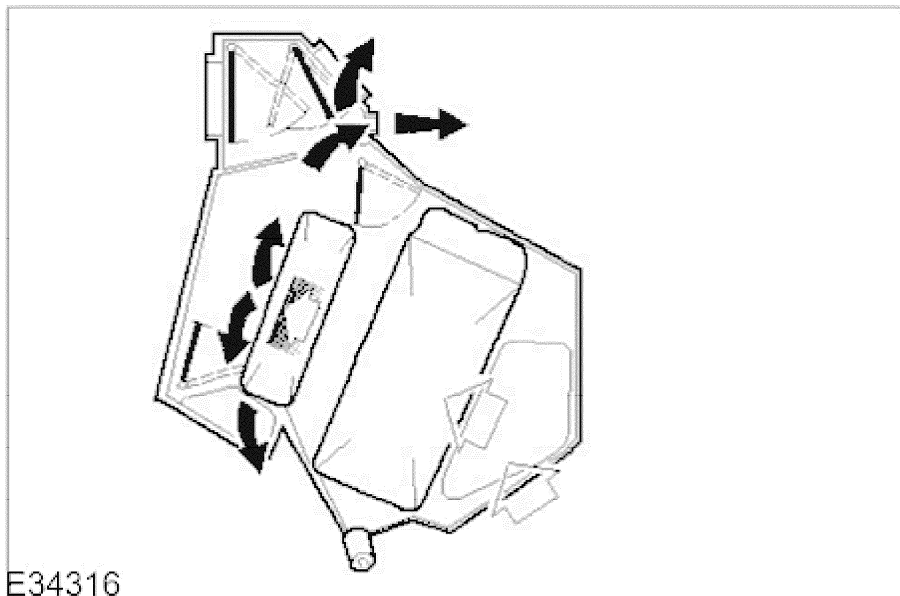

Air Particle Filter (Rain deflector removed for clarity)

2001 XK RANGE - Air Distribution and Filtering - 412-01

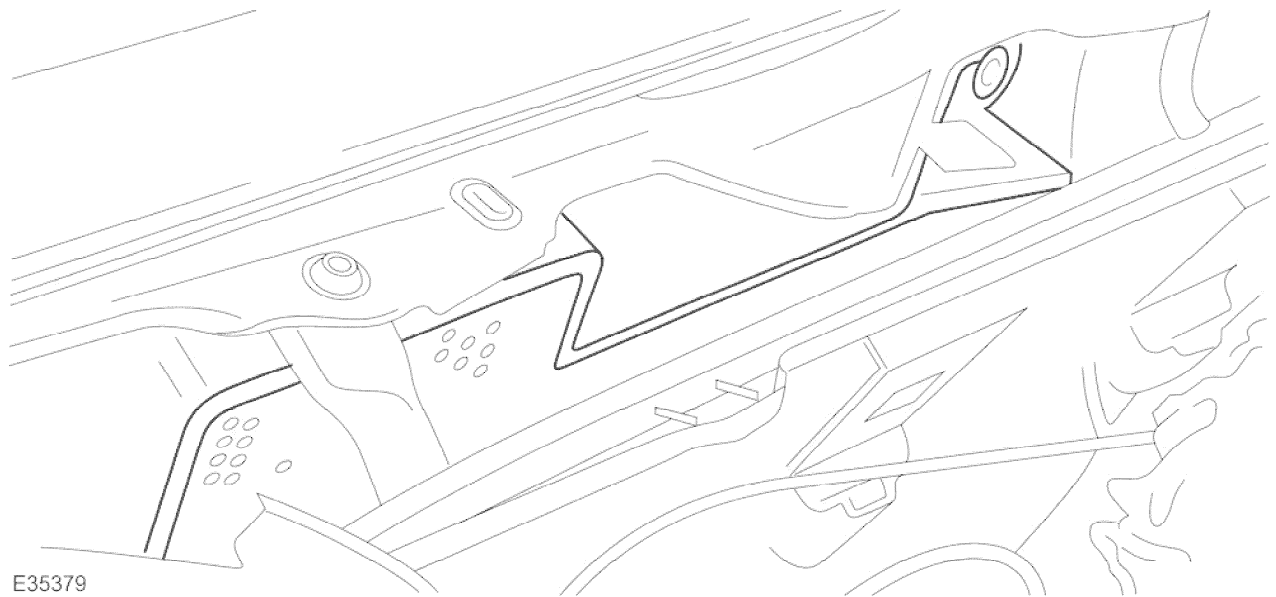

The air particle filter system (where fitted) is located in the 'wet' plenum below the windshield finisher.

The filter element is retained by clips which are moulded onto the filter housing. Please note that the filter must be fitted with the light, flocked surface, towards the engine.

LADD and Footwell Ducts

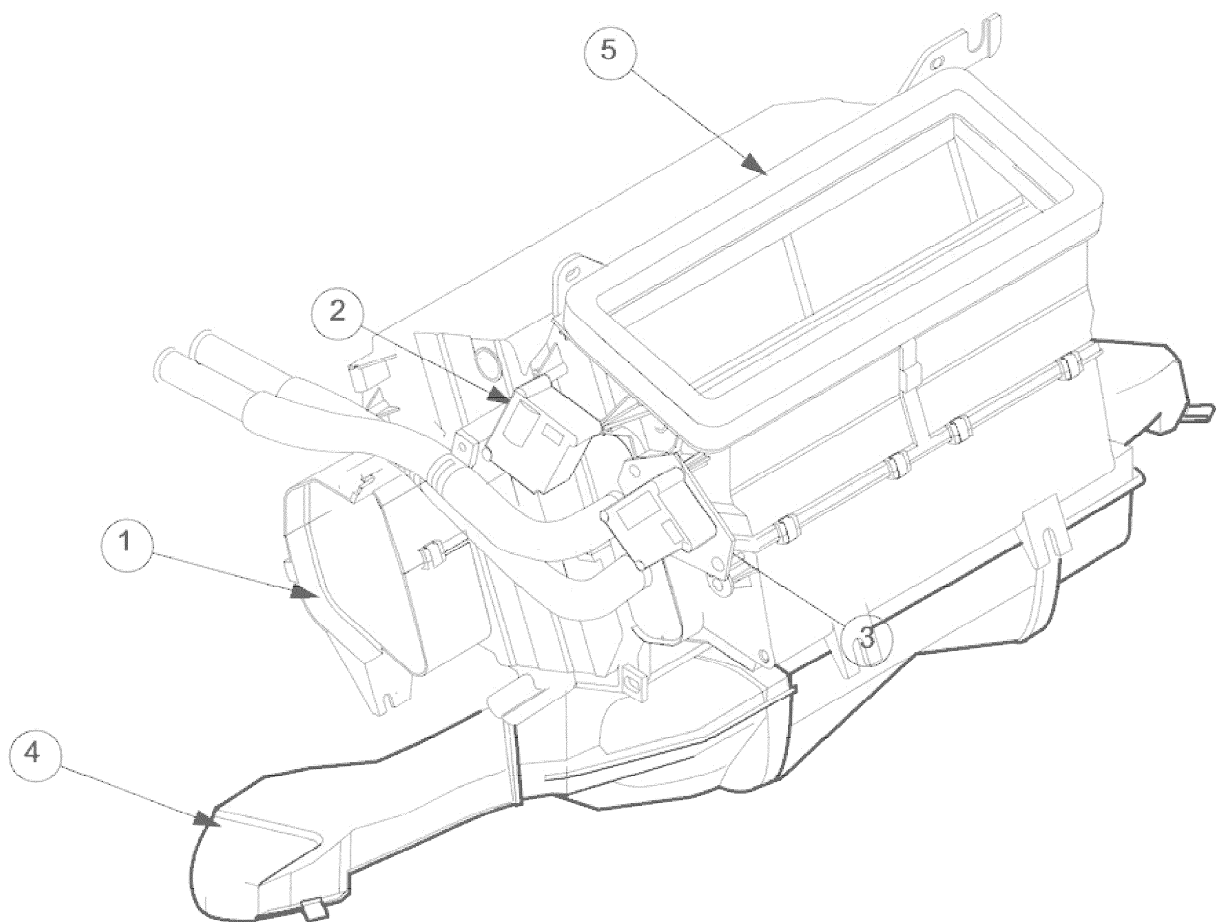

Air Distribution Box (ADB)

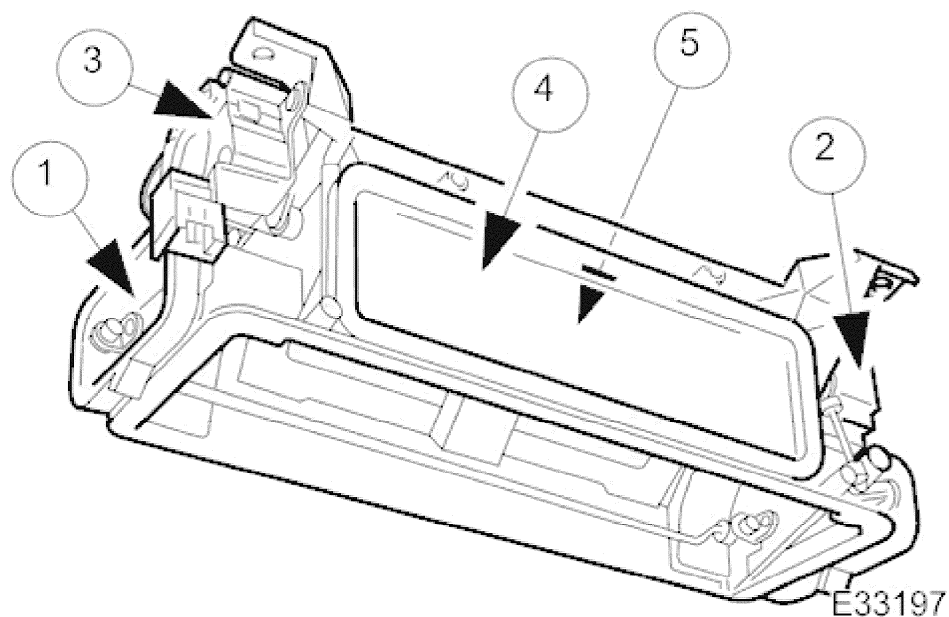

Parts List

Item	Description
1	Air outlet - EOD vent
2	Servomotor - center fascia vent
3	Servomotor - windshield
4	Air outlet - fascia center
5	Air outlet - windshield

The upper air distribution box ADB, is fixed to the defrost duct and facia assembly, and seals by contact pressure to the outlet (top) of the air conditioning unit. The ADB incorporates two servo motor operated flaps which regulate airflow to:

- Windshield and door drop glass
- Fascia center and end of dash (EOD) vents

Air is ducted from the ADB to the fascia air outlet vents. The center vent duct incorporates a baffle plate which balances the volume of airflow between the center and EOD vents.

Internal Components and Air Flow

2001 XK RANGE - Air Distribution and Filtering - 412-01

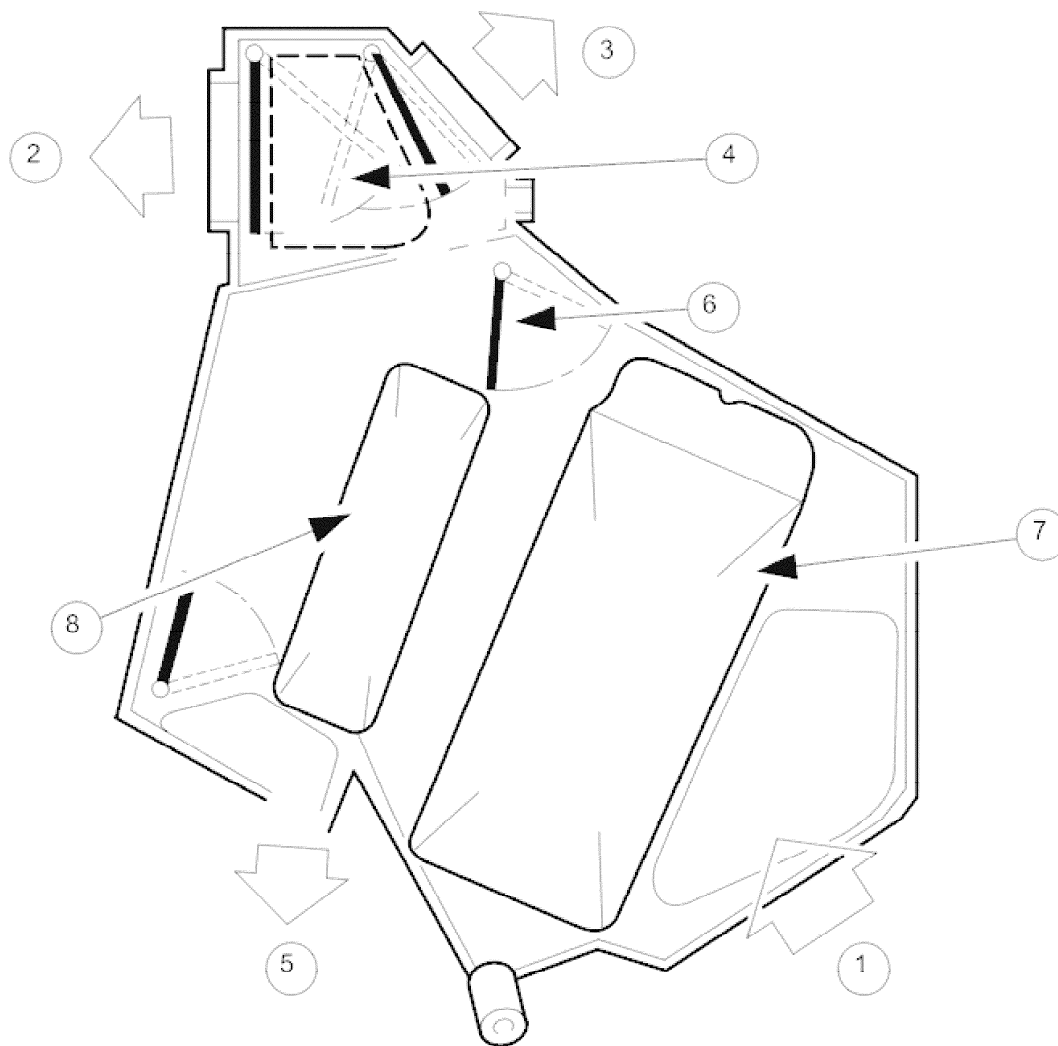

E34317

Parts List

Item	Description
1	Air inlet - from RH blower (LH opposite, not shown)
2	Air outlet - fascia center vent
3	Air outlet - defrost
4	Air outlet - EOD 1LH and 1RH
5	Air outlet - footwell
6	Flap - cool air bypass
7	Evaporator
8	Matrix - heater