

## Brake Shift Interlock Actuator 44.15.48

### Removal

1. Open the driver's door, or both doors if necessary, to allow the side glass to drop. Ensure that the doors remain open until after the battery has been disconnected.

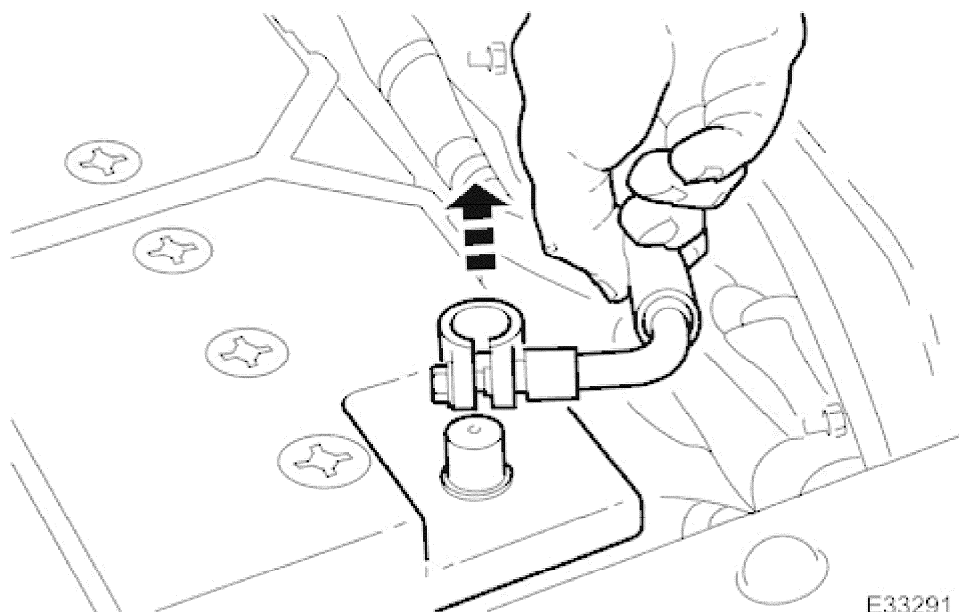

2. Disconnect battery ground cable.
  - Remove the battery cover.
3. Remove the J-gate surround, Section <<501-05>>.
4. Remove the console finisher veneer panel, Section <<501-12>>.

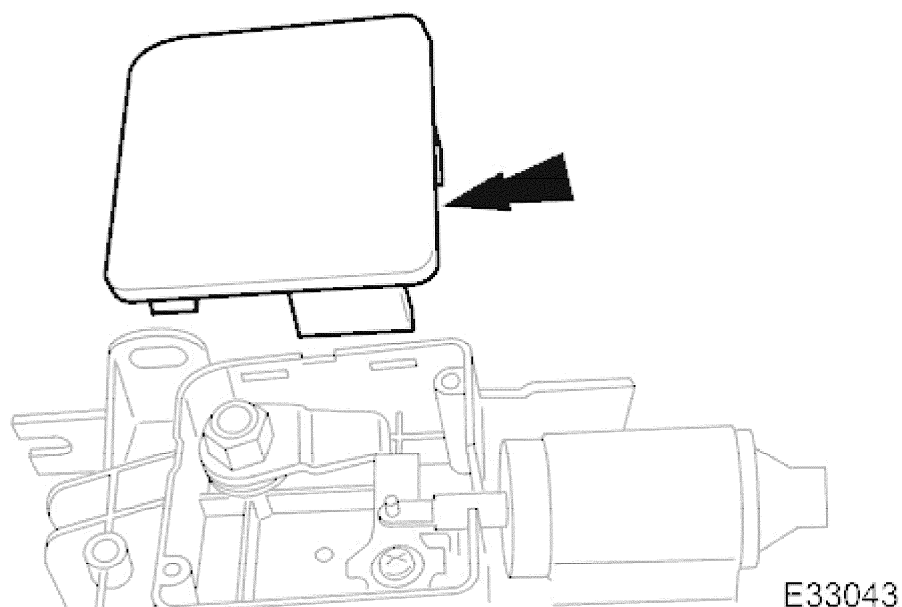

5. Remove the interlock solenoid lever cover.

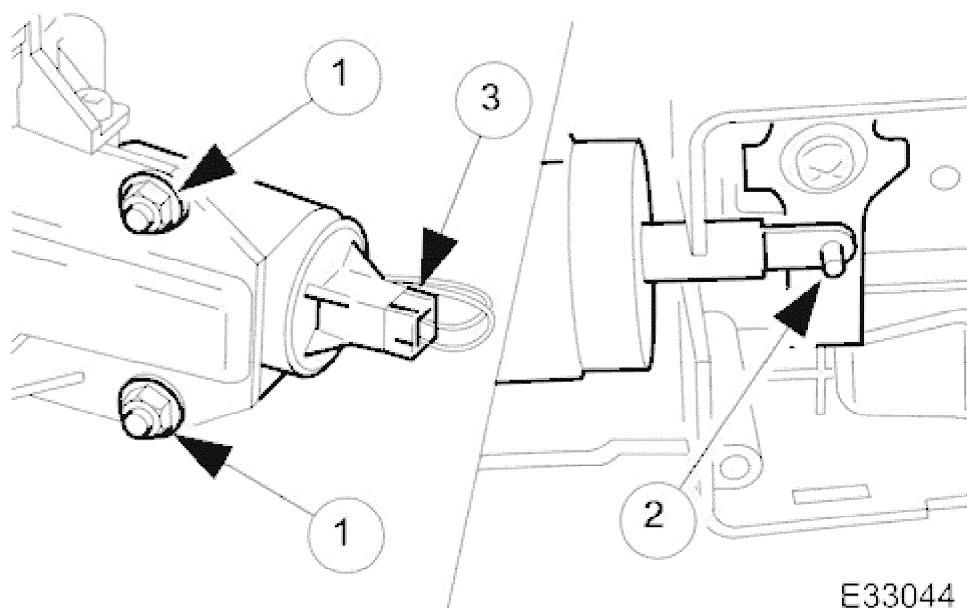

6. Remove the gearshift interlock solenoid.
1. Remove the solenoid nuts.
  2. Detach the solenoid from the latch pin.
  3. Disconnect the solenoid multiplug.

### Installation

1. Installation is the reverse of the removal procedure.

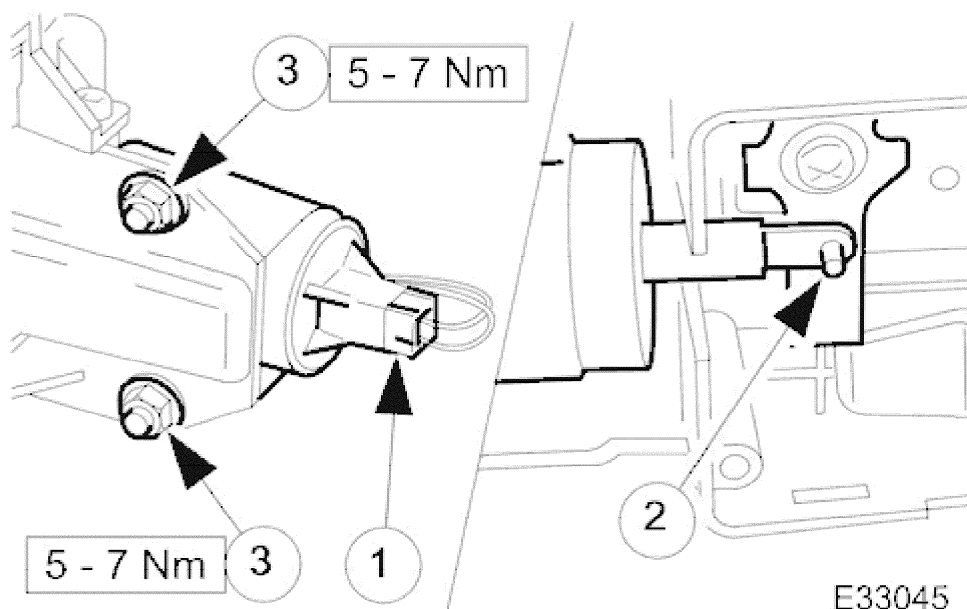

2. Fit the gearshift interlock solenoid.
1. Connect the solenoid multiplug.
  2. Locate the solenoid on the latch pin.
  3. Fit the solenoid securing nuts.

3. Perform the Battery Reconnection Procedure described in Operation <<86.15.15>>.